

TH200/C, TH200-4R (Pictured)

RWD 4 Speed

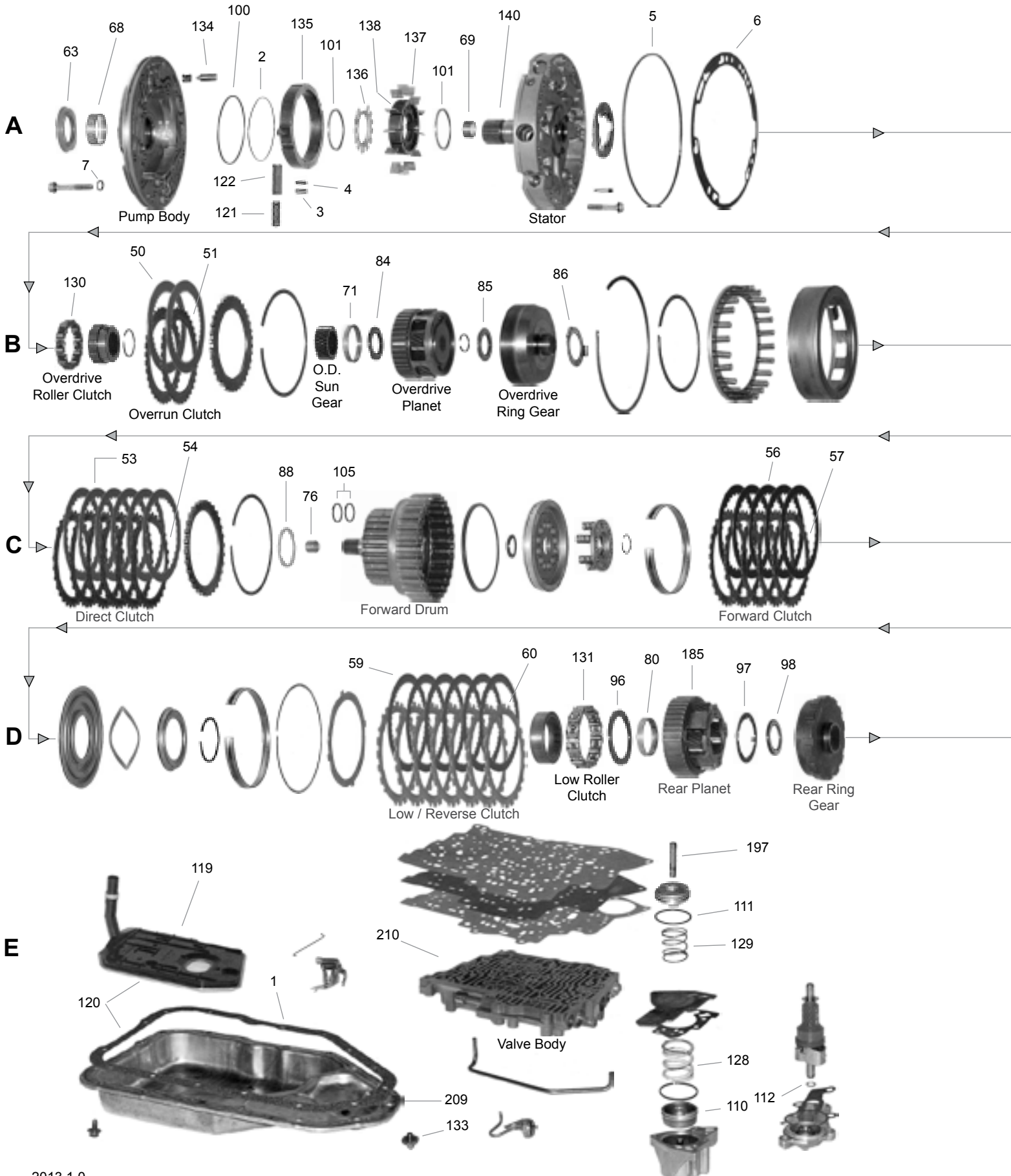

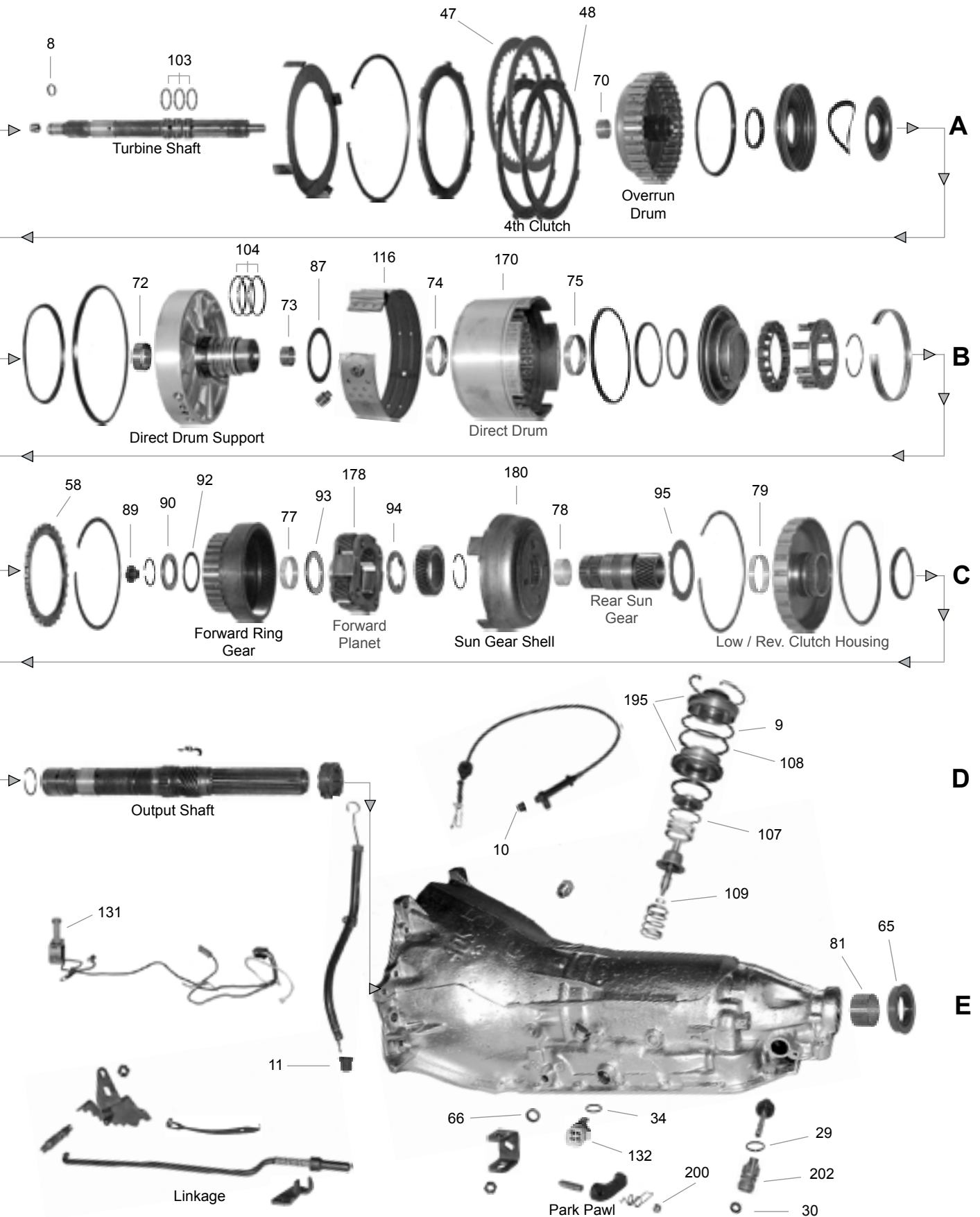

TH200/C and TH200-4R (MW9) RWD, 3 & 4 Speeds

ILL. NO.	PART NUMBER	PER CAR	DESCRIPTION	YEARS
REBUILDER BOX KITS				
---	MRK4500C-S ¹		Master Rebuilder Kit (w/o Steels)	TH200/C 1976-87
---	MRK4500R-S		Master Rebuilder Kit (w/o Steels)	TH200-4R 1981-90
---	K4500C-S		Master Kit (w/o Steels)	TH200/C 1976-87
---	K4500R-S		Master Kit (w/o Steels)	TH200-4R 1981-90
Steel Plate Sub-Kits:				
---	K4500-9		Steel Plate Kit	TH200/C 1976-87
---	K4500R-9		Steel Plate Kit	TH200-4R 1981-90
¹ For Non-Lockup Units , Please order 45600 Filter Separately.				
OVERHAUL KITS, GASKET SETS AND SEAL KITS				
---	K45900C		Overhaul Kit	TH200/C 1976-87
---	K45900R		Overhaul Kit	TH200-4R 1981-90
---	K45900C-1		Gasket and Rubber Kit (w/o Servo Lip Seals)	TH200/C 1976-87
---	K45900R-1		Gasket and Rubber Kit	TH200-4R 1981-90
---	K45900-5		Servo Lip Seal Kit (Replaces Teflon Rings)	All 1984-90
---	K45900R-2		Pump Slide Seal Kit	TH200-4R 1981-90
---	K45900-7		Front Pump Seal-Up Kit	TH200/C 1976-87
---	K45900R-7		Front Pump Seal-Up Kit	TH200-4R 1981-90
---	K45900-8		Complete External Seal-Up Kit	TH200/C 1976-87
---	K45900R-8		Complete External Seal-Up Kit	TH200-4R 1981-90
GASKET AND RUBBER COMPONENTS				
1E	45170	1	Oil Pan Gasket (TH200/C)	Duraprene 1976-87
1E	45170R	1	Oil Pan Gasket (TH200-4R)	Duraprene 1981-90
2A	45102R	1	Pump Slide Back-Up O'Ring	TH200-4R 1981-90
3A	46821	1	Pump Slide Seal	TH200-4R 1981-90
4A	46824	1	Pump Slide Seal Support	TH200-4R 1981-90
5A	45100	1	Front Pump to Case Lathe Cut Seal	TH200/C 1976-87
5A	45100R	1	Front Pump to Case Lathe Cut Seal	TH200-4R 1981-90
6A	45101	1	Front Pump to Case Gasket	TH200/C 1976-87
6A	45101R	1	Front Pump to Case Gasket	TH200-4R 1981-90
7A	3601SL	6	Front Pump Bolt Washer Seal 1976-90
8A	45145	1	Turbine Shaft O'Ring465" I.D. 1979-90
9D	45132	1	Intermediate Servo Cover O'Ring 1976-90
10D	3580L	1	Detent Cable O'Ring 1976-78
10D	45141	1	Detent Cable Seal	Lip Type 1979-90
11E	3291L	1	Filler Tube O'Ring 1976-87
11E	44141	1	Filler Tube Seal	Lip Type 1981-90
---	45120	1	Oil Filter Gasket	TH200/C 1976-87
---	3820L	1	Governor Cover O'Ring	TH200/C - Inner 1976-87
29E	3410L	1	Speedometer Housing O'Ring	11/16" O.D. 1976-90
29E	3347L	1	Speedometer Housing O'Ring	1-3/4" O.D. 1981-90
29E	51133	1	Speedometer Housing O'Ring	2-1/8" O.D. 1976-90
30E	3991L	1	Speedometer Driven Gear Lip Seal	w/o Spring 1976-90
30E	3991LX	1	Speedometer Driven Gear Lip Seal	w/Spring 1976-90
34E	3410L	1	Electrical Connector O'Ring 1979-90
---	45125	1	Center Support Plug and Seal	1 Piece 1976-90
111E	45180L	1	3-4 Accumulator Ring - 2nd Design	Lathe Cut Seal 1983-90
---	44140	1	Linkage Grommet 1976-90
---	46131	1	Solenoid O'Ring	TH200-4R 1981-90

TH200/C and TH200-4R (MW9) RWD, 3 & 4 Speeds

TH200/C / TH200-4R

ILL. NO.	PART NUMBER	PER CAR	DESCRIPTION	YEARS
CLUTCH PLATES				
47A	45308	2	4th Clutch Friction	1981-90
48A	45309	3	4th Clutch Steel	1981-90
50B	45310	2	Overrun Clutch Friction	1981-90
51B	45311	2	Overrun Clutch Steel	1981-90
53C	45304	3-6	Direct Clutch Friction	1976-90
54C	45306	3-6	Direct Clutch Steel (Flat)090"	1976-90
54C	45306X	AR	Direct Clutch Steel (Oversized)101"	1976-90
56C	45304	3-4	Forward Clutch Friction	1976-90
57C	45305	3	Forward Clutch Steel (Flat)077"	1976-90
57C	45305A	1-2	Forward Clutch Steel (Waved)063"	1976-90
57C	45306	1	Forward Clutch Steel (Oversized)090"	1976-90
58C	45315	1	Forward Clutch Pressure Plate	1976-90
59D	45321A	4-6	Low & Reverse Clutch Friction	1976-90
60D	45322	5-7	Low & Reverse Clutch Steel	1976-90
METAL CLAD SEALS				
63A	51526	1	Front Pump	1976-90
65E	45551	1	Extension Housing w/Flange	1976-90
66E	44507	1	Manual Control Shaft	1976-90
30E	3991LX	1	Speedometer Pinion (Rubber w/Spring)	1976-90
BUSHINGS				
---	K45980	1	Bushing Kit TH200/C	1976-87
---	K45980R	1	Complete Bushing Kit (* Not Included) TH200-4R	1981-90
68A	45005	1	Front Pump Body (TH200/C) 1.8795" O.D.	1976-87
68A	51005A*	1	Front Pump Body (Bronze) 1.8805" O.D.	1981-90
68A	51005B	1	Front Pump Body (Babbitt) 1.8805" O.D.	1981-90
68A	51005T*	1	Front Pump Body (Teflon) 1.8805" O.D.	1981-90
69A	45001	1	Front Pump Cover / Stator Shaft	1976-90
---	45002	1	Stator Support (TH200/C) Rear	1976-87
70A	45011R	1	Overrun Clutch Housing	1981-90
71B	46008	1	Overdrive Carrier	1981-90
72B	45013R	1	Center Support Front	1981-90
73B	45014R	1	Center Support Rear	1981-90
74B	45003	1	Direct Drum (TH200/C) Front	1976-87
74B	45003R	1	Direct Drum (TH200-4R) Front	1981-90
75B	45004	1	Direct Drum (Bronze) Rear	1976-90
76C	45012R	1	Forward Clutch Housing	1981-90
77C	45006	1	Front Internal Gear	1976-90
78C	45007	1	Rear Sun Gear	1976-90
79C	45010	1	Low & Reverse Clutch Housing	1976-90
80D	45009	1	Rear Carrier	1976-90
81E	8008*	1	Extension Housing Babbitt	1976-90
81E	45008	1	Extension Housing Bronze	1976-90
81E	45008T*	1	Extension Housing Teflon	1976-90
THRUST WASHERS AND BEARINGS				
---	K45940	1	Thrust Washer Kit (w/o Bearings and Selectives) TH200/C	1976-87
---	K45940R	1	Thrust Washer Kit (w/o Selectives) TH200-4R	1981-90
---	K45941	1	Thrust Bearing Kit TH200/C	1976-87
---	K45941R	1	Thrust Bearing Kit TH200-4R	1981-90

TH200/C and TH200-4R (MW9) - Cont'd.

ILL. NO.	PART NUMBER	PER CAR	DESCRIPTION	YEARS
THRUST WASHERS AND BEARINGS - Cont'd.				
---	46429	AR	Front, Rear and O/D Planetary Pinion Washer (Steel)	1976-90
---	K46427	1	Front Planetary Pinion Washer Kit	1976-90
---	K46427	1	Rear Planetary Pinion Washer Kit	1976-90
---	45400	1	Pump to Direct Clutch Housing Washer TH200/C	1976-87
84B	45413R	1	Overdrive Carrier to Sun Gear Needle Bearing	1981-90
85B	45413R	1	Overdrive Carrier to Internal Gear Needle Bearing	1981-90
86B	45414R	1	Internal Gear to Support Washer	1981-90
87B	45415R	1	Support to Direct Clutch Washer	1981-90
88C	45401	1	Direct to Forward Clutch Washer	1976-90
89C	45402P	AR	Forward Clutch - Selective (Front) # 15 - 3.59mm	1976-90
90C	45403A	AR	Forward Clutch - Selective (Rear) # 2 - 3.19mm	1976-90
92C	45405	1	Front Internal Gear Washer	1976-90
93C	45406	1	Front Internal Gear to Carrier Needle Bearing	1976-90
94C	K45404	1	Front Carrier to Front Sun Gear Needle Bearing	1976-90
95C	45412	1	Drum to Housing Plastic Washer	1976-90
95C	45412X	1	Drum to Housing Plastic Washer (.020" Oversized)	1976-90
96D	45409	1	Rear Carrier to Low Race Washer	1976-90
96D	45420R	1	Rear Carrier to Low Race Needle Bearing	1976-90
97D	45410	1	Rear Carrier to Internal Gear Washer	1976-90
98D	45411	1	Sun Gear to Internal Gear Needle Bearing	1976-90
SEALING RINGS				
---	K45901C	1	Sealing Ring Kit (TH200/C) Teflon	1976-87
---	K45904R	1	Sealing Ring Kit (TH200-4R) Teflon	1981-90
---	K45900-5	1	Servo Lip Seal Kit (Replaces Teflon Rings) All	1984-90
100A	45821R	1	Pump Slide to Wear Plate Metal	1981-90
101A	51822	2	Front Pump Vane (Hardened) 2.5173" O.D.	1981-90
103A	45201	2	Turbine Shaft Metal	1981-90
103A	45201T	2	Turbine Shaft (Scarf Cut) Teflon	1981-90
103A	45201ST	1	Turbine Shaft (Solid) Teflon	1981-90
105C	45201	2	Forward Clutch Shaft Metal	1976-90
105C	45201T	2	Forward Clutch Shaft Teflon	1976-90
107D	45203FT	1	Intermediate Servo (Inner - 1.967") Teflon	1976-84
107D	45203GT	1	Intermediate Servo (Inner - 2.145") Teflon	1976-84
108D	45205T	1	Intermediate Servo (Outer) Teflon	1979-84
109D	45204F	2	Intermediate Band Apply Pin Teflon	1976-90
110E	45202RT	1	1-2 Accumulator Teflon	1976-90
111E	45209RT	1	3-4 Accumulator - 1st Design Teflon	1981-82
111E	45180L	1	3-4 Accumulator - 2nd Design Lathe Cut Seal	1982-90
112E	45206T	1	Governor (TH200/C) Teflon	1976-87
112E	46203T	1	Governor (TH200-4R) Teflon	1981-90
BANDS				
116B	45714	1	Intermediate	1976-90
TRANSMISSION OIL FILTERS				
119E	45600*	1	Oil Filter TH200/C	1976-81
119E	45601*	1	Oil Filter TH200C w/Deep Pan	1979-87
119E	45606R	1	Oil Filter TH200-4R	1981-90
120E	ATK-32	1	Oil Filter Kit TH200/C	1976-81
120E	ATK-38	1	Oil Filter Kit TH200C w/Deep Pan	1979-87
120E	ATK-92	1	Oil Filter Kit TH200-4R	1981-90

TH200/C and TH200-4R (MW9) - Cont'd.

TH200/C / TH200-4R

ILL. NO.	PART NUMBER	PER CAR	DESCRIPTION	YEARS
SPRINGS				
121A	51778Y	1	Pump Slide (Inner) Yellow	1981-90
122A	51778B	1	Pump Slide (Outer) Blue	1981-90
128E	45771	1	1-2 Accumulator (TH200/C) No Color	1976-87
128E	45771F	1	1-2 Accumulator (TH200/C) Maroon	1976-87
128E	45771R	1	1-2 Accumulator (TH200-4R) Purple	1981-90
129E	51773R	1	3-4 Accumulator (TH200-4R) Red	1981-90
129E	51771P	1	3-4 Accumulator (TH200-4R) Purple	1981-90
ROLLER CLUTCHES				
130B	45815R	1	Overdrive Clutch Roller Assembly	1981-90
131D	45814	1	Low Clutch Roller Assembly	1976-90
SHIFT ENHANCEMENT KITS AND VALVES				
---	K45944	1	Valve Body Shift Kit (TH200) TransGo	1976-78
---	K45945	1	Valve Body Shift Kit (TH200C) TransGo	1979-87
---	K45944R	1	Valve Body Shift Kit (TH200-4R) TransGo	1981-90
---	ST45944R	1	Shift Correction Package (TH200-4R) Superior	1981-90
---	200-4R-HD2	1	Reprogramming Kit (TH200-4R, Includes HiPo Servo - TransGo)	1981-90
---	K45946	1	Lock-up Kit (TH200C Self-Cleaning Valves) TransGo	1979-87
---	K45946R	1	Hydraulic Lock-up Kit (TH200-4R, TransGo - Models w/Only 1 Dummy Plug)	1981-90
---	K51948	1	Non-Lockup Lube Valve Kit (TH200-4R) TransGo	1981-90
---	ST51946	1	High Gear Lock-up Delay Package (TH200-4R - Electronic - Superior)	1981-90
---	51654	1	Vacuum Switch (TH200-4R, 1-6" of Vacuum, Adjust to Control TCC Apply/ Release) ...	1981-90
---	51654A	1	Vacuum Switch (TH200-4R, 6-22" of Vacuum, Adjust to Control TCC Apply/ Release) .	1981-90
195D	K45826RHP	1	Super Servo (TH200-4R) Superior	1979-90
---	K45889	1	Pressure Regulator Valve Kit (TH200C) Sonnax	1979-87
---	K51889HD	1	T.V. Boost Valve and Bushing (TH200-4R -Heavy Duty - .472")	1981-90
---	K51889HP	1	T.V. Boost Valve and Bushing (TH200-4R - High Performance - .500")	1981-90
---	K51885	1	Accumulator Valve Train Assembly (TH200-4R, .315 - K" Version - Light Cars/Trucks)	1981-90
---	K51885HD	1	Accumulator Valve Train Assembly (TH200-4R, .330 -"L" Version - Medium Cars/Trucks)	1981-90
---	K51885HP	1	Accumulator Valve Train Assembly (TH200-4R, .341 -"M" Version - Heavy Cars/Trucks) .	1981-90
ELECTRONIC COMPONENTS				
131E	45870	1	T. C. C. Solenoid (TH200C w/Closed Loop-No Pressure Switch)	1979-87
131E	45870A	1	T. C. C. Solenoid (TH200C w/1 Int. Wire-Pin Terminal)	1979-87
131E	45870B	1	T. C. C. Solenoid (TH200C w/2 Int. Wire-Pin Terminal)	1979-87
131E	45870C	1	T. C. C. Solenoid (TH200C w/3 Int. Wire-Spade Terminal)	1979-87
131E	45870R	1	Solenoid Assembly (TH200-4R w/w/4.1 Litre, 305 & 307)	1981-90
131E	51870U	1	Lockup Solenoid (TH200-4R w/Universal Type - Rostra)	1981-90
131E	51870T	1	Lockup Solenoid (TH200-4R w/Universal Type - Teckpak)	1981-90
132E	45878	1	Case Connector 3-Prongs	1979-90
132E	51878	1	Case Connector 4-Prongs	1979-90
133E	46875	1	4th Clutch Pressure Switch 1-Prong, Normally Closed	1981-90
133E	51876	1	4th Clutch Pressure Switch 1-Prong, Normally Open	1984-90
---	45877	1	Governor Pressure Switch (TH200C) 48-50 psi.	1979-87
---	45876R	1	Oil Pressure Switch (Valve Body) 2-Prongs	1981-90

TH200/C and TH200-4R (MW9) - Cont'd.

ILL. NO.	PART NUMBER	PER CAR	DESCRIPTION	YEARS
MISCELLANEOUS AND HARD PARTS				
Note : When ordering Hard Parts, please add the appropriate suffix : (-R) Reman, (-U) Used, (-A) Aftermarket.				
---	51890	1	Front Pump Seal Retainer TH200-4R	1981-90
---	K51820	1	Front Pump Vane & Ring Kit..... 10-Vane Type	1981-90
---	K51946	1	Pump Vane & Ring Kit w/Spring (Under 6000 RPM)	1981-90
---	K51946H	1	Pump Vane & Ring Kit w/Spring (Over 6000 RPM)	1981-90
---	K51819A	1	Complete Front Pump Rotor/Slide Package .. 10-Vane Type	1981-90
134A	51824	1	Pump Slide Pivot Pin	1981-90
135A	51818	1	Front Pump Slide	1981-90
136A	45418R	1	Front Pump Rotor Guide 7-Vane Type	1981-90
136A	51418	1	Front Pump Rotor Guide 10-Vane Type	1981-90
137A	46823	7-10	Front Pump Vane	1981-90
138A	51817A	1	Front Pump Rotor 10-Vane Type	1981-90
140A	45812R	1	Stator Support Shaft TH200-4R	1981-90
170B	45803	1	Direct Drum TH200/C	1976-87
170B	45803R	1	Direct Drum TH200-4R	1981-90
178C	45833	1	Input (Front) Planetary	1976-90
180C	45810	1	Input Drum (Sun Gear Shell - Hardened)	1976-90
185D	45831	1	Rrear Planetary	1976-90
195D	K45826RHP	1	Super Servo (TH200-4R) Superior	1981-90
197E	K51742	1	1-2, 3-4, Forward Accumulator Pins (Oversized-4 Pieces - Requires Reamer)	1981-90
197E	K51742R	1	1-2, 3-4, Forward Accumulator Pins (Oversized-10 Pieces - Includes Reamer)	1981-90
---	K45970	1	Governor Cover Kit (w/Rubber O'Rings) TH200/C	1979-87
---	52931	1	Direct Clutch Check Valve w/Retainer (Non-Lockup) TH200	1976-81
---	51935	1	Direct Clutch Check Valve w/Retainer (Lockup) .. TH200C	1979-87
---	52931	1	Forward Clutch Check Valve w/Retainer TH200/C	1976-87
---	51935	1	Direct Clutch Drum Check Valve Retainer TH200-4R	1981-84
---	52931	1	Direct Clutch Drum Check Valve Retainer TH200-4R	1981-90
---	52931	1	Forward Clutch Drum Check Valve Retainer TH200-4R	1981-90
---	51933	1	3rd Accumulator Retainer (w/ Check Ball) TH200-4R	1981-90
200E	45934	1	Parking Pawl Shaft Expansion Plug All	1976-90
---	44880	1	Speedometer Gear Housing (TH200/C) Plastic Type - 34-39 Teeth	1976-87
202E	44881	1	Speedometer Gear Housing (TH200/C) Bullet Type	1976-87
202E	44140	1	Linkage Grommet	1976-90
---	44990A	1	Detent Cable Conversion Kit (TH200 to TH350)	1976-87
209E	K45884R	1	Oil Pan (Aftermarket Deep Type) TH200-4R	1981-90
210E	20-109	1	Valve Body (Reman) TH200-4R w/Converter Clutch Valve	1981-90
210E	20-109A	1	Valve Body (Reman) TH200-4R w/ECM and No Converter Clutch Valve	1981-90