

Nissan RL/RE4-F03A/V, RE4-F03B

FWD 4 Speed

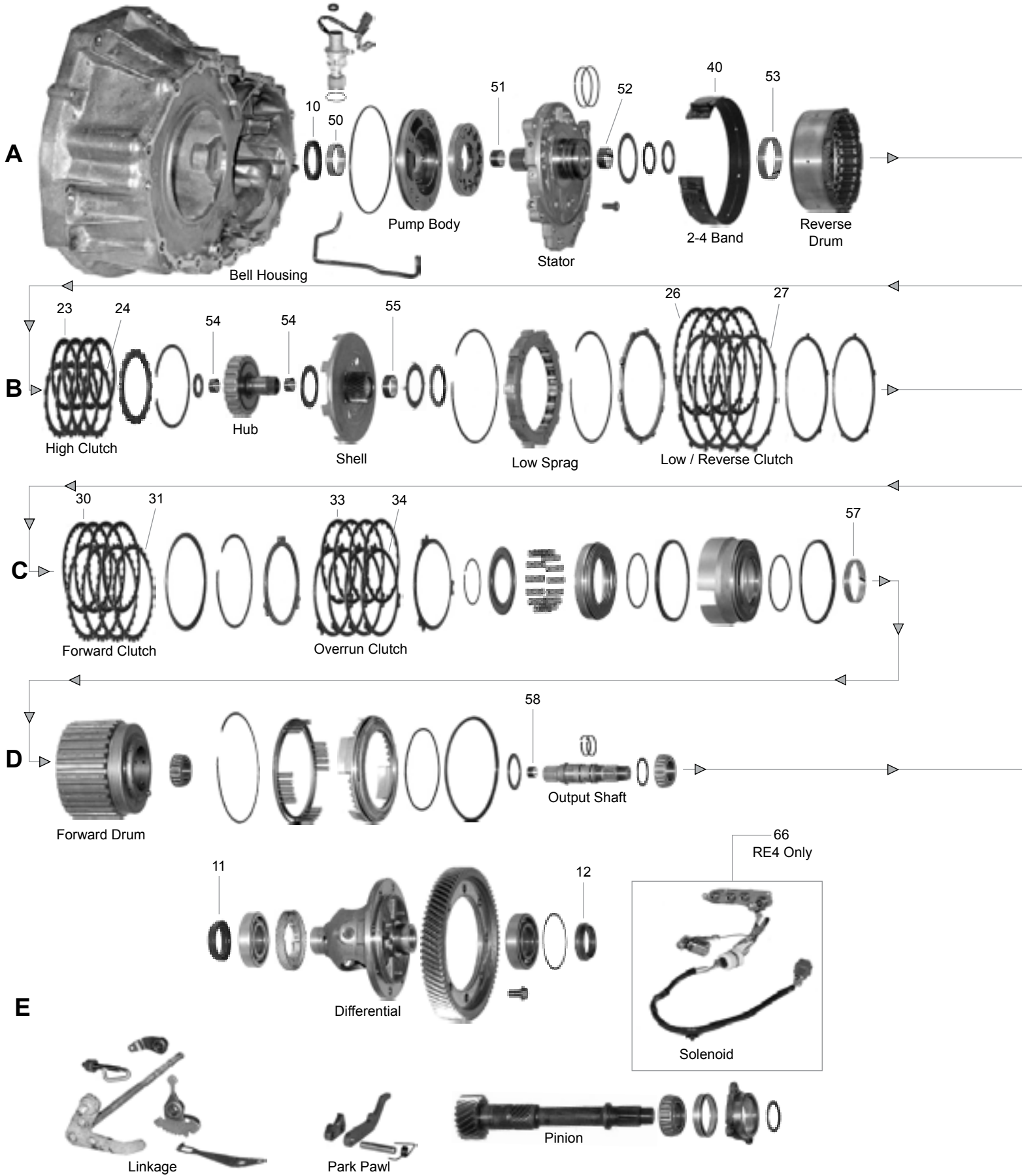

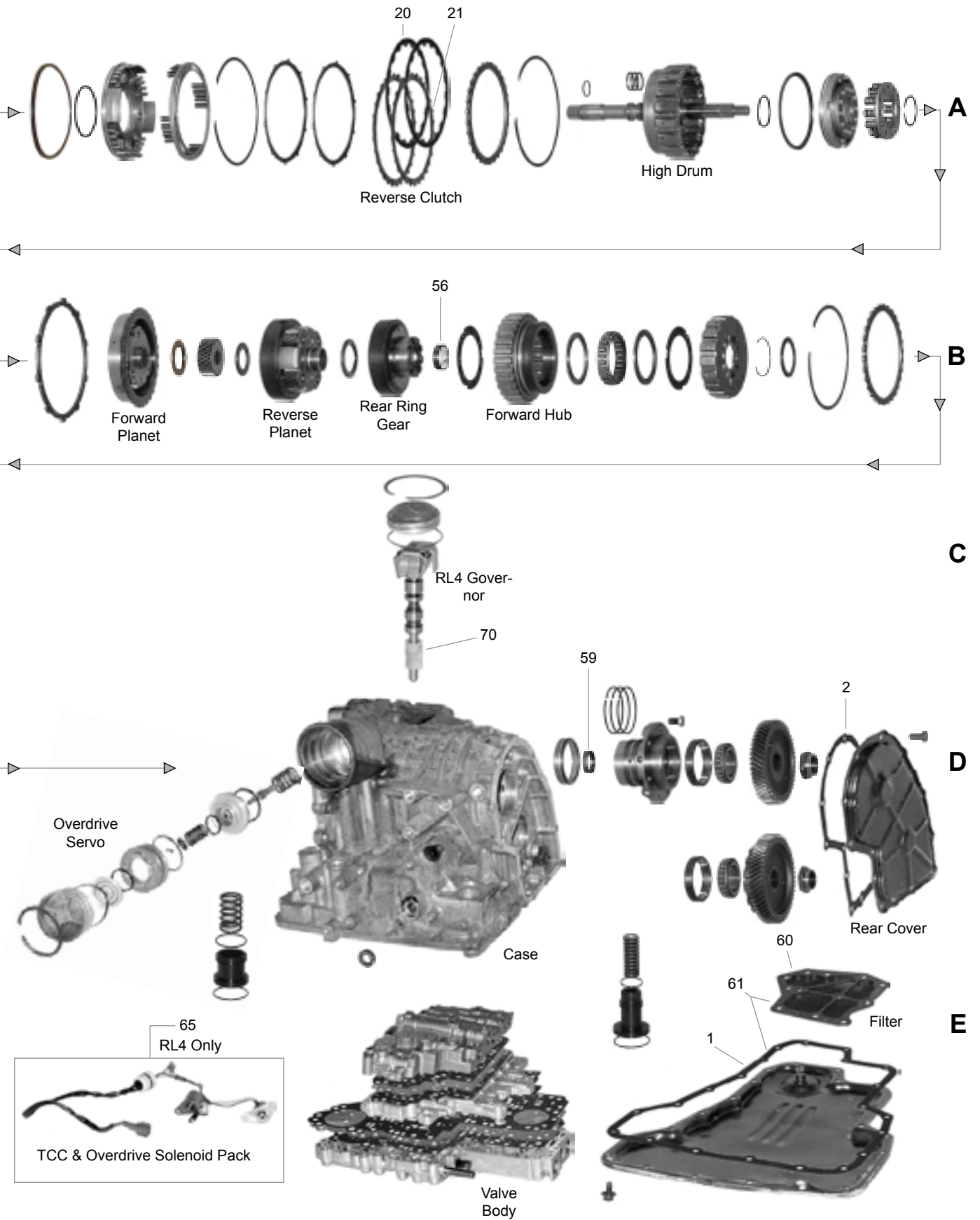

Nissan RL/RE4-F03A/V, RE4-F03B (FWD 4-Speed)

| VEHICLE MODEL | YEARS | ENGINE | TRANS. TYPE |
|-------------------------------------|------------------|-----------------------|---|
| INFINITI: | | | |
| G20 | 1991-12/92 | 2.0 Litre | RL4-F03A/V |
| | 1/93-96 | 2.0 Litre | RE4-F03A/V |
| | 1999-02 | 2.0 Litre | RE4-F03B |
| NISSAN: | | | |
| NX Coupe | 1991-93 | 1.6 Litre | RL4-F03A |
| | 1991-93 | 2.0 Litre | RL4-F03A |
| Sentra | 1991-99 | 1.6 Litre | RL4-F03A |
| | 2000-06 | 1.8 Litre | RE4-F03B |
| | 1991-92 | 2.0 Litre | RL4-F03A/V |
| | 1993-99 | 2.0 Litre | RE4-F03A/V |
| | 2000-06 | 2.0 Litre | RE4-F03B |
| 200SX | 1995-98 | 1.6 Litre | RL4-F03A/V |
| | 1995-98 | 2.0 Litre | RE4-F03A/V |
| Versa | 2007-On | 1.6 & 1.8 litre | RE4-F03A/B |
| ILL. NO. | PART NUMBER | PER CAR | DESCRIPTION YEARS |
| --- | TMRL4-F03A | | Technical Manual 1991-On |
| MASTER KITS | | | |
| --- | K8700A-S | | Master Kit (w/o Steels) All w/1.6 Litre except Below 1991-97 |
| --- | K8700B-S | | Master Kit (w/o Steels) All w/2.0 Litre except Below 1991-97 |
| --- | K8700AA-S | | Master Kit (w/o Steels) Sentra, Versa w/1.6 Litre 1996-On |
| --- | K8700BA-S | | Master Kit (w/o Steels) Sentra, Versa w/1.8 and 2.0 Litre 1996-On |
| --- | K8700AA-S | | Master Kit (w/o Steels) 200SX w/1.6 Litre 1998 |
| --- | K8700BA-S | | Master Kit (w/o Steels) 200SX w/2.0 Litre 1998 |
| --- | K8700BA-S | | Master Kit (w/o Steels) G20 w/2.0 Litre 1999-02 |
| Steel Plate Sub-Kits: | | | |
| --- | K8700A-9 | | Steel Plate Kit 1.6 & 1.8 Litre 1991-On |
| --- | K8700B-9 | | Steel Plate Kit All w/2.0 Litre exc. Below 1991-On |
| --- | K8700A-9 | | Steel Plate Kit Infiniti G20 w/RL4-F03A 1991-12/92 |
| --- | K8700A-9 | | Steel Plate Kit Infiniti G20 01/01-02 |
| --- | K8700A-9 | | Steel Plate Kit Sentra 2.0 Litre w/.079" High Steels 2000-01 |
| OVERHAUL KITS | | | |
| --- | K87900A | | Overhaul Kit All 1991-On |
| GASKET AND RUBBER COMPONENTS | | | |
| 1E | 87170A | 1 | Oil Pan Gasket (Except Versa) Duraprene 1991-On |
| 1E | 87170AV | 1 | Oil Pan Gasket (Versa) Duraprene 2007-On |
| 2D | 87176A | 1 | Rear Cover Gasket 1991-On |
| METAL CLAD SEALS | | | |
| 10A | 93526 | 1 | Converter All 1991-On |
| 11E | 68512 | 1 | Right Axle (40x56x9mm) 1.6 Litre 1991-On |
| 11E | 87551B | 1 | Right Axle (33x56x8mm) 2.0 Litre 1991-On |
| 12E | 68512 | 1 | Left Axle (40x56x9mm) 1.6 Litre 1991-On |
| 12E | 68512 | 1 | Left Axle (40x56x9mm) 2.0 Litre w/Open Differential 1991-On |
| 12E | 87552B | 1 | Left Axle (42x90x9.5mm) 2.0 Litre w/Viscous Differential 1991-On |

Nissan RL/RE4-F03A/V, RE4-F03B (FWD 4-Speed)

Nissan RE/RL4-F03A

| ILL. NO. | PART NUMBER | PER CAR | DESCRIPTION | YEARS |
|---|----------------------------|---------|---|---------|
| CLUTCH PLATES | | | | |
| 20A | 87306A | 2 | Reverse Friction 18T, .077" - 5.137" O.D. | 1991-On |
| 21A | 87307A | 2 | Reverse Steel 30T, .079" - 4.650" I.D. | 1991-On |
| 23B | 87302A | 3 | High Friction (1.6L) 20 Narrow Spline, .079" - 4.089" O.D. | 1991-On |
| 23B | 87302B | 4 | High Friction (1.8/2.0L) 20 Wide Spline, .063" - 4.089" O.D. | 1991-On |
| 24B | 87303A | 5 | High Steel 18T, .079" - 3.420" I.D. | 1991-On |
| 24B | 87303B | 6 | High Steel 18T, .059" - 3.428" I.D. | 1991-On |
| 26B | 87321A | 5 | Low/Reverse Friction 30T, .079" - 5.895" O.D. | 1991-97 |
| 26B | 87321AB | 5 | Low/Reverse Friction 30T, Different Tooth Angle, .079" - 5.440" I.D. | 1996-On |
| 27B | 87322A | 5 | Low/Reverse Steel 10T, .079" - 5.440" I.D. | 1991-On |
| 30C | 87304A | 5 | Forward Friction 30T, .071" - 4.960" O.D. | 1991-On |
| 31C | 87305A | 5 | Forward Steel 30T, .079" - 4.520" I.D. | 1991-On |
| 33C | 87308A | 3 | Overrun Friction 18T, .063" - 4.600" O.D. | 1991-On |
| 34C | 87309A | 5 | Overrun Steel 6T, .079" - 4.130" I.D. | 1991-On |
| BANDS | | | | |
| 40A | 87714A | 1 | 2-4 Band | 1991-On |
| BUSHINGS | | | | |
| --- | K87980A | 1 | Bushing Assortment Kit | 1991-On |
| 50A | 87005A | 1 | Pump Housing | 1991-On |
| 51A | 87000A | 1 | Stator Support (Front) | 1991-On |
| 52A | 87001A | 1 | Stator Support (Rear) | 1991-On |
| 53A | 87002A | 1 | Reverse Drum | 1991-On |
| 54B | 87003A | 2 | High Clutch Hub | 1991-On |
| 55B | 87006A | 1 | Sun Gear Shell | 1991-On |
| 56B | 87007A | 1 | Rear Ring Gear Hub | 1991-On |
| 57C | 87004A | 1 | Forward (Input) Drum | 1991-On |
| 58D | 75009 | 1 | Output Shaft | 1991-On |
| 59D | 87009A | 1 | Rear Ring Support | 1991-On |
| THRUST WASHERS | | | | |
| --- | K87940A | 1 | Thrust Washer Kit (Pump Selectives Only - 6 Selectives) | 1991-On |
| TRANSMISSION OIL FILTERS | | | | |
| 60E | 87600A ¹ | 1 | Oil Filter | 1991-On |
| 61E | ATK-135 | 1 | Oil Filter Kit | 1991-On |
| ¹ Please See Filter Pictures on Page 10.4-6 for Visual Identification. | | | | |
| SHIFT ENHANCEMENTS | | | | |
| --- | K87944AH | 1 | Shift Kit (TransGo) RL4-F03A (w/TV Cable) | 1991-99 |
| Addresses: 3-4 Clutch Burn-Up, No 3rd After a 3-2 or 4-2 Kickdown. 3rd Clutch Inner Seal Leaks. Provides a Firmer 4th and Lockup. Includes High-Temp Rings. | | | | |

Nissan RL/RE4-F03A/V, RE4F03B - Cont'd.

| ILL. NO. | PART NUMBER | PER CAR | DESCRIPTION | YEARS |
|-------------------------------------|--------------------|---------|---|------------|
| SHIFT ENHANCEMENTS - Cont'd. | | | | |
| --- | K87944A | 1 | Shift Kit (TransGo) RE4-F03A (w/TV Cable) Addresses: Rough 2nd Cold, No 3rd After a 3-2 or 4-2 Kickdown. 3rd Clutch Inner Seal Leaks. Corrects Hard and Soft 1-2, Long 2-3 at Heavy Throttle. Provides a Firmer 4th and Lockup. Includes High-Temp Rings. | 1993-99 |
| --- | K87944BA | 1 | Shift Kit (TransGo) RE4-F03B (w/o TV Cable) Addresses: Rough 2nd Cold, No 3rd After a 3-2 or 4-2 Kickdown. 3rd Clutch Inner Seal Leaks. Corrects Hard and Soft 1-2, Long Shifts that Hit the Rev Limiter. Provides a Firmer 4th and Lockup. Includes High-Temp Rings. | L/99-On |
| --- | RL4F03A-HD2 | | Reprogramming Kit (TransGo) RL4-F03A (w/TV Cable) | 1991-99 |
| --- | RE4F03A-HD2 | | Reprogramming Kit (TransGo) RE4-F03A (w/o TV Cable) Addresses: Rough 2nd Cold, No 3rd After a 3-2 or 4-2 Kickdown. 3rd Clutch Inner Seal Leaks. Corrects Hard and Soft 1-2, Long 2-3 at Heavy Throttle. 2-3 Cutloose and 3-2 Cutloose. Provides a Firmer 4th and Lockup. Designed for Nitrous and Turbo Charging. RE4-Kit Includes Trick Valve for Hot Rod and Street Show-Off Cars. | 1993-99 |
| --- | RE4F03B-HD2 | | Reprogramming Kit (TransGo) RE4-F03B (w/o TV Cable) Addresses: No 3rd After a 3-2 or 4-2 Kickdown. 3rd Clutch Inner Seal Leaks. Corrects Hard and Soft 1-2, Long 2-3 at Heavy Throttle. Long Shifts that Hit the Rev Limiter. Provides a Firmer 4th and Lockup. Designed for Nitrous and Turbo Charging. Includes Trick Valve for Hot Rod and Street Show-Off Cars. | L/99-On |
| --- | 87771A | 1 | 1-2 Accumulator Spring (OEM) When the accumulator spring is broken, it causes a harsh 1-2 shift. | 1991-On |
| ELECTRONIC COMPONENTS | | | | |
| 65E | 87870A | 1 | T.C.C. and O/D Solenoid Infiniti G20 w/RL4-F03A | 1991-12/92 |
| 66E | 87879A | 1 | Solenoid Assembly Infiniti G20 w/RE4-F03A | 1/93-6/99 |
| 66E | 87879B | 1 | Solenoid Assembly Infiniti G20 w/RE4-F03B | 7/99-02 |
| 65E | 87870A | 1 | T.C.C. and O/D Solenoid All Nissan w/RL4-F03A (1.6 Litre) | 1991-10/94 |
| 65E | 87870B | 1 | T.C.C. and O/D Solenoid All Nissan w/RL4-F03A (1.6 Litre) | 11/94-On |
| 66E | 87879A | 1 | Solenoid Assembly All Nissan w/RE4-F03A (2.0 Litre) | 1993-99 |
| 66E | 87879B | 1 | Solenoid Assembly All Nissan w/RE4-F03B (1.8 & 2.0 Litre) | 2000-On |
| HARD PARTS AND MISCELLANEOUS | | | | |
| 70C | 87915A | 1 | Governor Gear (RL4-F03A) | 1991-99 |
| <i>Notes:</i> | | | | |