

# Aluminum Powerglide & ST 300

RWD 2 Speed

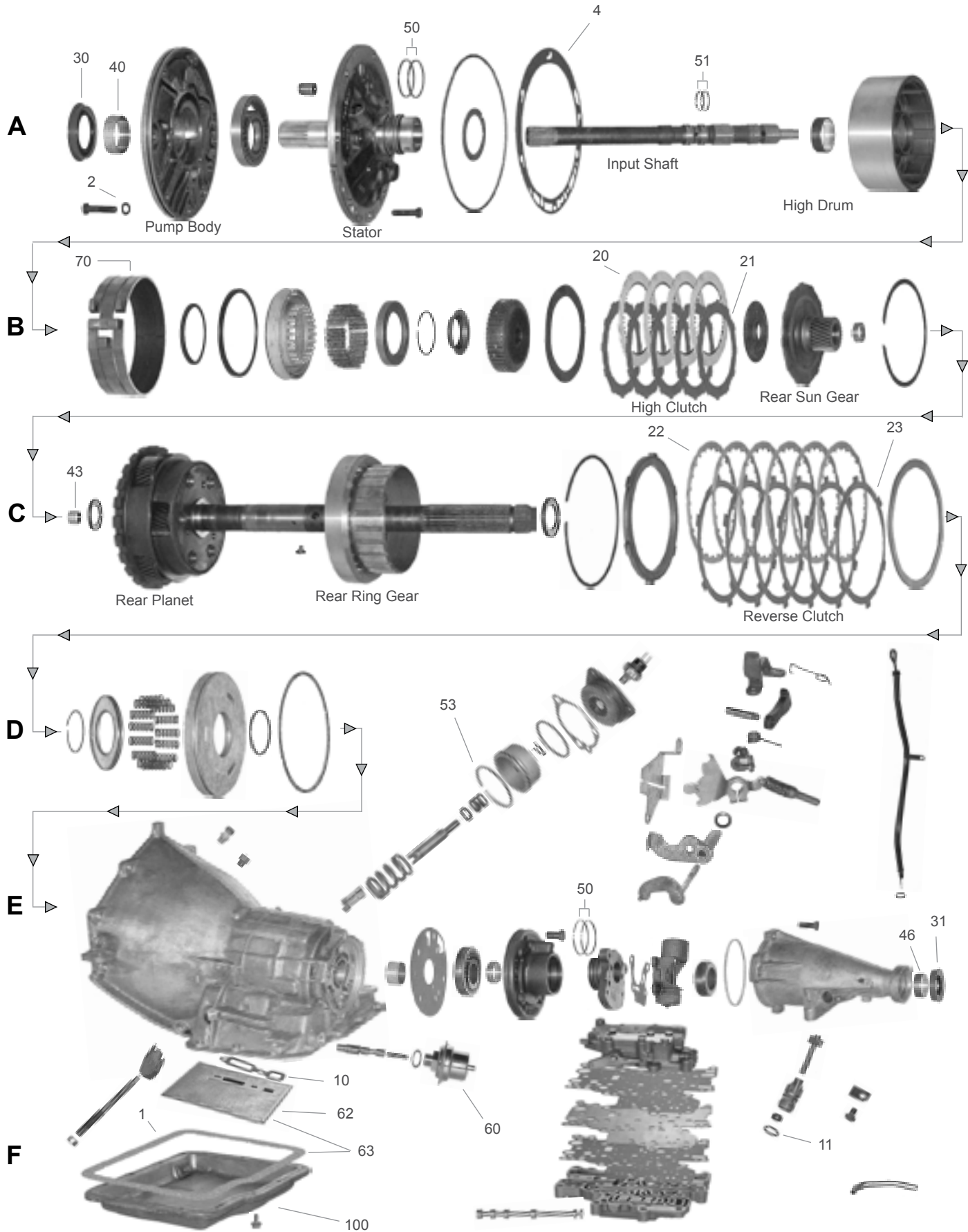

# Aluminum Powerglide

Aluminum P.G. / D.Nash

ILL. NO.	PART NUMBER	PER CAR	DESCRIPTION	YEARS
<b>REBUILDER BOX KITS</b>				
---	<b>MRK1100A-S</b>		Master Rebuilder Kit (w/o Steels) ..... <b>Exc. Torque Drive</b> .....	1962-73
---	<b>K1100A-S</b>		Master Kit (w/o Steels) ..... <b>Exc. Torque Drive</b> .....	1962-73
<b>Steel Plate Sub-Kit:</b>				
---	<b>K1100A-9</b>		Steel Plate Kit ..... <b>Exc. Torque Drive</b> .....	1962-73
<b>OVERHAUL KITS AND GASKET SETS</b>				
---	<b>K11900A</b>		Overhaul Kit ..... <b>Exc. Torque Drive</b> .....	1962-73
---	<b>K11900A-1</b>		Gasket and Rubber Kit ..... <b>Exc. Torque Drive</b> .....	1962-73
<b>GASKET AND RUBBER COMPONENTS</b>				
1F	<b>11170A</b>	1	Pan Gasket ..... <b>Duraprene</b> .....	1962-73
2A	<b>3601SL</b>	7	Front Pump Bolt Washer Seal .....	1962-73
4A	<b>3762L</b>	1	Front Pump Body Gasket.....	1962-73
10F	<b>3759L</b>	1	Oil Screen Gasket .....	1962-73
11F	<b>3410L</b>	2	Speedometer Sleeve O'Ring .....	1962-73
<b>CLUTCH PLATES</b>				
20B	<b>11304A</b>	3-4	High Clutch Friction ..... <b>Grooved</b> .....	1962-73
21B	<b>11305A</b>	4-5	High Clutch Steel ..... <b>Flat</b> .....	1962-73
22C	<b>44321A</b>	4-6	Reverse Clutch Friction .....	1962-73
23C	<b>11322A</b>	3-6	Reverse Clutch Steel ..... <b>Flat - .070"</b> .....	1962-73
<b>METAL CLAD SEALS</b>				
30A	<b>44526</b>	1	Front Pump .....	1962-73
---	<b>11507A</b>	1	Manual Control Shaft .....	1962-73
31E	<b>45551</b>	1	Extension Housing ..... <b>w/Flange</b> .....	1962-73
<b>BUSHINGS</b>				
40A	<b>8005</b>	1	Front Pump Body .....	1962-73
43C	<b>8004C</b>	1	Output Shaft Pilot ..... <b>.500" Long</b> .....	1962-73
46E	<b>8008</b>	1	Extension Housing ..... <b>Babbitt</b> .....	1962-73
46E	<b>45008</b>	1	Extension Housing ..... <b>Bronze</b> .....	1962-73
<b>SEALING RINGS</b>				
---	<b>K11901A</b>	1	Sealing Ring Kit .....	1962-73
50A/E	<b>11200A</b>	4	Clutch Drum and Governor .....	1962-73
51A	<b>11201A</b>	2	Input Shaft .....	1962-73
53D	<b>11203A</b>	1	Low Servo .....	1962-73
<b>VACUUM MODULATORS</b>				
60F	<b>11820A</b>	1	All Models ( <b>Adjustable</b> ) ..... <b>Exc. 6 Cylinder (194 CID)</b> .....	1962-73
<b>MISCELLANEOUS AND HARD PARTS</b>				
62F	<b>11600A</b>	1	Oil Filter .....	1962-73
63F	<b>ATK-21</b>	1	Oil Filter Kit .....	1962-73
70B	<b>11720AHD</b>	1	Low Band ..... <b>High Performance</b> .....	1962-73
---	<b>PG-2S</b>	1	Tow-or-Go/Competition Reprogramming Kit ..... <b>TransGo</b> .....	1963-73
---	<b>K11889HD</b>	1	Boost Valve Assembly ( <b>Large - .489" Small End</b> ) <b>Sonnax</b> .....	1962-73
100F	<b>K11884</b>	1	Oil Pan ( <b>Aftermarket Deep Type</b> ) .....	1962-73

# Super Turbine 300

ILL. NO.	PART NUMBER	PER CAR	DESCRIPTION	YEARS
<b>REBUILDER BOX KITS</b>				
---	<b>K1100B-S</b>		Master Kit (w/o Steels) .....	1964-69
			<b>Steel Plate Sub-Kit:</b>	
---	<b>K1100B-9</b>		Steel Plate Kit .....	1964-69
<b>OVERHAUL KITS AND GASKET SETS</b>				
---	<b>K11900B</b>		Overhaul Kit .....	1964-69
---	<b>K11900B-1</b>		Gasket and Rubber Kit .....	1964-69
<b>GASKET AND RUBBER COMPONENTS</b>				
1F	<b>11170B</b>	1	Pan Gasket ..... <b>Duraprene</b> .....	1964-69
---	<b>3877L</b>	1	Front Pump Body to Case Seal .....	1964-69
2A	<b>3601SL</b>	8	Front Pump Bolt Washer Seal .....	1964-69
---	<b>3896L</b>	1	Extension Housing to Case Seal .....	1964-69
---	<b>3410L</b>	2	Modulator and Connector O'Ring .....	1964-69
---	<b>3291L</b>	1	Oil Filler Tube O'Ring .....	1964-69
---	<b>3248L</b>	1	Intake Pipe to Case O'Ring .....	1964-69
---	<b>3991LX</b>	1	Speedometer Driven Gear Lip Seal ..... <b>w/Spring</b> .....	1964-69
11F	<b>3347L</b>	1	Speedometer Gear Sleeve O'Ring .....	1964-69
<b>CLUTCH PLATES</b>				
20B	<b>11304A</b>	5-6	High Clutch Friction ..... <b>Grooved</b> .....	1964-69
21B	<b>11305A</b>	6	High Clutch Steel ..... <b>Flat</b> .....	1964-69
22C	<b>44321A</b>	5-6	Reverse Clutch Friction .....	1964-69
23C	<b>11322A</b>	5-6	Reverse Clutch Steel ..... <b>Flat - .070"</b> .....	1964-69
<b>METAL CLAD SEALS</b>				
30A	<b>44526</b>	1	Front Pump .....	1964-69
---	<b>44507</b>	1	Manual Control Shaft .....	1964-69
31E	<b>45551</b>	1	Extension Housing ..... <b>w/Flange</b> .....	1964-69
<b>BUSHINGS</b>				
40A	<b>8005</b>	1	Front Pump Body .....	1964-69
43C	<b>8004C</b>	1	Output Shaft Pilot ..... <b>.500" Long</b> .....	1964-69
---	<b>34002</b>	1	Stator Support Shaft .....	1964-69
---	<b>34002</b>	1	Low Sun Gear .....	1964-69
46E	<b>8008</b>	1	Extension Housing ..... <b>exc. Olds 88 and Buick Wagon</b> .....	1964-69
46E	<b>26014</b>	1	Extension Housing ..... <b>Olds 88 and Buick Sport Wagon</b> .....	1964-69
---	<b>34921</b>	1	Governor Bore Repair Sleeve .....	1964-69
<b>MISCELLANEOUS AND HARD PARTS</b>				
60F	<b>34820R</b>	1	Vacuum Modulator ..... <b>8 Cylinder</b> .....	1964-69
60F	<b>44820X</b>	1	Vacuum Modulator ..... <b>Wide Range Adjustable</b> .....	1964-69
62F	<b>11600B</b>	1	Oil Filter .....	1964-69
63F	<b>ATK-2</b>	1	Oil Filter Kit .....	1964-69
70B	<b>11720AHD</b>	1	Low Band ..... <b>High Performance</b> .....	1964-69
---	<b>11520</b>	1	Governor Assembly ..... <b>8 Cylinder</b> .....	1964-69
---	<b>34932</b>	1	Connector Switch ..... <b>1-Prong</b> .....	1968-69

# Doug Nash (Overdrive) 4-Speed

ILL. NO.	PART NUMBER	PER CAR	DESCRIPTION	YEARS
<b>1984-88 Corvette w/4-speed Overdrive (MK2 / MK5) DNE Overdrive (Doug-Nash)</b>				
<b>MASTER BOX KITS</b>				
---	<b>K1100-S</b>		Master Kit (w/o Steels) .....	1984-88
<b>OVERHAUL KITS</b>				
---	<b>K11900</b>		Overhaul Kit .....	1984-88
<b>MISCELLANEOUS AND HARD PARTS</b>				
---	<b>301239</b>	1	Gasket .....	1984-88
---	<b>301508<sup>1</sup></b>	1	Bearing .....	1984-88
---	<b>51814</b>	1	Sprag ( <b>26 Element</b> ) .....	1984-88
---	<b>6582H</b>	1	Filter .....	1984-88
---	<b>45008</b>	1	Bushing .....	1984-88
---	<b>45551</b>	1	Seal .....	1984-88
<sup>1</sup> The OEM bearing is a one-way thrust bearing that is no longer available. This is an aftermarket bearing that can be installed in either direction.				
<i>Notes:</i>				

Aluminum P.G. / D.Nash