

# Allison 1000/2000/2400

RWD 5 Speed

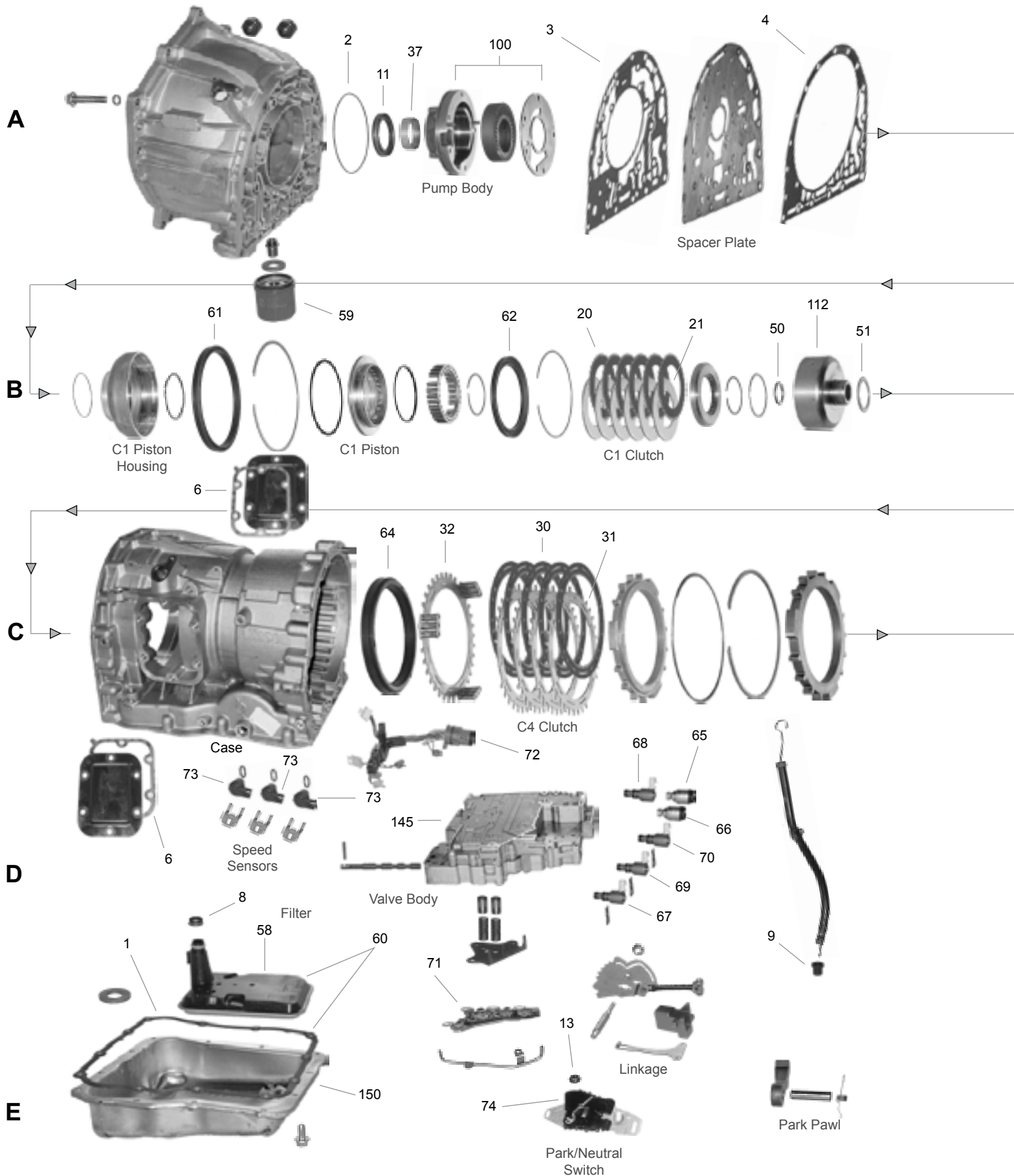

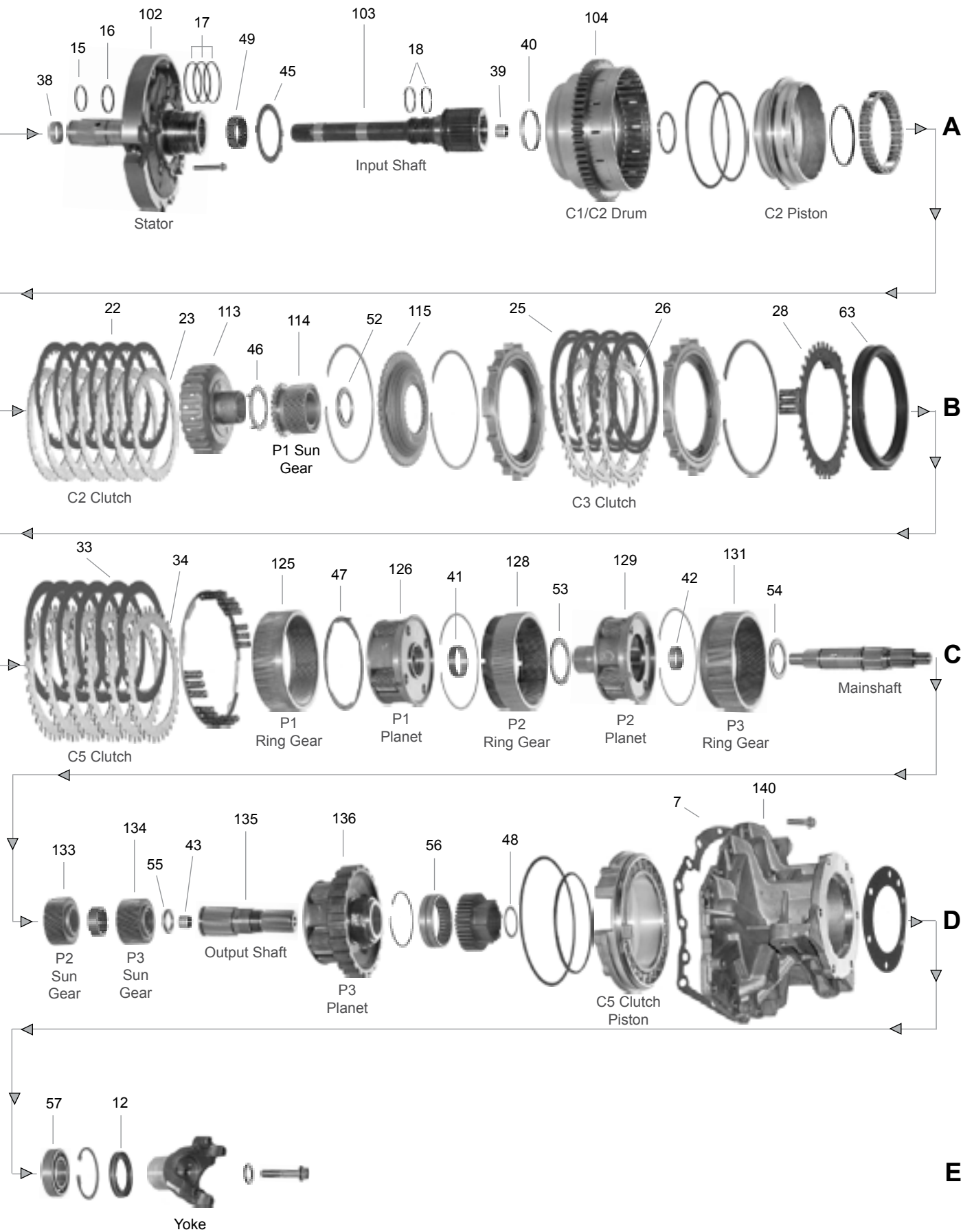

# Allison LCT1000/2000 Series (5 & 6-Spd.)

ILL. NO.	PART NUMBER	PER CAR	DESCRIPTION	YEARS
<b>MASTER BOX KITS</b>				
---	<b>K3500C-S<sup>1</sup></b>		Master Kit (w/o Steels).....	<b>5 &amp; 6-Speed</b> .....2001-10
---	<b>K3500H-S<sup>1</sup></b>		Master Kit (w/o Steels).....	<b>6-Speed</b> .....2011-On
<i>Note: Allison made several running part changes beginning in 2010 "Non-GM" units and in 2011 with "GM Units." Before ordering parts for the 2010-11 model years, please verify the unit configuration (i.e: FrictionThickness).</i>				
<b>Steel Plate Kits:</b>				
---	<b>K3500-9</b>		Steel Plate Kit.....	<b>5 &amp; 6-Speed</b> .....2001-10
---	<b>K3500H-9</b>		Steel Plate Kit.....	<b>6-Speed</b> .....2011-On
<b>OVERHAUL KITS AND GASKET SETS</b>				
---	<b>K35900C<sup>1</sup></b>		Overhaul Kit .....	<b>5 &amp; 6-Speed</b> .....2001-10
---	<b>K35900H<sup>1</sup></b>		Overhaul Kit .....	<b>6-Speed</b> .....2011-On
---	<b>K35900C-1<sup>1</sup></b>		Gasket and Rubber Kit.....	<b>5 &amp; 6-Speed</b> .....2001-10
---	<b>K35900H-1<sup>1</sup></b>		Gasket and Rubber Kit.....	<b>6-Speed</b> .....2011-On
---	<b>K35900-8</b>		External Seal-Up Kit.....	<b>All</b> .....2001-On
<sup>1</sup> Kits <b>do not</b> include the molded rubber pistons, please order separately.				
<b>GASKET AND RUBBER COMPONENTS</b>				
1E	<b>35170R</b>	1	Pan Gasket .....	<b>Molded Rubber</b> .....2001-On
2A	<b>35100</b>	1	Pump Lathe O'Ring.....	.....2001-On
3A	<b>35101</b>	1	Pump Spacer Plate to Bell Housing Gasket.....	.....2001-10
4A	<b>35101A</b>	1	Pump Spacer Plate to Case Gasket.....	.....2001-10
---	<b>35121</b>	10	Pump Bolt Seal.....	.....2001-On
6D	<b>35106</b>	1-2	PTO Cover Gasket.....	.....2001-On
7D	<b>35110</b>	1	Extension Housing Gasket.....	.....2001-On
8E	<b>35120</b>	1	Oil Filter Seal .....	.....2001-On
---	<b>51126</b>	1	Electrical Connector to Case O'Ring.....	.....2001-On
9E	<b>44141</b>	1	Filler Tube Lip Seal.....	.....2001-On
<b>METAL CLAD SEALS</b>				
11A	<b>35526</b>	1	Front Pump.....	.....2001-On
12E	<b>11551H</b>	1	Extension Housing .....	.....2001-On
13E	<b>44507</b>	1	Manual Lever.....	.....2001-On
<b>SEALING RINGS</b>				
---	<b>K35901</b>	1	Sealing Ring Kit ( <b>Late Design</b> ) .....	.....2001-On
15A	<b>35201</b>	1	Pump Stator Shaft ( <b>Small</b> ) .....	.....2001-On
16A	<b>35202</b>	1	Pump Stator Shaft ( <b>Large</b> ) .....	.....2001-On
17A	<b>35200</b>	3	Front Pump ( <b>C1/C2 Clutch</b> ) .....	.....2001-On
18A	<b>35203</b>	2	Turbine Shaft .....	.....2001-On
<b>CLUTCH PLATES</b>				
20B	<b>35304</b>	6	C1 (Forward) Friction (External Spline).....	<b>36T, .098" - 5.000" O.D.</b> .....2001-10
20B	<b>35304H</b>	7	C1 (Forward) Friction (External Spline).....	<b>36T, .073" - 5.000" O.D.</b> .....2011-On
21B	<b>35305</b>	6-7	C1 (Forward) Steel (Internal Spline) .....	<b>34T, .086" - 4.745" O.D.</b> .....2001-On
22B	<b>35306</b>	6	C2 (4-5 Clutch) Friction .....	<b>24T, .097" - 7.500" O.D.</b> .....2001-On
23B	<b>35307</b>	7	C2 (4-5 Clutch) Steel .....	<b>42T, .086" - 8.015" O.D.</b> .....2001-On
25B	<b>35302</b>	4	C3 (Reverse, 3rd &-5th Clutch) Friction w/Slots .....	<b>118T, .097" - 8.620" O.D.</b> .....2001-10
25B	<b>35302H</b>	4	C3 (Reverse, 3rd &-5th Clutch) Friction w/Slots .....	<b>118T, .073" - 8.620" O.D.</b> .....2011-On
26B	<b>35303</b>	3-4	C3 (Reverse, 3rd & 5th Clutch) Steel .....	<b>27T, .097" - 9.610" O.D.</b> .....2001-On
28B	<b>35312B</b>	1	C3 (Reverse, 3rd & 5th Clutch) <i>Apply Plate w/Springs</i> .....	<b>27 Teeth, .125" - 9.610" O.D.</b> .....2001-10

# Allison LCT1000/2000 Series (5 & 6-Spd.)

Allison LCT 1000

ILL. NO.	PART NUMBER	PER CAR	DESCRIPTION	YEARS
<b>CLUTCH PLATES - Cont'd.</b>				
30C	<b>35302</b>	5	C4 (2nd Clutch) Friction w/Slots ..... <b>118T, .097" - 8.620" O.D.</b> .....	2001-10
30C	<b>35302H</b>	6	C4 (2nd Clutch) Friction w/Slots ..... <b>118T, .073" - 8.620" O.D.</b> .....	2011-On
31C	<b>35303</b>	4-6	C4 (2nd Clutch) Steel ..... <b>27T, .097" - 9.610" O.D.</b> .....	2001-On
32C	<b>35312B</b>	1	C4 (2nd Clutch) <i>Apply Plate w/Springs</i> ..... <b>27T, .125" - 9.610" O.D.</b> .....	2001-10
33C	<b>35308</b>	6	C5 (Input Clutch) Friction ..... <b>115T, .097" - 8.570" O.D.</b> .....	2001-On
34C	<b>35309</b>	6	C5 (Input Clutch) Steel ..... <b>36T, .097" - 9.705" O.D.</b> .....	2001-On
34C	<b>35309A</b>	AR	C5 (Input Clutch) Steel ..... <b>36T, .079" - 9.705" O.D.</b> .....	2001-On
34C	<b>35309B</b>	AR	C5 (Input Clutch) Steel ..... <b>36T, .119" - 9.705" O.D.</b> .....	2001-On
<b>BUSHINGS</b>				
---	<b>K35980</b>	1	Bushing Assortment Kit ( <b>Late Design - Teflon Coated</b> ) .....	2001-On
37A	<b>35005T</b>	1	Front Pump Bushing .....	2001-On
38A	<b>35001T</b>	1	Stator Support ( <b>Front</b> ) ..... <b>1.489" O.D.</b> .....	2001-On
39A	<b>35002T</b>	1	Turbine/Input Shaft ..... <b>.945" O.D.</b> .....	2001-On
40A	<b>35003T</b>	1	C1/C2 Clutch Drum ..... <b>2.153" O.D.</b> .....	2001-On
41C	<b>35004T</b>	1	P1 Planetary..... <b>1.596" O.D.</b> .....	2001-On
42C	<b>35006T</b>	1	P2 Planetary.....	2001-On
43D	<b>35002T</b>	1	Output Shaft Planetary..... <b>.945" O.D.</b> .....	2001-On
<b>THRUST WASHERS AND BEARINGS</b>				
---	<b>K35940</b>	1	Thrust Washer Kit ( <b>w/o Selectives</b> ) .....	2001-On
---	<b>K35940A</b>	1	Selective Thrust Washer Kit .....	2001-On
---	<b>K35941</b>	1	Thrust Bearing Kit ( <b>* Not Included</b> ) .....	2001-On
45A	<b>35400</b>	1	Front Pump to C1/C2 Clutch Housing ..... <b>3 External Tabs</b> .....	2001-On
46B	<b>35401</b>	1	C2 Clutch Hub to Input Sun Gear ..... <b>4 External Tabs, Brass</b> .....	2001-On
47C	<b>35403</b>	1	P1 Ring Gear to P2 Ring Gear "PEEK" .... <b>2 Tab, Large Diameter</b> .....	2001-On
48D	<b>35402</b>	1	Reluctor Wheel to Yoke Selective Shim ..... <b>No Holes, .010"</b> .....	2001-On
48D	<b>35402A</b>	1	Reluctor Wheel to Yoke Selective Shim ..... <b>1 Hole, .020"</b> .....	2001-On
48D	<b>35402B</b>	1	Reluctor Wheel to Yoke Selective Shim ..... <b>2 Holes, .028"</b> .....	2001-On
48D	<b>35402C</b>	1	Reluctor Wheel to Yoke Selective Shim ..... <b>3 Holes, .037"</b> .....	2001-On
48D	<b>35402D</b>	1	Reluctor Wheel to Yoke Selective Shim ..... <b>4 Holes, .046"</b> .....	2001-On
48D	<b>35402E</b>	1	Reluctor Wheel to Yoke Selective Shim ..... <b>5 Holes, .055"</b> .....	2001-On
48D	<b>35402F</b>	1	Reluctor Wheel to Yoke Selective Shim ..... <b>6 Holes, .065"</b> .....	2001-On
<b>Bearings:</b>				
49A	<b>35430*</b>	1	Stator Support (Caged).....	2001-On
50B	<b>32420</b>	1	Turbine/Input Shaft to C1 Clutch Hub .....	2001-On
51B	<b>49420</b>	1	C1 Clutch Hub to C2 Clutch Hub .....	2001-On
52B	<b>51423</b>	1	Input P1Sun Gear to P1 Planetary Carrier .....	2001-On
53C	<b>37422H</b>	1	P1 Planetary to P2 Planetary .....	2001-On
54C	<b>51423</b>	1	P2 Planetary to P2 Sun Gear ..... <b>.124" - .2047" I.D.</b> .....	2001-On
54C	<b>35423E*</b>	1	P2 Planetary to P2 Sun Gear ..... <b>.142" - 1.892" I.D.</b> .....	L/06-On
55D	<b>32420</b>	1	P3 Sun Gear to P3 Planetary .....	2001-On
55D	<b>47423</b>	1	P3 Sun Gear to P3 Planetary ..... <b>2.120" O.D.</b> .....	2003-On
56D	<b>35431*</b>	1	Extension Housing to P3 Planetary (Caged).....	2001-On
57E	<b>35432*</b>	1	Extension Housing to Yoke (Ball).....	2001-On
<b>TRANSMISSION OIL FILTERS</b>				
58E	<b>35600</b>	1	Oil Filter ( <i>will fit all years</i> ) ..... <b>Shallow Pan (Black)</b> .....	2001-On
58E	<b>35600E</b>	1	Oil Filter ( <i>2nd Design Style</i> ) ..... <b>Shallow Pan (Black)</b> .....	L/06-On
58E	<b>35601</b>	1	Oil Filter ( <i>will fit all years</i> ) ..... <b>Deep Pan (White)</b> .....	2001-On
58E	<b>35601G</b>	1	Oil Filter ( <i>2nd Design Style, will retro to '01</i> ) .. <b>Deep Pan (White)</b> .....	2010-On
59B	<b>35609</b>	1	Oil Filter..... <b>External Spin-On</b> .....	2001-On
60E	<b>ATK-236</b>	1	Oil Filter Kit ..... <b>Shallow Pan</b> .....	2001-On
60E	<b>ATK-237</b>	1	Oil Filter Kit ..... <b>Deep Pan</b> .....	2001-On

# Allison LCT1000/2000 Series - Cont'd.

ILL. NO.	PART NUMBER	PER CAR	DESCRIPTION	YEARS
<b>MOLDED RUBBER PISTONS</b>				
---	<b>K35900-4</b>	1	Molded Rubber Piston Kit ..... <b>5-Speed</b> .....	2001-05
---	<b>K35900D-4</b>	1	Molded Rubber Piston Kit ..... <b>6-Speed</b> .....	L/05-10
---	<b>K35900H-4</b>	1	Molded Rubber Piston Kit ..... <b>6-Speed</b> .....	2011-On
61B	<b>35844</b>	1	C2 (4th & 5th) Clutch Balance Piston ..... <b>Molded Rubber</b> .....	2001-05
62B	<b>35841</b>	1	C1 (Forward) Clutch Balance Piston ..... <b>Molded Rubber</b> .....	2001-05
62B	<b>35841D</b>	1	C1 (Forward) Clutch Balance Piston (6-Spd.) ..... <b>Molded Rubber</b> .....	L/05-On
63B	<b>35842</b>	1	C3 (Reverse, 3rd & 5th) Clutch Apply Piston ..... <b>Molded Rubber</b> .....	2001-10
63B	<b>35842H</b>	1	C3 (Reverse, 3rd & 5th) Clutch Apply Piston ..... <b>Molded Rubber</b> .....	2011-On
64C	<b>35842</b>	1	C4 (2nd) Clutch Apply Piston ..... <b>Molded Rubber</b> .....	2001-10
64C	<b>35842H</b>	1	C4 (2nd) Clutch Apply Piston ..... <b>Molded Rubber</b> .....	2011-On
<b>SHIFT ENHANCEMENT KITS</b>				
---	<b>ALLISONSK</b>	1	Shift Kit ( <b>TransGo</b> ) ..... <b>5-Speed</b> .....	2001-05
			<b>Addresses:</b> Neutral Under High Load, Excessive Slippage, No movement, Stays in One Gear, Delayed Engagements and Trouble Codes. This Kit was Designed to Handle Vehicles with Up to 600 horsepower and Well Over 900 ft.lbs of Torque.	
---	<b>K35943D</b>	1	Jr. Shift Kit ( <b>TransGo</b> ) ..... <b>5 &amp; 6-Speed</b> .....	2001-10
			<b>Addresses:</b> Installs with unit in the vehicle and Increases Torque Capacity.	
---	<b>K35885</b>	1	<b>Steel C, D &amp; E Shift Valves (TransGo) ..... 5 &amp; 6-Speed.....</b>	<b>2001-10</b>
			<b>Addresses: "Sticky" valves that cause pressure switch and solenoid performance codes. Should be sold in conjunction with ALLISONSK and K35943D every time.</b>	
---	<b>K35944HD</b>	1	<b>High Performance Valve Body Kit (RatioTek) 400-800HP Vehicles .....</b>	<b>2011-15</b>
---	<b>K35944HP</b>	1	<b>High Performance Valve Body Kit (RatioTek) 800-120HP Vehicles .....</b>	<b>2011-15</b>
---	<b>K35887</b>	1	Lock-Up Boost Valve Kit ( <b>TransGo</b> ) ..... <b>Modified Trucks Only</b> .....	2001-03
---	<b>K35887D</b>	1	Lock-Up Boost Valve Kit ( <b>TransGo</b> ) ..... <b>Modified Trucks Only</b> .....	2004-07
---	<b>35880W</b>	1	F-Trim Valve End Sleeve ( <b>Sonnax</b> ) .....	2001-10
			<b>Addresses:</b> Converter Slip Code PO741, Elevated Operating Temperatures & TCC Surge.	
---	<b>35881W</b>	1	C1 Clutch Control Valve and Sleeve Kit ( <b>Sonnax, In Pump Stator</b> ) .....	2001-2/04
			<b>Addresses:</b> Harsh or Delayed Bump on Forward Engagement. Doesn't Fit #29541135 or Later Pump Stators.	
---	<b>35882W</b>	1	E-Shift Valve Spring ( <b>Sonnax, Use w/K35582W Bore Sizing Tool</b> ) .....	2001-10
			<b>Addresses:</b> Code 872, 3rd Gear Starts, Pressure Switch Stuck On & E-Shift Valve Sticking.	
---	<b>K35765W</b>	1	Lube Regulator and Converter Relief Valve Springs ( <b>Sonnax</b> ) .....	2001-03
			<b>Addresses:</b> OEM Spring Breakage, Elevated Operating Temperatures & Delayed Engagements. Doesn't Fit 2004-On with 7-Solenoids.	
<b>ELECTRONIC COMPONENTS</b>				
65D	<b>35879</b>	1	Trim "A" Solenoid ( <b>Normally Closed, Green O'Ring, .645" Snout, 5.5-8.0 Ohms</b> ) .....	2001-05
65D	<b>35879D</b>	1	PCS "1" Solenoid ( <b>Black Conn.</b> ) ..... <b>6-Speed</b> .....	L/05-On
66D	<b>35879A</b>	1	Trim "B" Solenoid ( <b>Normally Open, Black O'Ring, .665" Snout, 5.5-8.0 Ohms</b> ) .....	2001-05
66D	<b>35879DA</b>	1	PCS "2" Solenoid ( <b>Natural Conn.</b> ) ..... <b>6-Speed</b> .....	L/05-On
---	<b>51873A</b>	1	"G" Pressure Control Solenoid .....	L/03-10
---	<b>35879D</b>	1	Pressure Control/Main Mod. Solenoid ( <b>Black Conn.</b> ) .....	2011-On
67D	<b>41870A</b>	1	"F" TCC PWM Solenoid ..... <b>8-15 Ohms</b> .....	2001-05
67D	<b>35870D</b>	1	"F" TCC PCS Variable Bleed Solenoid ( <b>Red Conn.</b> ) <b>6-Speed</b> .....	L/05-On
68D	<b>51873A</b>	1	"C" Shift Solenoid ( <b>SS1</b> ) ..... <b>20-30 Ohms</b> .....	2001-On
69D	<b>51873A</b>	1	"D" Shift Solenoid ( <b>SS2</b> ) ..... <b>20-30 Ohms</b> .....	2001-On
70D	<b>51873A</b>	1	"E" Shift Solenoid ( <b>SS3</b> ) ..... <b>20-30 Ohms</b> .....	2001-On
71E	<b>42877</b>	1	Pressure Switch Assembly & Temp. Sensor (Universal, not all 6 switches used) .....	2001-On
71E	<b>35877</b>	1	Pressure Switch Assembly & Temp. Sensor (Allison OEM 4 switches) .....	2001-On
72D	<b>35869</b>	1	Internal Wiring Harness ( <i>6-Solenoid Units</i> ) .....	2001-03

# Allison LCT1000/2000 Series - Cont'd.

Allison LCT 1000

ILL. NO.	PART NUMBER	PER CAR	DESCRIPTION	YEARS
<b>ELECTRONIC COMPONENTS - Cont'd.</b>				
72D	<b>35869C</b>	1	Internal Wiring Harness (7-Solenoid Units) ..Units w/"G" Solenoid .....	L/03-05
72D	<b>35869D</b>	1	Internal Wiring Harness (w/Internal Mode Switch) 6-Speed (LCT1000 GM Gen4) .....	L/05-10
72D	<b>35869DA</b>	1	Internal Wiring Harness (w/Internal Mode Switch) 6-Speed (LCT2000/2400 Exc.GM) .....	L/05-10
72D	<b>35869H</b>	1	Internal Wiring Harness (w/Internal Mode Switch) (LCT1000 GM Units) .....	2011-On
<b>72D</b>	<b>35869HA</b>	<b>1</b>	<b>Internal Wiring Harness (w/Internal Mode Switch) (LCT1000 Non-GM Units) .....</b>	<b>2010-On</b>
---	<b>41859VC</b>	1	External Repair Harness (Universal Style) .....	2001-05
73D	<b>35875</b>	1	Engine Speed Sensor (Some Models).....On Bell Housing .....	2001-On
73D	<b>35875</b>	1	Input Speed Sensor (All Models)..... On Case, Above PTO Cover .....	2001-On
73D	<b>35875</b>	1	Output Speed Sensor (2WD Models)..... On Extension Housing .....	2001-On
74E	<b>51877GT</b>	1	Park/Neutral (P/N) Position Switch (External Two Connector) .....	2001-03
74E	<b>51877MT</b>	1	Park/Neutral (P/N) Position Switch (External Single Connector) .....	2004-05
74E	<b>35877DA</b>	1	Internal Mode Switch (Replaces External P/N Switch - 6-Speed) .....	L/05-On
---	<b>K51857GVC</b>	1	P/N Switch 7-Way and 4-Way Repair End Kit (Vehicle Harness Side) .....	2001-03
---	<b>51857MVC</b>	<b>1</b>	<b>P/N Switch Repair End Kit .....</b> (Vehicle Harness Side) .....	<b>2004-05</b>
<b>HARD PARTS</b>				
Note : When ordering Hard Parts, please add the appropriate suffix : (-R) Reman, (-U) Used, (-A) Aftermarket.				
100A	<b>K35895B</b>	1	Pump Body & Gears Kit (Updated) .....	2001-On
102A	<b>35812</b>	1	Stator Assembly (Casting # 2953, 1st Design) .....	2001-10
102A	<b>35812B</b>	1	Stator Assembly (Casting # 2954, 2nd Design) .....	2001-10
103A	<b>35851</b>	1	Input Shaft (1st Design - 1.716" O.D. Bearing Ill.# 50) .....	2001-10
103A	<b>35851B</b>	1	Input Shaft (2nd Design - 2.120" O.D. Bearing Ill.# 50) .....	2001-10
104A	<b>35801</b>	1	C1/C2 Clutch Drum (w/o PTO) .....	2001-10
104A	<b>35801A</b>	1	C1/C2 Clutch Drum (w/PTO) .....	2001-10
112B	<b>35839</b>	1	C1 Clutch Hub (w/Bearing Shoulder) .....	2001-10
112B	<b>35839A</b>	1	C1 Clutch Hub (w/o Bearing Shoulder) .....	2001-10
113B	<b>35867</b>	1	C2 Clutch Hub .....2.220" O.D. Shaft .....	2001-10
113B	<b>35867A</b>	1	C2 Clutch Hub .....2.260" O.D. Shaft .....	2001-10
---	<b>K35835<sup>2</sup></b>	1	Geartrain .....w/49-Tooth P3 Sun Gear .....	2001-05
---	<b>K35835A<sup>2</sup></b>	1	Geartrain .....w/41-Tooth P3 Sun Gear .....	2001-05
---	<b>K35835D<sup>2</sup></b>	1	Geartrain .....w/49-Tooth P3 Sun Gear .....	2006-10
<sup>2</sup> Includes: 114B, 115B, 125C-134D and 136D.				
135D	<b>35852</b>	1	Output Shaft (2WD) .....	2001-10
135D	<b>35852A</b>	1	Output Shaft (4WD) .....	2001-10
140D	<b>35897</b>	1	Extension Housing (2WD) .....	2001-10
140D	<b>35897A</b>	1	Extension Housing (4WD) .....	2001-10
145D	<b>20-140A</b>	1	Valve Body (Reman) ..... 5-Speed, 6 Solenoids .....	2001-04
145D	<b>20-140B</b>	1	Valve Body (Reman) ..... 5-Speed, 7 Solenoids - Main Modulated Pressure V.B. ....	2004-05
145D	<b>20-140C</b>	1	Valve Body (Reman) ..... 6-Speed, 7 Solenoids - Main Modulated Pressure V.B. ....	L/05-10
150E	<b>35884</b>	1	Deep Oil Pan (OEM, Holds 3 Quarts More Than Shallow Pans) .....	2001-On
150E	<b>35884HD</b>	1	Deep Oil Pan (Aluminum Heavy Duty, Holds 3+ Quarts More Than Shallow Pan) ..	2001-On
<b>MISCELLANEOUS</b>				
---	<b>35954B</b>	<b>2</b>	<b>Steel Cooler Line Fitting (5/8" Line) .....</b>	<b>2003-On</b>
---	<b>T-1000</b>	1	Output Shaft Nut Spanner Socket (Adapt-A-Case) .....	2001-On