

F4A41 / 42 / 51 / A / B / F5A51/A

FWD 4 & 5 Speed

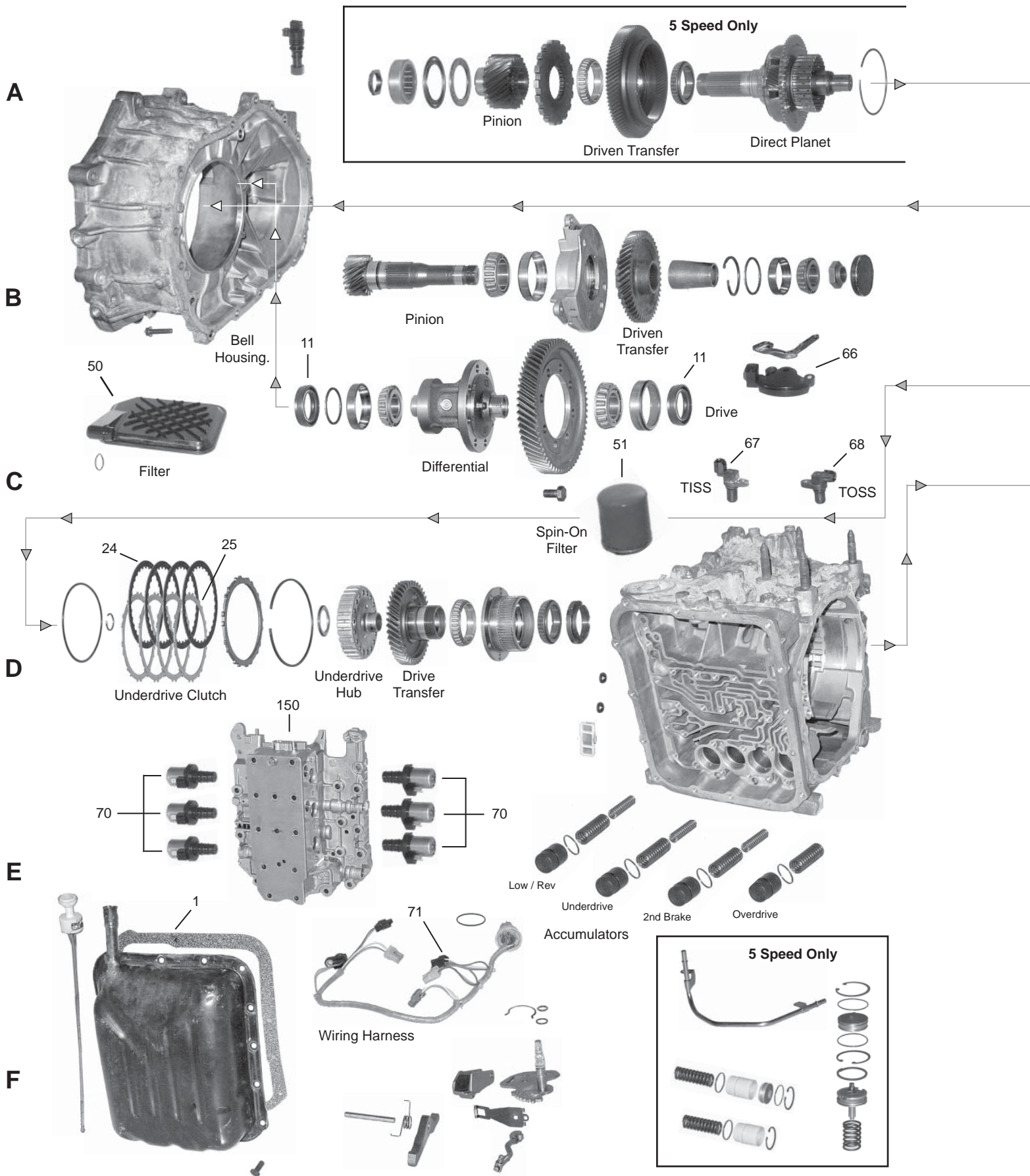

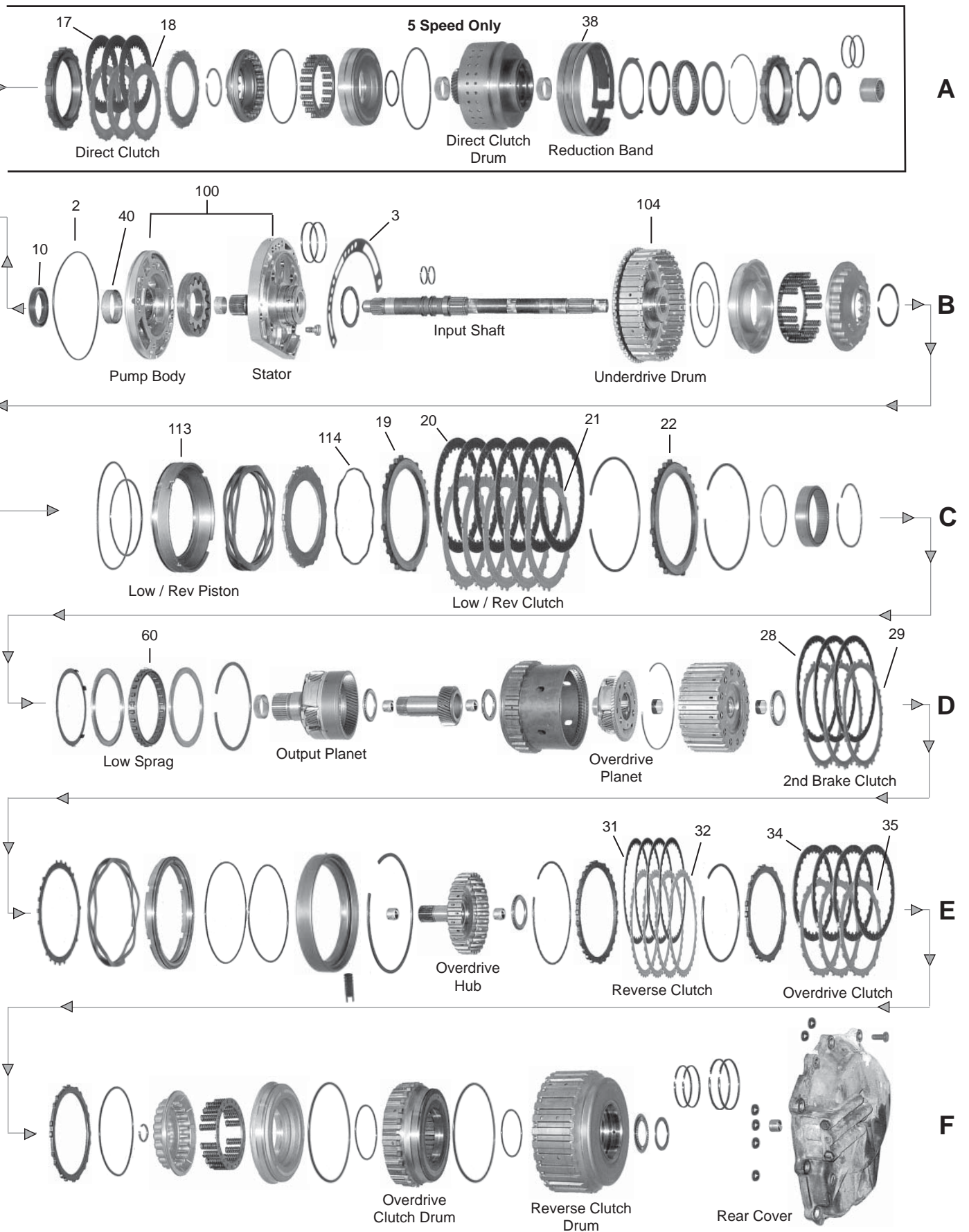

Mitsubishi F4A41/2-1/A/B, 51/5A (FWD 4 & 5-Spd)

ILL. NO.	PART NUMBER	PER CAR	DESCRIPTION	YEARS
<p>Unit Identification: <u>Front Wheel Drive 4-Speed.</u> Externally, these units can be identified by their spin-on oil filter (1997-99), side-mounted valve body and side cover, two-piece case and no bottom pan.</p>				
TECHNICAL MANUALS				
---	TMF4A51		Technical Manual	1997-On
---	TMF5A51		Technical Manual	1997-On
REBUILDER BOX KITS				
---	K9400-S		Master Kit (w/o Steels) F4A41/F4A4A (4-Speed - 4 Cyl.)	1997-On
---	K9400B-S		Master Kit (w/o Steels) F4A42/F4A4B (4-Speed - 4 Cyl.)	1997-On
---	K9400A-S		Master Kit (w/o Steels) F4A51/F4A5A (4-Speed - V6)	1997-On
---	K9400F-S		Master Kit (w/o Steels) F5A51/F5A5A (5-Speed - V6)	2001-On
Steel Plate Sub-Kits:				
---	K9400-9		Steel Plate Kit F4A41/F4A4A (4-Speed - 4 Cyl.)	1997-On
---	K9400B-9		Steel Plate Kit F4A42/F4A4B (4-Speed - 4 Cyl.)	1997-On
---	K9400A-9		Steel Plate Kit F4A51/F4A5A (4-Speed - V6)	1997-On
---	K9400F-9		Steel Plate Kit F5A51/F5A5A (5-Speed - V6)	2001-On
OVERHAUL KITS AND GASKET SETS, AND SEAL KITS				
---	K94900		Overhaul Kit F4A41/2, F4A4A/B(4-Speed - 4 Cyl.)	1997-On
---	K94900A		Overhaul Kit F4A51/F4A5A (4-Speed - V6)	1997-On
---	K94900F		Overhaul Kit F5A51/F5A5A (5-Speed - V6)	2001-On
GASKET AND RUBBER COMPONENTS				
1F	94172	1	Valve Body Cover Gasket F4A41/2, F4A4A/B (4-Speed - 4 Cyl.)	1997-On
1F	94172A	1	Valve Body Cover Gasket F4A51/F4A5A/F5A51/A (4 & 5-Speed - V6)	1997-On
2B	94100	1	Pump O'Ring	1997-On
3B	94101	1	Pump Gasket F4A41/F4A4A (4-Speed - 4 Cyl.)	1997-On
3B	94101A	1	Pump Gasket F4A51/F4A5A/F5A51/A (4 & 5-Speed - V6)	1997-On
METAL CLAD SEALS				
10B	70526	1	Front Pump	1997-On
11C	94551	2	Axle (41x61x9mm)	1997-On
SEALING RINGS				
---	K94901	1	Sealing Ring Kit 4-Speed	1997-On
---	K94901F	1	Sealing Ring Kit 5-Speed	2001-On
CLUTCH PLATES				
F4A41/4A/42/4B (4 Speed - 4 Cyl.):				
20C	94321	4-5	Low/Reverse Clutch Friction (Narrow Lining) 30T, .065" - 6.18" O.D.	1997-On
21C	94322	3-4	Low/Reverse Clutch Steel 17T, .039" - 5.54" I.D.	1997-On
24D	94304	3-4	Underdrive Clutch Friction (Waved) 30T, .065" - 5.35" O.D.	1997-On
25D	94305	3-4	Underdrive Clutch Steel 20T, .071" - 4.65" I.D.	1997-On
28D	94306	2-3	2nd Clutch Friction (Wide Lining) 30T, .065" - 6.18" O.D.	1997-On
29D	94307	2-3	2nd Clutch Steel 20T, .099" - 5.12" I.D.	1997-On
29D	94307B	2-3	2nd Clutch Steel 20T, .079" - 5.12" I.D.	1997-On

Mitsubishi F4A41-1/4A, 42-1/4B, 51/5A (4&5-Speed)

Mitsubishi F4/5A41 / 42 / 51

ILL. NO.	PART NUMBER	PER CAR	DESCRIPTION	YEARS
CLUTCH PLATES - Cont'd.				
F4A41/4A/42/4B (4 Speed - 4 Cyl) - Cont'd.:				
31E	94302	2	Reverse Input Clutch Friction 30T, .067" - 5.87" O.D.	1997-On
32E	94303	2	Reverse Input Clutch Steel 20T, .071" - 5.25" I.D.	1997-On
34E	94304	3-4	Overdrive Clutch Friction (Waved) 30T, .065" - 5.35" O.D.	1997-On
35E	94311	3-4	Overdrive Clutch Steel 20T, .099" - 4.65" I.D.	1997-On
F4A51/5A & F5A51/5A (4 & 5-Speed - V6) :				
17A	94308F	3-4	Direct Clutch Friction (5-Speed) 30T, .067" - 4.80" O.D.	2001-On
18A	94309F	3-4	Direct Clutch Steel (5-Speed) 20T, .099" - 3.47" I.D.	2001-On
18A	94309FH	AR	Direct Clutch Steel (5-Speed) 20T, .158" - 3.47" I.D.	2001-On
19C	94312A	1	Low/Reverse Pressure Plate (Front) 1997-On	1997-On
20C	94321A	6	Low/Reverse Clutch Friction (Narrow Lining) 30T, .065" - 7.03" O.D.	1997-On
21C	94322A	5	Low/Reverse Clutch Steel 16T, .039" - 6.29" I.D.	1997-On
22C	94313A	1	Low/Reverse Apply Plate (Rear) 1997-On	1997-On
24D	94304A	4	Underdrive Clutch Friction (Waved) 30T, .065" - 5.82" O.D.	1997-On
25D	94305A	4	Underdrive Clutch Steel 20T, .071" - 4.85" I.D.	1997-On
25D	94305C	1	Underdrive Clutch Steel 20T, .157" - 4.85" I.D.	1997-On
28D	94306A	4	2nd Clutch Friction (Wide Lining) 30T, .065" - 7.03" O.D.	1997-On
29D	94307A	3	2nd Clutch Steel 16T, .099" - 6.00" I.D.	1997-On
29D	94307AB	AR	2nd Clutch Steel 16T, .153" - 6.00" I.D.	1997-On
31E	94302A	2	Reverse Input Clutch Friction 30T, .067" - 6.53" O.D.	1997-On
32E	94303A	2	Reverse Input Clutch Steel 20T, .071" - 6.00" I.D.	1997-On
34E	94304A	4	Overdrive Clutch Friction (Waved) 30T, .065" - 5.82" O.D.	1997-On
35E	94311A	4	Overdrive Clutch Steel 20T, .099" - 4.85" I.D.	1997-On
35E	94311AF	4	Overdrive Clutch Steel 20T, .118" - 4.85" I.D.	2001-On
BANDS				
38A	94714D	1	Reduction Brake Band 5-Speed 2001-On	2001-On
BUSHINGS				
---	K94980	1	Bushing Assortment Kit F4A41/2, F4A4A/B (4-Speed - 4 Cyl.)	1997-On
---	K94980A	1	Bushing Assortment Kit F4A51/F4A5A (4-Speed - V6)	1997-On
---	K94980F	1	Bushing Assortment Kit F5A51/F5A5A (5-Speed - V6)	2001-On
40B	94005W*	1	Pump Bushing (Sonnax, Use w/Alignment Tool - 94005WT) 1997-On	1997-On
TRANSMISSION OIL FILTERS				
50B	94600 ³	1	Oil Filter (Plastic) Disassembly Required 1997-On	1997-On
50B	94600A ³	1	Oil Filter (Late Design) Disassembly Required 1997-On	1997-On
50B	94600F ³	1	Oil Filter (Metal/Plastic) Disassembly Required 1999-On	1999-On
51C	94609 ^{2,3}	1	Oil Filter External Spin-On 1997-On	1997-On
² Mitsubishi has discontinued the use of the spin-on oil filter in model year 1999. ³ Please See Filter Pictures on Page 9.6-6 for Visual Identification.				
SPRAGS				
60D	94813	1	Low Sprag 4-Speed - 4 Cyl. 4/98-On	4/98-On
60D	94813A	1	Low Sprag 4 & 5-Speed - V6 4/97-On	4/97-On

Mitsubishi F4A41/2-1/A/B, 51/5A (FWD 4 & 5-Spd)

ILL. NO.	PART NUMBER	PER CAR	DESCRIPTION	YEARS
SHIFT ENHACEMENTS				
---	K94889	1-2	Pressure Control Valve and Sleeve (No Orifice) . Sonnax	1997-On
---	K94889A	1-2	Pressure Control Valve and Sleeve (w/Orifice)... Sonnax	1997-On
Addresses: Flared Shifts, Shuttle Shifting, Delayed Engagements and Burned Clutches. Note: Valve Diameters Need to Match Your Original Valves. See Sonnax Info.				
---	94989	1	Oversized Pressure Regulator Valve Sonnax	1997-On
Addresses: Low/High Line Pressure, Soft/Harsh Shifts, Low Converter Pressure. Use with K94589 Tool Kit.				
---	K94887	1	TCC Control Valve and Sleeve Kit Sonnax	1997-On
Addresses: Converter Apply and Release Issues, Excessive Slip RPM and TCC Cycling. Note: Valve Diameters Need to Match Your Original Valves. See Sonnax Info.				
---	94780	1-4	Accumulator Piston with Dual Seals Sonnax	1997-On
Addresses: Worn Accumulator Bores, Delayed/Shuddering Engagements & Soft Shifts.				
ELECTRONIC COMPONENTS				
66B	94877	1	Inhibitor Switch 4-Speed - 4 Cyl.	1997-On
66B	94877A	1	Inhibitor Switch 4-Speed - V6.	1997-On
66B	94877F	1	Inhibitor Switch 5-Speed - V6.	2001-On
67C	94875	1	Input Speed Sensor (TISS)	1997-On
68C	94876	1	Output Speed Sensor (TOSS) Horizontal 3-Pin Connector	1997-On
68C	94876A	1	Output Speed Sensor (TOSS) Vertical 3-Pin Connector	1997-On
70E	94871	5-6	Clutch Pack Solenoid (Metal Snout)	1997-On
70E	94871B	5-6	Clutch Pack Solenoid (Plastic Snout)	2000-On
71F	94869	1	Internal Wiring Harness (w/o Temp Sensor) 4-Speed	1997-01
71F	94869A	1	Internal Wiring Harness (w/Temp Sensor) 4-Speed	2001-On
71F	94869F	1	Internal Wiring Harness (w/o Temp Sensor) 5-Speed	2001
71F	94869FA	1	Internal Wiring Harness (w/Temp Sensor) 5-Speed	2001-On
---	94878T	1	Transmission Oil Temperature Sensor.....	1997-01
HARD PARTS				
Note : When ordering Hard Parts, please add the appropriate suffix : (-R) Reman, (-U) Used, (-A) Aftermarket.				
99B	94895	1	Pump Body and Gears F4A41/2, F4A4A/B (4-Speed - 4 Cyl.)	1997-On
99B	94895A	1	Pump Body and Gears F4A51/F5A51/A (4 & 5-Speed - V6)	1997-On
100B	K94895	1	Pump Assembly F4A41/2, F4A4A/B (4-Speed - 4 Cyl.)	1997-On
100B	K94895A	1	Pump Assembly F4A51/F5A51/A (4 & 5-Speed - V6)	1997-On
104B	94801	1	Underdrive Drum F4A41/2, F4A4A/B (4-Speed - 4 Cyl.)	1997-On
104B	94801A	1	Underdrive Drum F4A51/F4A5A (4-Speed - V6)	1997-On
113C	94840	1	Low/Reverse Clutch Piston F4A41/F4A4A (4-Speed - 4 Cyl.)	1997-On
113C	94840A	1	Low/Reverse Clutch Piston F4A51/F5A51/A (4 & 5-Speed - V6)	1997-On
114C	94251	1	Low/Reverse Snap Ring (Updated) .. F4A41/F4A4A (4-Speed - 4 Cyl.)	1997-On
114C	94251A	1	Low/Reverse Snap Ring (Updated) F4A51/F5A51/A (4 & 5-Speed - V6)	1997-On
150E	40-105A	1	Reman Valve Body F4A41/F4A4A (4-Speed - 1.5, 1.8 & 3.6 Litre)	1997-On
150E	40-106	1	Reman Valve Body ... F5A51/A (5-Spd. 6 Sol) Mistu '01-'09, Kia '01-'05, Hyun '01-'06	2001-On
150E	40-106A	1	Reman Valve Body F5A51/A (5-Spd. 7 Sol.) Kia '06-On, Hyundai '07-On	2006-On
TOOLS				
---	94005WT	1	Pump Bushing Alignment Tool (Sonnax, Use w/94005W Pump Bushing)	1997-On