

# F4A33-1 (FWD) & W4A33-1 / 32-1 (AWD)

FWD 4 Speed

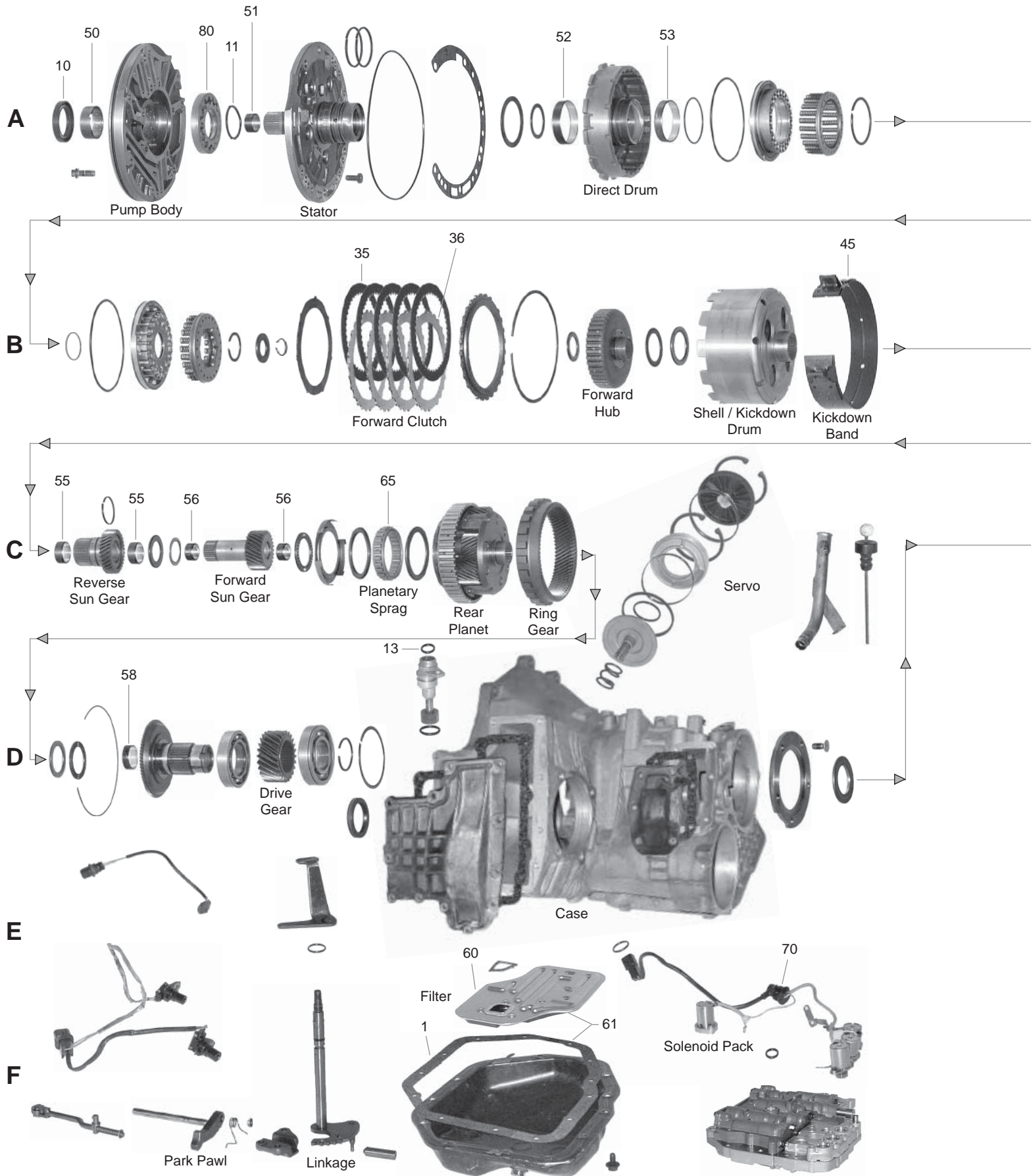



# Mitsubishi F4A33-1 (FWD) & W4A33-1/32-1 (AWD)

ILL. NO.	PART NUMBER	PER CAR	DESCRIPTION	YEARS
<b>Unit Identification:</b> This unit has a one-piece case, a differential side cover, and a bottom pan.				
---	<b>TMF4A33</b>		Technical Manual .....	1991-99
<b>REBUILDER BOX KITS</b>				
---	<b>K7000P-S<sup>1</sup></b>		Master Kit (w/o Steels)..... <b>F/W4A33-1</b> .....	1991-99
---	<b>K7000N-S<sup>1</sup></b>		Master Kit (w/o Steels)..... <b>W4A32-1</b> .....	1991-96
<b>Steel Plate Sub-Kits:</b>				
---	<b>K7000P-9<sup>2</sup></b>		Steel Plate Kit .....	<b>F/W4A33-1</b> ..... 1991-99
---	<b>K7000N-9</b>		Steel Plate Kit .....	<b>W4A32-1</b> ..... 1991-96
<sup>1</sup> When working on a <b>W4A32/33-1 (AWD)</b> , please order <b>K70900N-2</b> Transfer Assembly Sub-Kit in addition to the above kits. <sup>2</sup> <b>1995-99 Hyundai</b> may require .078" Low/Reverse Steels, please order <b>70322PA</b> separately.				
<b>OVERHAUL KITS, GASKET SETS, SEAL KITS AND PAN GASKET</b>				
---	<b>K70900N<sup>1</sup></b>		Overhaul Kit .....	<b>All</b> ..... 1991-99
---	<b>K70900N-2</b>		Sub Kit for Transfer Case Assembly .....	<b>W4A33-1/32-1</b> ..... 1991-99
1F	<b>70170N</b>	1	Oil Pan Gasket .....	<b>Duraprene</b> ..... 1991-99
<b>METAL CLAD SEALS</b>				
10A	<b>70526</b>	1	Front Pump .....	1991-99
11A	<b>70553</b>	1	Inner Pump Gear .....	1991-99
12C	<b>70550</b>	1	End (Overdrive) Clutch .....	<b>16.9mm I.D.</b> ..... 91-5/92
12C	<b>70550B</b>	1	End (Overdrive) Clutch .....	<b>12.9mm I.D.</b> ..... 6/92-99
13D	<b>70509</b>	1	Speedometer .....	1991-99
14D	<b>70551</b>	1	Right Axle ( <b>35x56x9mm</b> ) .....	<b>FWD</b> ..... 91-5/92
14D	<b>70551P</b>	1	Right Axle ( <b>37x56x9mm</b> ) .....	<b>FWD</b> ..... 6/92-99
14D	<b>70551</b>	1	Right Axle ( <b>35x56x9mm</b> ) .....	<b>AWD</b> ..... 1991-99
14D	<b>70551</b>	1	Left Axle ( <b>35x56x9mm</b> ) .....	<b>FWD</b> ..... 91-5/92
14D	<b>70551P</b>	1	Left Axle ( <b>37x56x9mm</b> ) .....	<b>FWD</b> ..... 6/92-99
14D	<b>70552N</b>	1	Left Axle ( <b>35x54x9mm</b> ) .....	<b>AWD</b> ..... 1991-99
---	<b>70554N</b>	1	Transfer Shaft ( <b>Front</b> ) .....	1991-99
---	<b>70552N</b>	1	Transfer Shaft ( <b>Rear</b> ) .....	1991-99
---	<b>70556N</b>	1	Output Shaft/Extension Housing ( <b>32x48x10mm</b> ) .....	1991-99
<b>CLUTCH PLATES</b>				
32A	<b>70302P</b>	4	Front (Direct) Friction ( <b>33-1</b> ) .....	<b>38T, .067"</b> ..... 1991-99
33A	<b>70303P</b>	3	Front (Direct) Steel ( <b>33-1</b> ) .....	<b>26T, .088"</b> ..... 1991-99
32A	<b>70304G</b>	3	Front (Direct) Friction ( <b>32-1</b> ) .....	<b>4.095" I.D.</b> ..... 1991-96
33A	<b>70312R</b>	2	Front (Direct) Steel ( <b>32-1</b> ) .....	<b>4.115" I.D.</b> ..... 1991-96
35B	<b>70304P</b>	5	Rear (Forward) Friction ( <b>33-1</b> ) .....	<b>42T, .067"</b> ..... 1991-99
36B	<b>70305P</b>	5	Rear (Forward) Steel ( <b>33-1</b> ) .....	<b>26T, .071" - 110mm I.D.</b> ..... 1991-99
35B	<b>70304G</b>	3	Rear (Forward) Friction ( <b>32-1</b> ) .....	<b>4.095" I.D.</b> ..... 1991-96
36B	<b>70305G</b>	2	Rear (Forward) Steel ( <b>32-1</b> ) .....	<b>4.115" I.D.</b> ..... 1991-96
39B	<b>70321P</b>	6	Low/Reverse Friction ( <b>33-1</b> ) .....	<b>54T, .067"</b> ..... 1991-99
40B	<b>70322P</b>	5	Low/Reverse Steel ( <b>33-1</b> ) .....	<b>20T, .039" - 141mm I.D.</b> ..... 1991-99
40B	<b>70322PA</b>	AR	Low/Reverse Steel ( <b>33-1, Hyundai</b> ) .....	<b>20T, .078" - 141mm I.D.</b> ..... 1995-99
39B	<b>70321G</b>	6	Low/Reverse Friction ( <b>32-1</b> ) .....	<b>.076"</b> ..... 1991-96
40B	<b>70322H</b>	5	Low/Reverse Steel ( <b>32-1</b> ) .....	<b>.040"</b> ..... 1991-96
43C	<b>70308</b>	4	End (Overdrive) Friction ( <b>All</b> ) .....	<b>40T, .075"</b> ..... 1991-99
44C	<b>70309</b>	4	End (Overdrive) Steel ( <b>All</b> ) .....	<b>25T, .032"</b> ..... 1991-99

# Mitsubishi F4A33-1 (FWD) & W4A33-1/32-1 (AWD)

Mitsubishi F4A33-1

ILL. NO.	PART NUMBER	PER CAR	DESCRIPTION	YEARS
<b>BANDS</b>				
45B	<b>70714P</b>	1	Brake Band ..... <b>F/W4A33-1</b> .....	1991-99
45B	<b>70714</b>	1	Brake Band ..... <b>W4A32-1</b> .....	1991-96
<b>BUSHINGS</b>				
---	<b>K70980L</b>	1	Bushing Kit ..... <b>All</b> .....	1991-99
50A	<b>70005</b>	1	Front Pump Body ..... <b>All</b> .....	1991-99
51A	<b>70001L</b>	1	Stator Support ..... <b>All</b> .....	1991-99
52A	<b>70002L</b>	1	Direct Clutch Drum ( <b>Front</b> ) ..... <b>All</b> .....	1991-99
53A	<b>70008L</b>	1	Direct Clutch Drum ( <b>Rear</b> ) ..... <b>All</b> .....	1991-99
54B	<b>70003</b>	1	Low/Reverse Drum ( <b>Front</b> ) ..... <b>All</b> .....	1991-99
55C	<b>70006L</b>	2	Reverse Sun Gear ..... <b>All</b> .....	1991-99
56C	<b>70016L</b>	2	Forward Sun Gear ..... <b>All</b> .....	1991-99
57C	<b>70016L</b>	1	End (Overdrive) Clutch Shaft ..... <b>All</b> .....	1991-99
58D	<b>70009L</b>	1	Output Shaft ( <b>Front</b> ) ..... <b>All</b> .....	1991-99
<b>TRANSMISSION OIL FILTERS</b>				
60E	<b>70600N</b> <sup>3</sup>	1	Oil Filter ..... <b>All</b> .....	1991-99
61E	<b>ATK-127</b>	1	Oil Filter Kit ..... <b>All</b> .....	1991-99
<sup>3</sup> Please See Filter Pictures on Page 9.1-6 for Visual Identification.				
<b>SPRAGS</b>				
65C	<b>70814P</b>	1	Planetary Sprag ( <b>28 Elements</b> ) ..... <b>F/W4A33-1</b> .....	1991-99
65C	<b>51814</b>	1	Planetary Sprag ( <b>26 Elements</b> ) ..... <b>W4A32-1</b> .....	1991-96
<b>SHIFT ENHANCEMENTS</b>				
---	<b>K70944F</b> <sup>4</sup>	1	Shift Kit ..... <b>TransGo</b> .....	1991-99
---	<b>ST70944F</b> <sup>4</sup>	1	Shift Kit ..... <b>Superior, TransLab Version</b> .....	1991-99
<sup>4</sup> Addresses the Following Complaints: 2-3 Cutloose and/or Soft 3rd, 3rd Clutch Burn-Up, 3-4 Neutral, 4-2 Kickdown Runaway, Coast Downshift Bang, Long Slide 1-2 and 3-4, No Forward and/or Reverse, Won't Fill the Converter, Low or No Cooler Flow, and Wrong Fluid Level.				
---	<b>70896F</b>	1	Manual Valve ..... <b>Sonnax</b> .....	1991-99
<b>ELECTRONIC COMPONENTS</b>				
70E	<b>K70879U</b>	1	Solenoid Pack ( <b>EPC, Shift and 3-Ohm TCC</b> ) ..... <b>Rostra</b> .....	1991-99
70E	<b>K70879AU</b>	1	Solenoid Pack ( <b>EPC, Shift, No TCC</b> ) ..... <b>Rostra</b> .....	1991-99
70E	<b>K70879BU</b>	1	Solenoid Pack ( <b>EPC, Shift and 12-Ohm TCC</b> ) ..... <b>Rostra</b> .....	1993-99
---	<b>70871U</b>	1-2	Shift Solenoid ..... <b>Teckpak</b> .....	1991-99
---	<b>70870U</b>	1	EPC Solenoid ..... <b>Teckpak</b> .....	1991-99
---	<b>70870U</b>	1	T.C.C Solenoid ( <b>3-Ohm</b> ) ..... <b>Teckpak</b> .....	1991-99
---	<b>70870AU</b>	1	T.C.C Solenoid ( <b>12-Ohm</b> ) ..... <b>Teckpak</b> .....	1993-99
<b>MISCELLANEOUS</b>				
80A	<b>K70965P</b>	1	Pump Gear Set .....	1991-99