

F4A-EL / 4EAT-F / IF4E / F4EIII

FWD 4 Speed (1 Pan)

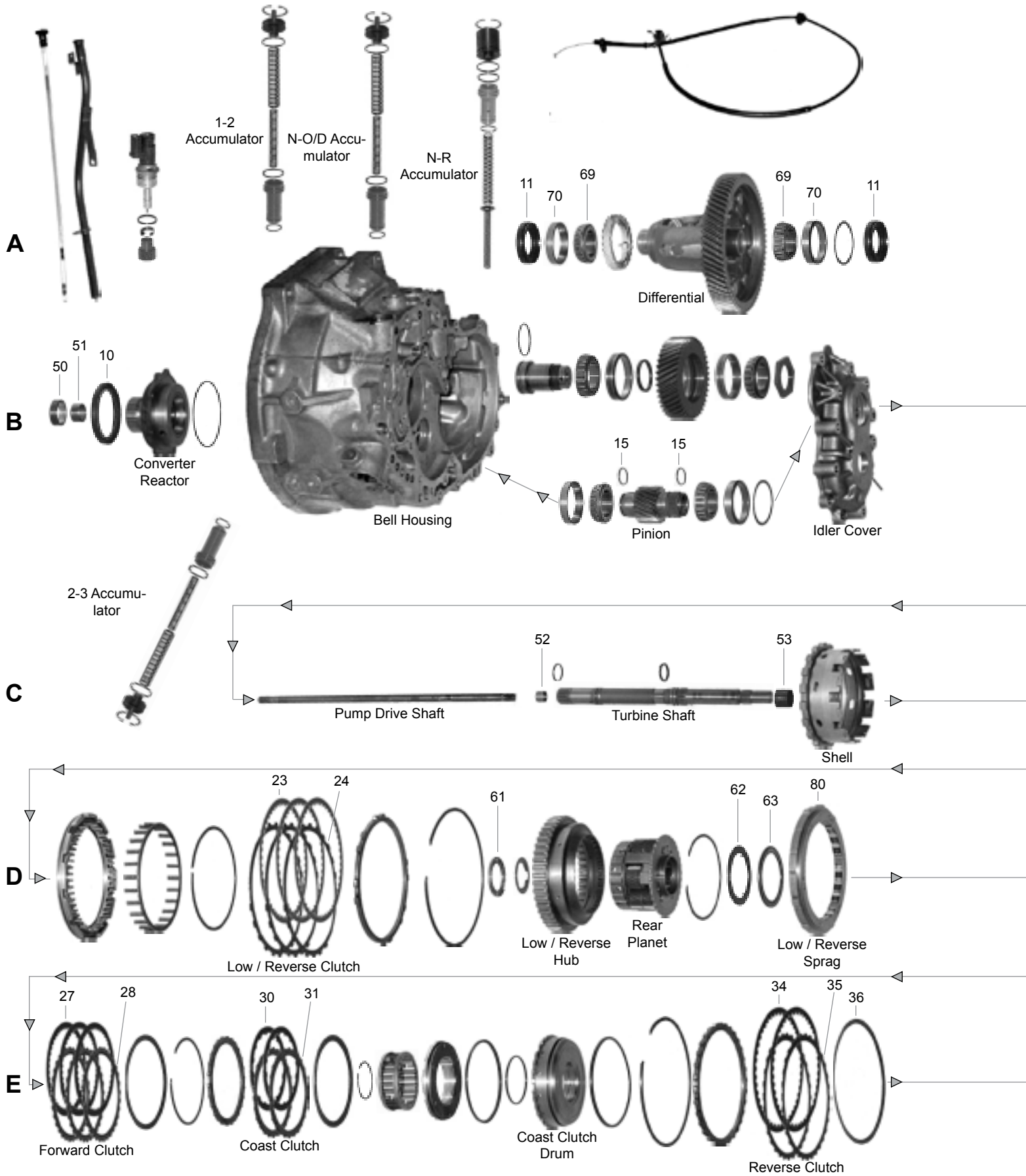

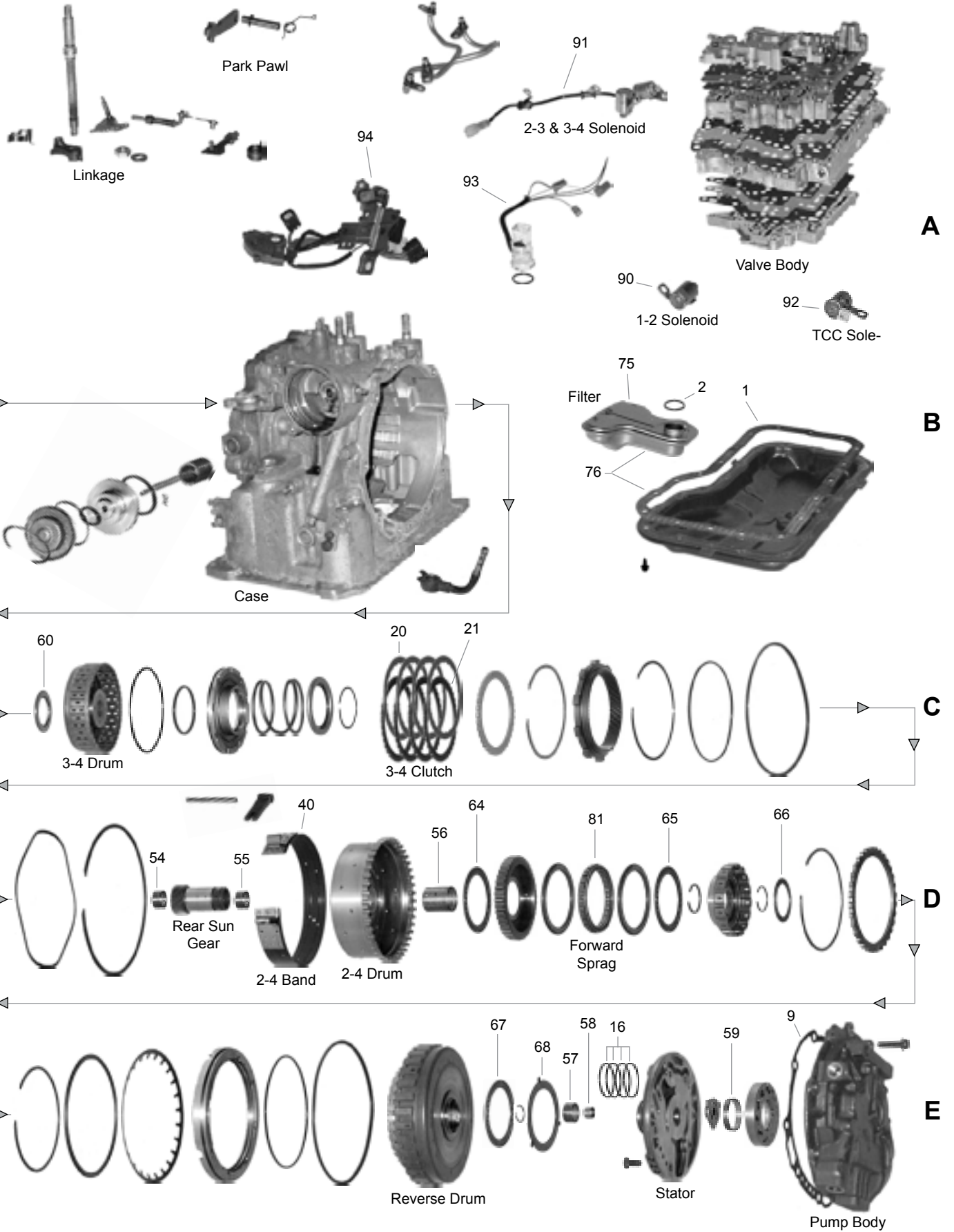

Mazda F4A-EL, Ford 4EAT-F, IF4E, F4E-III

VEHICLE MODEL	YEARS	TRANS. TYPE		
MAZDA:				
323	1990-94	F4A-EL (4-Solenoid w/TV Cable)		
MX-3	1992-95	F4A-EL (4-Solenoid w/TV Cable)		
Protege	1990-96	F4A-EL (4-Solenoid w/TV Cable)		
	1997-98	FB4A-EL (5-Solenoid w/o TV Cable)		
FORD & MERCURY:				
Ford Escort and Mercury Tracer	1991-96	4EAT-F (4-Solenoid w/TV Cable)		
	1997	IF4E (4-Solenoid w/TV Cable)		
	1998-02	F4E-III (5-Solenoid w/o TV Cable)		
KIA:				
Sephia	1997-98	F4A-EL (4-Solenoid w/TV Cable)		
Sephia, Spectra & Rio/Cinco	1998-05	FB4A-EL (5-Solenoid w/o TV Cable)		
ILL. NO.	PART NUMBER	PER CAR	DESCRIPTION	YEARS
TECHNICAL MANUALS				
	TMF4A-EL		Technical Manual	1990-05
MASTER BOX KITS				
---	K8400-S		Master Kit (w/o Steels)	1990-02
---	K8400K-S		Master Kit (w/o Steels)	2003-05
Steel Plate Sub-Kits:				
---	K8400-9 ¹		Steel Plate Kit Ford and Mercury	1990-97
---	K8400D-9		Steel Plate Kit Ford and Mercury	1998-02
---	K8400-9 ¹		Steel Plate Kit Mazda	1990-93
---	K8400D-9		Steel Plate Kit Mazda	1994-98
---	K8400-9		Steel Plate Kit Kia w/.091" 3-4 Steels	1997-05
---	K8400D-9		Steel Plate Kit Kia w/.130" 3-4 Steels	1997-05
¹ For units built before 9/1/90, please order (4) 84311Z Steels separately.				
OVERHAUL KITS, GASKET SETS, AND SEAL KITS				
---	K84900	1	Overhaul Kit	1990-05
---	K84900-1	1	Gasket and Rubber Kit	1990-05
---	K84900-3	1	Valve Body Gasket Set w/4-Solenoids	1990-98
---	K84900F-3	1	Valve Body Gasket Set w/5-Solenoids	1997-05
GASKET AND RUBBER COMPONENTS				
1B	84170	1	Pan Gasket Duraprene	1990-05
2B	84120	1	Oil Filter O'Ring	1990-05
9E	84101	1	Pump Gasket	1990-05
METAL CLAD SEALS				
10B	73526	1	Converter Hub	1990-05
11A	70551	2	Axle	1990-05
SEALING RINGS				
---	K84901	1	Sealing Ring Kit OEM - Teflon	1990-05
15B	84203 ²	2	Output Gear Shaft (Sealed Power) Metal	1990-05
16E	84200 ²	4	Pump (Sealed Power) Metal	1990-05
² Not included in Ring Kits, please order separately if desired.				

Mazda F4A-EL, Ford 4EAT-F, IF4E, F4E-III

ILL. NO.	PART NUMBER	PER CAR	DESCRIPTION	YEARS
CLUTCH PLATES				
20C	84310	4	3-4 Friction 110mm O.D. - .062"	1990-05
21C	84311Z	4	3-4 Steel (Before 9/1/90) 38T, .063"	1990-91
21C	84311A	4	3-4 Steel 38T, .071"	1990-05
21C	84311	4	3-4 Steel (From 9/1/90) 38T, .091"	1991-05
21C	84311D	3	3-4 Steel 38T, .130"	1994-05
23D	84306	4	Low & Reverse Friction 180mm O.D. - .062"	1990-05
24D	84307	4	Low & Reverse Steel 16T, .063"	1990-05
27E	84304	3	Forward Friction 42T, .062"	1990-02
27E	84304K	3	Forward Friction 42T, .072"	2003-05
28E	84305	3	Forward Steel 32T, .063"	1990-05
30E	84308	2	Coast Friction 115mm O.D. - .062"	1990-05
31E	84309	2	Coast Steel 26T, .063"	1990-05
34E	84321	2	Reverse Friction 175mm O.D. - .062"	1990-05
35E	84322	2	Reverse Steel 32T, .063"	1990-05
36E	84322B	1	Reverse Cushion (Drum Saver) 4 Waves	1990-05
BANDS				
40D	84714	1	2-4 Band	1990-05
BUSHINGS				
---	K84980	1	Bushing Assortment Kit (* Not Included)	1990-05
50B	73005	1	Converter	1990-05
51B	84009	1	Converter Reactor 1.011" O.D.	1990-05
52C	84012	1	Turbine Shaft535" O.D.	1990-05
53C	84015P*	1	Turbine Shaft (Ribbed Plastic)	1990-05
54D	84002	1	Sun Gear (w/4 Holes) Front - .949" O.D.	1990-05
55D	84003	1	Sun Gear Rear	1990-05
56D	84004	1	Forward Drum/Sun Gear Shell 1.317" O.D.	1990-05
57E	84000	1	Pump Stator Body Front - .947" O.D.	1990-05
58E	84001	1	Pump Stator Body Rear - .513" O.D.	1990-05
59E	84010	1	Pump Gear Inner - 1.620" O.D.	1990-05
THRUST WASHERS AND BEARINGS				
---	K84941	1	Thrust Bearing Kit (*Not Included)	1990-05
60C	84423	1	Output Shell to 3-4 Drum Needle Bearing	1990-05
61D	84421	1	3-4 Drum to Planetary Needle Bearing	1990-05
62D	84425	1	Planetary to Sun Gear Shell Race	1990-05
63D	84420	1	Planetary Race to Forward Drum/Sun Gear Shell Needle Bearing	1990-05
64D	84420	1	Forward Drum/Sun Shell to Forward Hub/Input Sprag Needle Bearing	1990-05
65D	84422	1	Forward Hub/Input Sprag to Coast Clutch Hub Needle Bearing	1990-05
66D	84421	1	Coast Clutch Hub to Reverse Drum Needle Bearing	1990-05
67E	84420	1	Reverse Clutch Drum to Pump Selective Needle Bearing	1990-05
68E	73400*	AR	Pump Support Thrust Washer - Selective 1.2 mm	1990-05
68E	K73442* ³	1	Pump Support Shims (Six - .015")	1990-05
			³ Use under the original washer to adjust unit end-play.	
Differential Bearings:				
69A	48430*	2	Differential Bearing	1990-99
70A	48431*	2	Differential Race	1990-99

Mazda F4A-EL, Ford 4EAT-F, IF4E, F4E-III

ILL. NO.	PART NUMBER	PER CAR	DESCRIPTION	YEARS
OIL FILTERS				
75B	84600 ⁴	1	Oil Filter (Metal w/Screens)	1990-05
75B	84600A ⁴	1	Oil Filter (Plastic w/60-Micron Felt Media)	1990-05
75B	84601 ⁴	1	Oil Filter (w/.750" Inlet)	2001-05
76B	ATK-131	1	Oil Filter Kit	1990-05
76B	ATK-240	1	Oil Filter Kit (w/.750" Inlet)	2001-05
⁴ Please See Filter Pictures on Page 7.2-6 for Visual Identification.				
SPRAGS AND ROLLER CLUTCHES				
80D	K84813	1	Low Roller w/Race	1990-05
81D	84814	1	Forward Sprag	1990-05
SHIFT ENHANCEMENTS				
---	K84944 ⁵	1	Shift Kit (w/Spool Valve) TransGo	1990-05
⁵ Rough 1-2, 3rd Clutch Failure, High Line, Low Line and Won't Move Condition.				
---	ST84944 ⁶	1	Shift Correction Package Superior	1990-05
⁶ Delayed, Slip or Chatter in Reverse Warm, 2-3 Flare, Bumpy 1-2, Converter Won't Release and Converter Failure. Improves Line and Overall Reliability.				
---	K84889 ⁷	1	Pump Spool Valve	1990-05
⁷ This Valve Corrects Low Line Pressure and Soft/Slide Shifts.				
---	K73889D	1	Boost Valve and Sleeve Kit (Sonnax, Minor Modification Required)	1990-05
---	K84989 ⁸	1	Oversized Pressure Regulator Valve Kit (Sonnax, Use w/K84589 Tool Kit)	1990-05
⁸ High Line, Low Line, Harsh Shifts, Lack of Cooler Flow and Blued Converters.				
---	K84886F ⁹	1	Oversized Pressure Modifier Valve (Sonnax, Use w/K84586F Tool Kit)	1998-05
⁹ Erratic Shift Quality, Soft 1-2 Shift, 3rd Clutch Failure and Delayed Reverse.				
ELECTRONIC COMPONENTS				
90A	84871	1	1-2 Shift Solenoid (Green Connector)	1990-05
91A	84872 ¹⁰	1	2-3/3-4 Shift Solenoid Set Large Connector .490" Wide	1990-05
91A	84872K ¹⁰	1	2-3/3-4 Shift Solenoid Set Small Connector .425" Wide	1999-05
¹⁰ Solenoid Sets are the same except for the connector, which can be switched with original if needed.				
92A	84870	1	T.C.C. Solenoid	1990-05
---	84879	1	EPC Solenoid (Mazda/Ford) 5-Solenoid Units	1997-02
---	84879K	1	EPC Solenoid (Kia) 5-Solenoid Units	1999-05
---	K84871U	1	Solenoid Pack (Rostra) 4-Solenoid Units	1990-98
93A	84869	1	Internal Wiring Harness w/Temp. Sensor 4-Solenoid Units	1990-97
93A	84869F	1	Internal Wiring Harness w/Temp. Sensor 5-Solenoid Units	1997-05
94A	84877	1	MLPS Sensor Ford	1990-96
94A	84877F	1	MLPS Sensor Ford	1997-02
---	GS60	1	Ground Strap (60") Battery Negative to Transmission	1990-05