

AWTF80SC / 81SC (AF21/AF40-6)

FWD 6 Speed

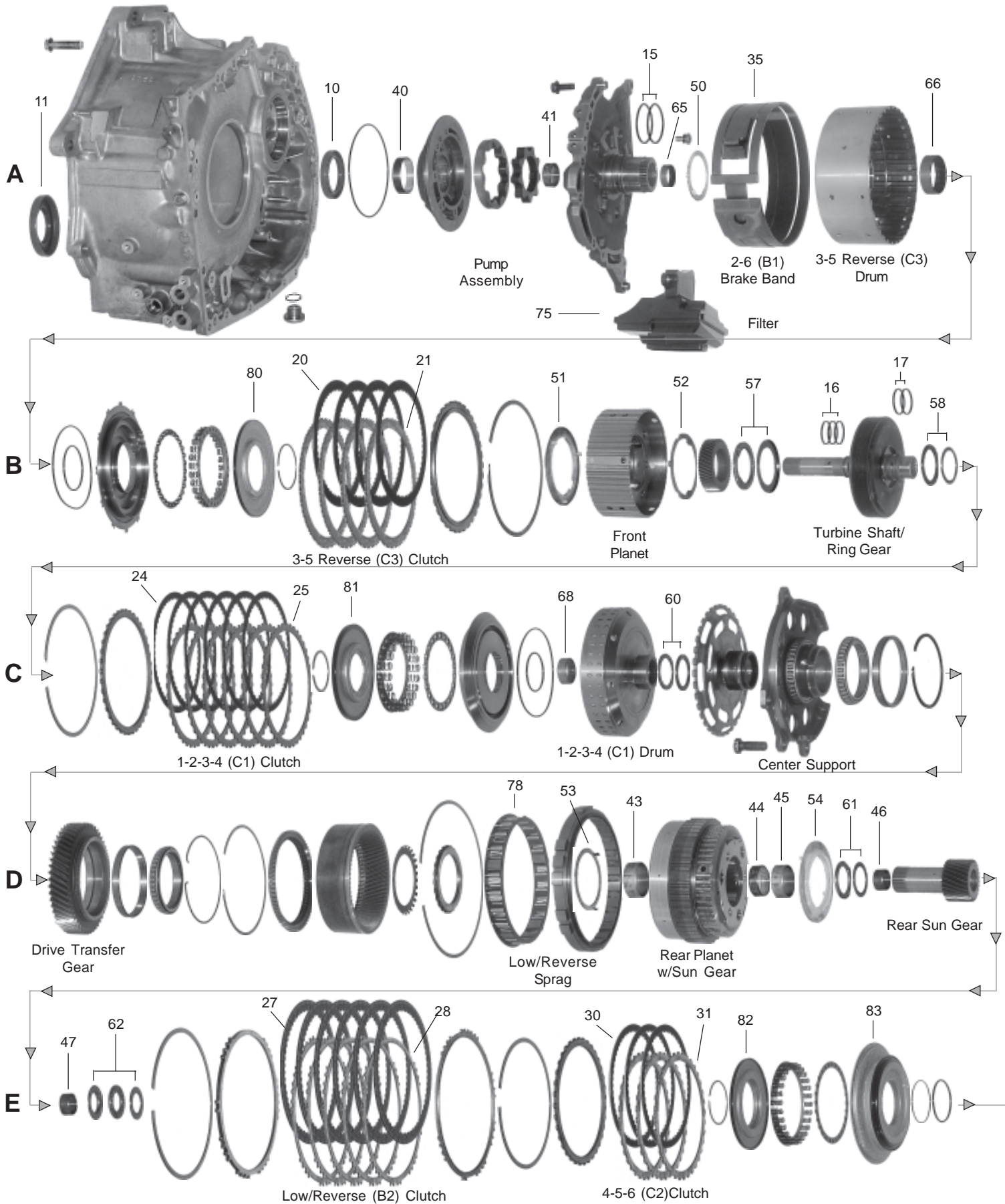

AWTF80SC / 81SC (AF21/AF40-6)

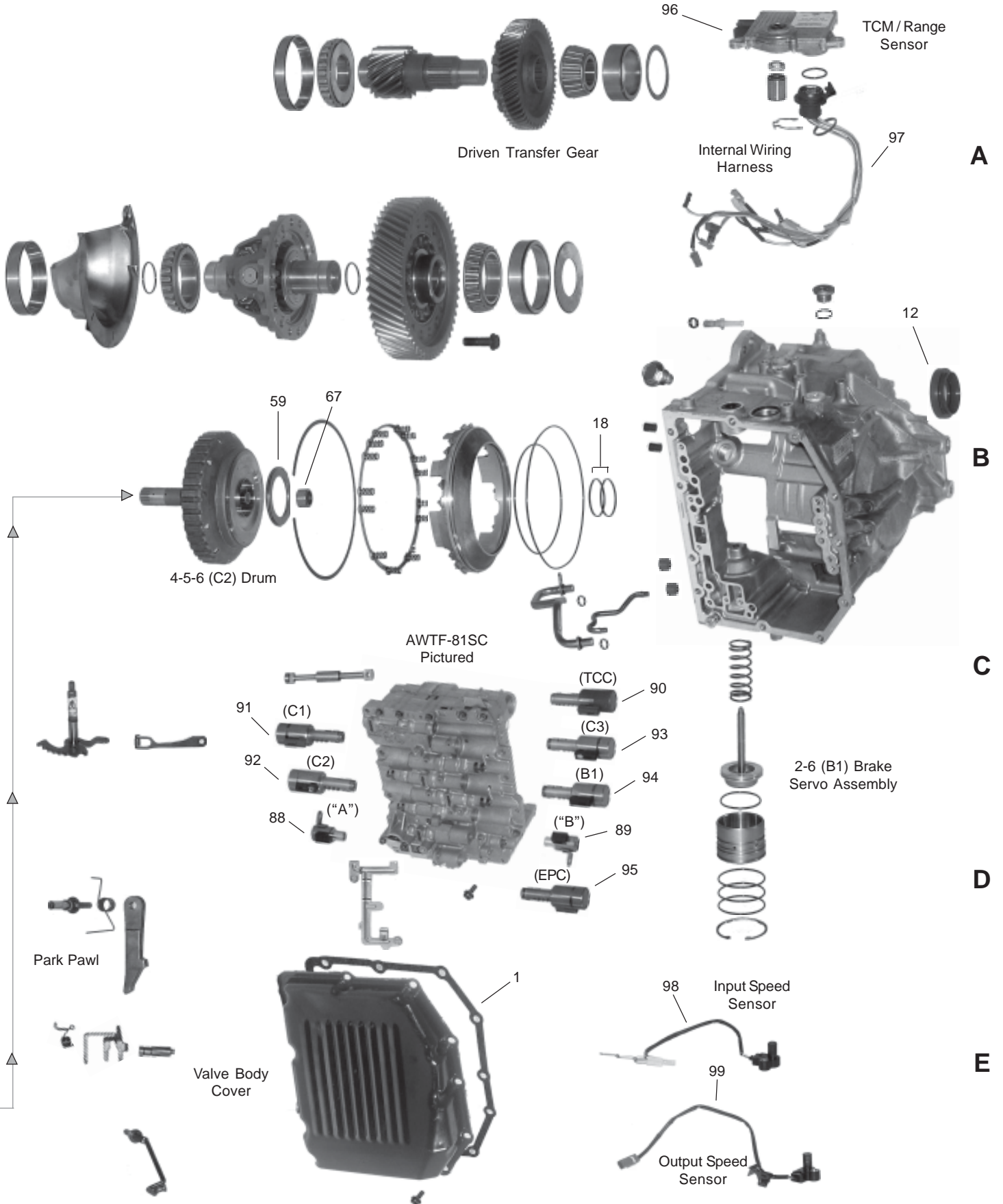

Aisin AWTF-80(AF-40) /81SC(AF-21) FWD 6-Spd.

ILL. NO.	PART NUMBER	PER CAR	DESCRIPTION	YEARS
	TMAWTF80		Technical Manual	2005-On
	TMAWTF81		Technical Manual	2006-On
REBUILDER KITS				
---	K8900F-S¹		Master Kit (w/o Steels) AWTF-81SC / AF-21 (Ford/Mazda)	2005-On
---	K8900G-S¹		Master Kit (w/o Steels) AWTF-80SC / AF-40 (GM/SAAB)	2006-On
---	K8900GV-S¹		Master Kit (w/o Steels) AWTF-80SC (Volvo)	2006-08
Steel Plate Sub-Kits:				
----	K8900F-9		Steel Plate Kit AWTF-81SC / AF-21 (Ford/Mazda)	2005-On
----	K8900G-9		Steel Plate Kit AWTF-80SC / AF-40 (GM/SAAB/Volvo)	2006-On
¹ Kits do not include Molded Rubber Pistons, please order K89900F-4 separately.				
OVERHAUL KITS, VALVE BODY GASKET SETS				
---	K89900F¹		Overhaul Kit AWTF-81SC / AF-21 (Ford/Mazda)	2005-On
---	K89900G¹		Overhaul Kit AWTF-80SC / AF-40 (GM/SAAB)	2006-On
---	K89900GV¹		Overhaul Kit AWTF-80SC (Volvo)	2006-08
---	K89900F-3		Valve Body Gasket Set AWTF-81SC / AF-21 (Ford/Mazda)	2005-On
---	K89900G-3		Valve Body Gasket Set AWTF-80SC / AF-40 (GM/Volvo/SAAB)	2006-On
---	K88900N-5		Overhaul Kit (Volvo AWD Transfer Case Section)	2006-On
GASKET AND RUBBER COMPONENTS				
1E	89175F	1	Valve Body Cover Gasket AWTF-81SC / AF-21 (Ford/Mazda)	2005-On
1E	89175G	1	Valve Body Cover Gasket AWTF-80SC / AF-40 (GM/Volvo/SAAB)	2006-On
METAL CLAD SEALS				
10A	89526F	1	Pump Seal All	2005-On
11A	89551F	1	Axle Seal (Right, Bellhousing) Fusion, Milan, Zephyr, MKZ, Mazda	2005-On
11A	89551FA	1	Axle Seal (Right, Bellhousing) Five Hundred, Montego	2005-On
11A	89551G	1	Axle Seal (Right, Bellhousing) GM / SAAB	2006-On
11A	89551GV	1	Axle Seal (Right, Bellhousing - 2WD) Volvo	2006-08
11A	89553GV	1	Axle Seal (Right, Bellhousing - AWD) Volvo	2006-08
11A	88551N	1	Axle Seal (Right, Bellhousing) Peugeot	2006-On
12B	89552F	1	Axle Seal (Left, Case) Fusion, Milan, Zephyr, MKZ, Mazda	2005-On
12B	89552FA	1	Axle Seal (Left, Case) Five Hundred, Montego	2005-On
12B	89552G	1	Axle Seal (Left, Case) GM / SAAB	2006-On
12B	89552GV	1	Axle Seal (Left, Case) Volvo	2006-08
12B	89552GP	1	Axle Seal (Left, Case) Peugeot	2006-On
SEALING RINGS				
---	K89901F	1	Sealing Ring Kit (Teflon) All	2005-On
15A	89200FT	2	Pump Stator to C3 Drum	2005-On
16B	89201FT	3	Input Shaft to Pump	2005-On
17B	89202FT	2	Input Shaft to C1 Drum	2005-On
18B	89203FT	2	Case Stator to C2 Drum	2005-On
CLUTCH PLATES				
20B	89310F	4	3rd, 5th & Reverse (C3) Friction 54T, .067" - 6.520" O.D.	2005-On
21B	89311F	4	3rd, 5th & Reverse (C3) Steel 36T, .091" - 5.562" I.D.	2005-On
24C	89304F	6-7	1st, 2nd, 3rd, & 4th (C1) Friction 54T, .066" - 6.184" O.D.	2005-On
25C	89305F	6-7	1st, 2nd, 3rd, & 4th (C1) Steel 40T, .071" - 5.560" I.D.	2005-On

Aisin AWTF-80(AF-40) /81SC(AF-21) FWD 6-Spd.

AWTF-80/81

ILL. NO.	PART NUMBER	PER CAR	DESCRIPTION	YEARS
CLUTCH PLATES - Cont'd,				
27E	89321F	6-7	1st & Reverse (B2) Friction 60T, .066" - 7.305" O.D.	2005-On
28E	89322F	5-6	1st & Reverse (B2) Steel 14T, .068" - 6.820" I.D.	2005-On
30E	89308F	3-4	4th, 5th & 6th (C2) Friction 55T, .066" - 6.290" O.D.	2005-On
31E	89309F	3-4	4th, 5th & 6th (C2) Steel 36T, .071" - 5.640" I.D.	2005-On
BANDS				
35A	89714F	1	2-6 Brake Band (B1)	2005-On
BUSHINGS				
---	K89980F		Bushing Assortment Kit	2005-On
40A	89005F	1	Front Pump	2005-On
41A	89001F	1	Front Pump Stator	2005-On
43D	89004F	1	Rear Planet (Front - .620" Wide)	2005-On
44D	89006F	1	Rear Planet (Front - .425" Wide)	2005-On
45D	89007F	1	Rear Planet (Rear - .620" Wide)	2005-On
46D	89008F	1	Rear Sun Gear (Front)	2005-On
47E	89009F	1	Rear Sun Gear (Rear)	2005-On
THRUST WASHERS				
---	K89940F	1	Thrust Washer Kit	2005-On
---	K89941F	1	Thrust Bearing Kit	2005-On
Washers:				
50A	89400F	1	Pump Washer to C3 Drum (Plastic, 1-Tab)	2005-On
51B	89401F	1	C3 Drum to Front Planet (Plastic, 3 Hollow Alignment Dowels - TF81)	2005-On
51B	89401G	1	C3 Drum to Front Planet (Plastic, 5 Hollow Alignment Dowels - TF80)	2006-On
52B	89402F	1	Front Planet to Front Ring Gear (3-Tab)	2005-On
53D	89403F	1	Center Support to Rear Planet (Brass, 3-Tab)	2005-On
54D	89405F	1	Rear Planet to C2 Drum (Plastic, 6 Hollow Alignment Dowels)	2005-On
Thrust Bearings:				
57B	K89420F	1	Front Planet to Ring Gear Bearing and Race	2005-On
58B	K89421F	1	Front Ring Gear to C1 Drum Bearing and Race	2005-On
59B	89422F	1	C2 Drum to Case Bearing	2005-On
60C	K89423F	1	C1 Drum to Drive Shell Bearing and Race	2005-On
61D	K89424F	1	Rear Planet to Rear Sun Gear Bearing & Race	2005-On
62E	K89425F	1	Rear Sun Gear to C2 Drum Bearing & Race	2005-On
Caged Bearings:				
65A	89430F	1	Rear Stator Caged Needle Bearing	2005-On
66A	89431F	1	C3 Drum Caged Needle Bearing	2005-On
67B	89432F	1	C2 Drum to Case Caged Needle Bearing	2005-On
68C	89433F	1	C1 Drum Caged Needle Bearing	2005-On
TRANSMISSION OIL FILTERS				
75A	89600F	1	Oil Filter (Disassembly Required)	2005-On
SPRAGS				
78D	89813F	1	Low Roller Clutch (F1)	2005-On

Aisin AWTF-80(AF-40) /81SC(AF-21) FWD 6-Spd.

ILL. NO.	PART NUMBER	PER CAR	DESCRIPTION	YEARS
MOLDED RUBBER PISTONS				
---	K89900F-4	1	Piston Kit Molded Rubber	2005-On
80B	89846F	1	3-5, Reverse (C3) Balance Piston Molded Rubber	2005-On
81C	89847F	1	1st, 2nd, 3rd & 4th (C1) Balance Piston Molded Rubber	2005-On
82E	89848F	1	4th, 5th & 6th (C2) Balance Piston Molded Rubber	2005-On
83E	89844F	1	4th, 5th & 6th (C2) Apply Piston Molded Rubber	2005-On
ELECTRONIC COMPONENTS				
Note : When ordering Solenoids, for Aftermarket please add the (-A) Suffix, for Reman add (-R).				
<u>AWTF-81SC, Ford & Mazda:</u>				
88D	89871FA	1	SSA Shift "A" Solenoid (On/Off)	2005-On
89D	89871FA	1	SSB Shift "B" Solenoid (On/Off)	2005-On
90D	89870F	1	TCC Torque Converter Clutch Solenoid (PWM) (Black)	2005-On
91D	89879F	1	SSD (C1) Clutch Control Solenoid (PWM) (Green)	2005-On
92D	89879F	1	SSF (C2) Clutch Control Solenoid (PWM) (Green)	2005-On
93D	89873F	1	SSC (C3) Clutch Control Solenoid (PWM) (Blue)	2005-On
94D	89873F	1	SSE (B1) Band Control Solenoid (PWM) (Blue)	2005-On
95D	89879F	1	PCA (EPC) Pressure Control Solenoid (PWM) (Green)	2005-On
---	K89879F-R	1	Solenoid Kit (Includes Six PWM Solenoids - Sol Pro)	2005-On
96A	K89877F	1	Range Sensor/TCM Control Module	2005-On
97A	89869F	1	Internal Wiring Harness w/TFT Sensor	2005-On
98E	89875F	1	Input Speed Sensor (White Connector)	2005-On
99E	89876F	1	Output Speed Sensor (Brown Connector)	2005-On
<u>AWTF-80SC, GM / Volvo / SAAB / Land Rover:</u>				
88D	89871GA	1	S1 Shift "A" Solenoid (On/Off)	2006-On
89D	89871GA	1	S2 Shift "B" Solenoid (On/Off)	2006-On
90D	89870F	1	SLU (TCC) Torque Converter Clutch Solenoid (PWM - Black)	2006-On
91D	89879F	1	SLC1 (C1) Clutch Control Solenoid (PWM) (Green)	2006-On
92D	89879F	1	SLC2 (C2) Clutch Control Solenoid (PWM) (Green)	2006-On
93D	89873F	1	SLC3 (C3) Clutch Control Solenoid (PWM) (Blue)	2006-On
94D	89879G	1	SLB1 (B1) Band Control Solenoid (PWM) (Brown)	2006-On
95D	89879G	1	SLT (EPC) Pressure Control Solenoid (PWM) (Brown)	2006-On
---	K89879G-R	1	Solenoid Kit (Includes Six PWM Solenoids - Sol Pro)	2006-On
96A	K89877G	1	Range Sensor/TCM Control Module	2006-On
97A	89869G	1	Internal Wiring Harness w/TFT Sensor	2006-On
98E	89875G	1	Input Speed Sensor	2006-On
99E	89876G	1	Output Speed Sensor	2006-On
---	K89879-2	1	Solenoid Rebuilding Kit (Enough for One Unit, Use w/K89912 Tool)	2006-On
---	89070	AR	Solenoid Bushings (SolPro, Use for Renewing Solenoids, 2 per Solenoid)	2006-On
---	K89912	1	Solenoid Repair Tool (Omega/SolPro, Use for Disassembly and Reassembly)	2006-On
SHIFT ENHANCEMENTS				
---	K89944F	1	Shift Kit TF81 SC - TransGo	2005-On
Reduces/Corrects/Prevents: Harsh Shifts, Cut-Loose, Rough Coasting Downshifts, Slow Pressure Rise and TCC Slip.				
---	K89944G	1	Shift Kit TF80SC - TransGo	2006-On
Reduces/Corrects/Prevents: Harsh Shifts, Cut-Loose, Rough Coasting Downshifts, Slow Pressure Rise and TCC Slip.				
---	K89947F	1	Pro Proven Valve Body/Solenoid Repair Kit .. TF81SC - VB Pro	2005-On
Addresses: Common Driveability and Wear Issues that Originate in the Valve Body and Solenoids. No Reaming Required all "Drop-in" Components. A Universal Solenoid Tool (K89912) is Required to Rebuild Solenoids.				

Aisin AWTF-80(AF-40) /81SC(AF-21) FWD 6-Spd.

AWTF-80/81

ILL. NO.	PART NUMBER	PER CAR	DESCRIPTION	YEARS
SHIFT ENHANCEMENTS - Cont'd.				
---	K89947G	1	Pro Proven Valve Body/Solenoid Repair Kit .. TF80SC - VB Pro Addresses: Common Driveability and Wear Issues that Originate in the Valve Body and Solenoids. No Reaming Required all "Drop-in" Components. A Universal Solenoid Tool (K89912) is Required to Rebuild Solenoids.	2006-On
---	K89989F	1	Main Pressure Regulator & Boost Assembly Sonnax Addresses: Excess Pressure in Reverse, Fluid and Converter Lining Overheat. Use with K89589F Tool Kit.	2005-On
---	K89887	1	Lockup Clutch Control Valve Kit Sonnax Addresses: Harsh Downshifts, RPM Surging on Coast or Light Acceleration, Converter Apply/Release Complaints and Converter Slip. Use with K89587 Tool Kit.	2005-On
---	K89883F	1	Secondary Regulator Valve Kit Sonnax Addresses: Overheating of Fluid, Bushings and Converter. Use with K89583F Reamers.	2005-On
---	K89884F	1	Solenoid Modulator Valve Kit Sonnax Addresses: DTC's P0734, P0735 or P0729, Slippage or Shock on Kickdown and Slips in 4th, 5th or 6th. Use with K89584F Tool Kit.	2005-On
---	K89882F	1	B1 Brake Band Control Valve Kit Sonnax Addresses: Harsh Downshifts, Flare on 1-2, 2-3 & 5-6 Upshifts, B-1 Brake Failure, Firm 3-2, 2-1 or 6-5 Coast Downshifts, Driveability Change with Operating Temp. Use with K89582F Tool Kit.	2005-On
---	K89881	1	C1/K1 Clutch Control Valve Kit Sonnax Addresses: Flare Upshifts or Downshifts, Bind-Up, Clutch Overlap, Pressure Control Out-of-Range Codes. Use with K89581 Tool Kit.	2005-On
---	K89885F	1	C2 Clutch Control Valve Kit Sonnax Addresses: Flare Upshifts or Downshifts, Bind-Up, Clutch Overlap, Pressure Control Out-of-Range Codes. Use with K89585F Tool Kit.	2005-On
---	K89886F	1	C3 Clutch Control Valve Kit Sonnax Addresses: Flare Upshifts or Downshifts, Bind-Up, Clutch Overlap, Pressure Control Out-of-Range Codes. Use with K89585F Tool Kit.	2005-On
---	K89783	1-5	Clutch/Band/Line Accumulator Piston Kit Sonnax Addresses: Delayed Engagements, Slipping in Forward Gears and Burned Friction.	2005-On
---	K89780F	1-2	Solenoid Modulator Accumulator Piston Kit Sonnax, AWTF-81 Only Addresses: Delayed Engagements, Slipping in Forward Gears and Burned Friction.	2005-On
---	K89880	1	O'Ringed End Plug Kits (Five 9mm Plugs) Sonnax Addresses: Shift Complaints Associated with Circuit Pressure Loss.	2005-On
---	K89880A	1	O'Ringed End Plug Kits (Five 11mm Plugs) Sonnax Addresses: Shift Complaints Associated with Circuit Pressure Loss.	2005-On
HARD PARTS				
---	15-153A	1	Reman Valve Body (Ford, Mercury, Mazda) Addresses: Shift Complaints Associated with Circuit Pressure Loss.	2005-On
---	90-103A	1	Reman Valve Body (Volvo) Addresses: Shift Complaints Associated with Circuit Pressure Loss.	2006-08
Notes:				