

A606 (42LE)

FWD 4 Speed

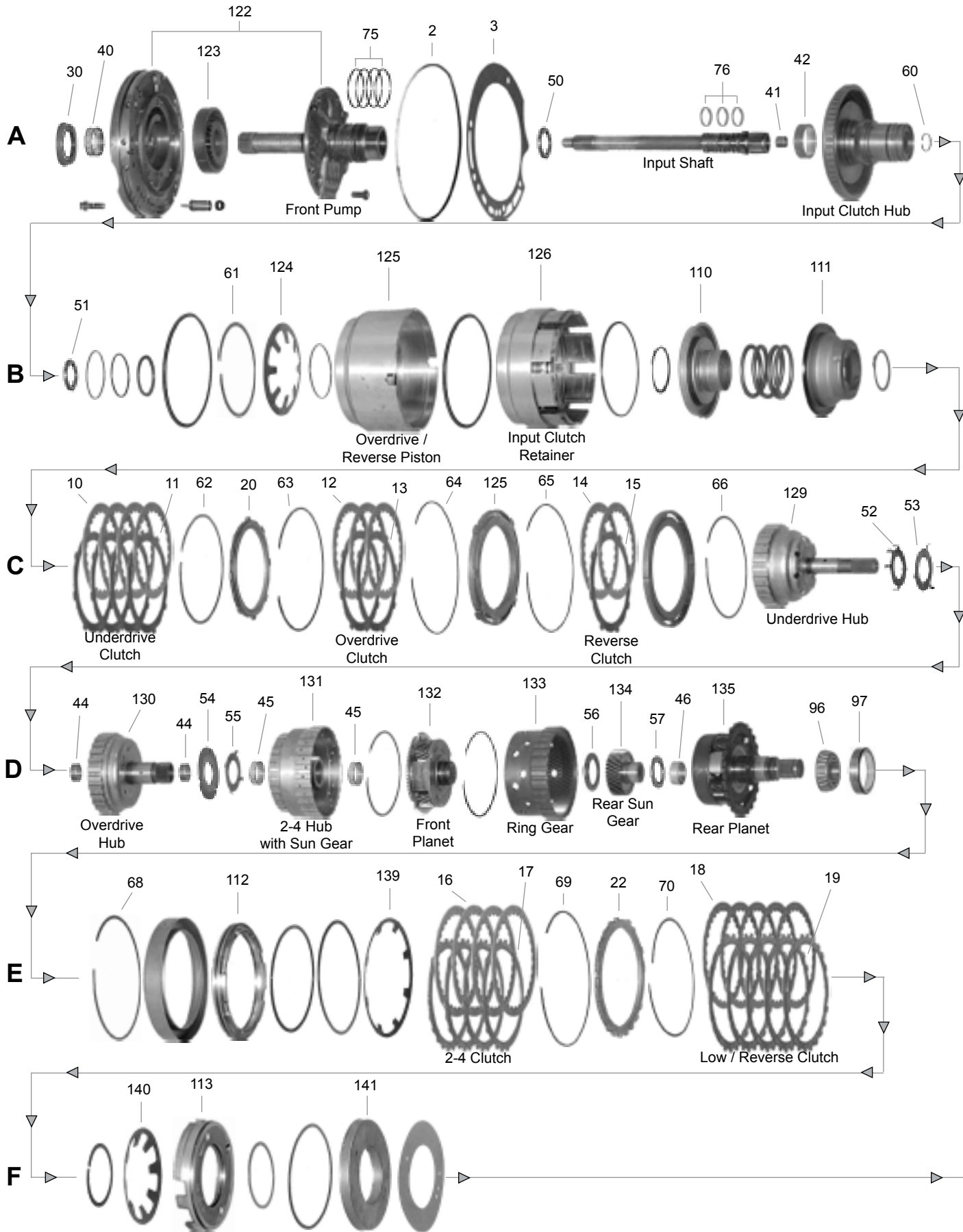

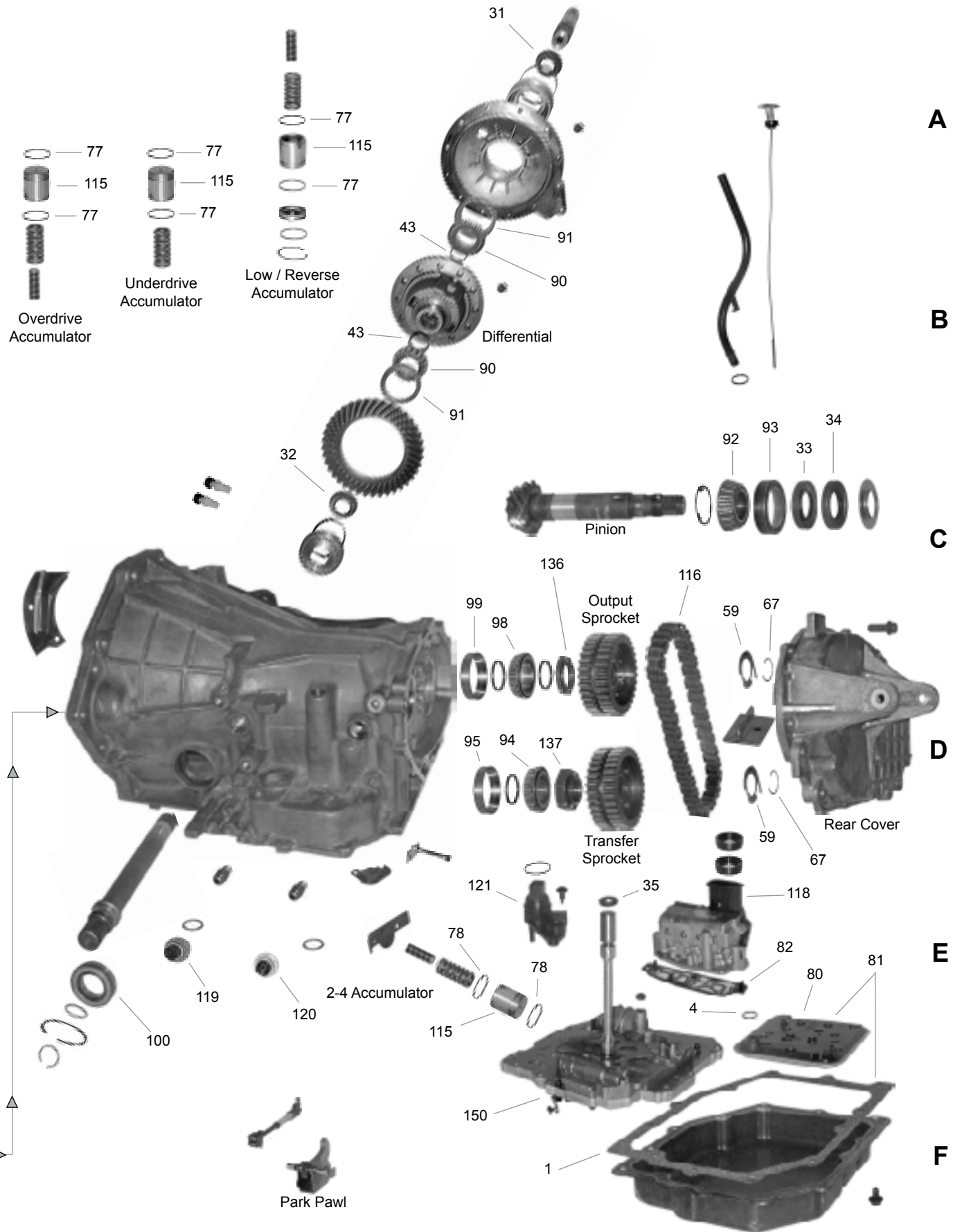

Chrysler A606 (42LE)

ILL. NO.	PART NUMBER	PER CAR	DESCRIPTION	YEARS
	TMA606		Technical Manual	1993-04
REBUILDER BOX KITS				
---	MRK3200L-S ¹		Master Rebuilder Kit (w/o Steels) High Energy Frictions	1993-04
---	K3200L-S ¹		Master Kit (w/o Steels) High Energy Frictions	1993-04
Steel Plate Sub-Kits:				
---	K3200L-9		Steel Plate Kit	1993-04
OVERHAUL KITS, GASKET SETS AND SEAL KITS				
---	K32900L ¹		Overhaul Kit	1993-04
---	K32900L-1 ¹		Gasket & Rubber Kit Duraprene	1993-04
---	K32900L-8		External Seal-up Kit Duraprene	1993-04
---	K32900L-7		Front Pump Seal-up Kit	1993-04
¹ Some 2004 units utilize molded rubber L/R, 2-4 and Accumulator pistons, please order K32900JT-4 separately.				
GASKET AND RUBBER COMPONENTS				
1F	32170L	1	Pan Gasket Duraprene	1993-04
2A	48100	1	Oil Pump Housing Seal	1993-04
3A	32101L	1	Oil Pump Housing Gasket	1993-04
---	3601SL	5	Front Pump Bolt Washers	1993-04
4E	3410L	1	Oil Filter O'Ring	1993-04
---	37140A	AR	Valve Body Check Ball Plastic - 1/4"	1993-04
CLUTCH PLATES				
10C	32308HE*	4	Underdrive Friction (High Energy) 28T, .071" - 5.433" O.D.	1993-04
11C	32309	4	Underdrive Steel 8T, .067" - 4.527" I.D.	1993-04
12C	32308HE*	4	Overdrive Friction (High Energy) 28T, .071" - 5.433" O.D.	1993-04
13C	32309	3	Overdrive Steel 8T, .067" - 4.527" I.D.	1993-04
14C	32308HE*	2	Reverse Input Friction (High Energy) 28T, .071" - 5.433" O.D.	1993-04
15C	32309	1	Reverse Input Steel 8T, .067" - 4.527" I.D.	1993-04
16E	32304HE*	4	2-4 Friction (High Energy) 32T, .086" - 6.063" O.D.	1993-04
17E	32305	4	2-4 Steel 14T, .100" - 5.256" I.D.	1993-04
18E	32321HE*	5	Low/Reverse Friction (High Energy) 32T, .072" - 6.063" O.D.	1993-04
19E	32322	5	Low/Reverse Steel 14T, .067" - 5.256" I.D.	1993-04
* Warning: Do not use sanded or tumbled steel plates with high energy frictions!!				
PRESSURE PLATES				
20C	K32312	1	Under/Overdrive Reaction Plate275" w/.075" Snap Ring/32254B	1993-96
20C	K32312A	1	Under/Overdrive Reaction Plate256" w/.075" Snap Ring/32254B	1993-96
20C	K32312B	1	Under/Overdrive Reaction Plate236" w/.075" Snap Ring/32254B	1993-96
20C	K32312C	1	Under/Overdrive Reaction Plate217" w/.075" Snap Ring/32254B	1993-96
20C	K32312HA	1	Under/Overdrive Reaction Plate224" w/.090" Snap Ring/32254H	1997-04
20C	K32312HB	1	Under/Overdrive Reaction Plate244" w/.090" Snap Ring/32254H	1997-04
20C	K32312HC	1	Under/Overdrive Reaction Plate265" w/.090" Snap Ring/32254H	1997-04
22E	K32313J ²	AR	Low/Reverse & 2-4 Reaction Plate207" - .217"	1993-04
22E	K32313JB ²	AR	Low/Reverse & 2-4 Reaction Plate227" - .237"	1993-04
22E	K32313JD ²	AR	Low/Reverse & 2-4 Reaction Plate247" - .257"	1993-04
22E	K32313JF ²	AR	Low/Reverse & 2-4 Reaction Plate267" - .277"	1993-04
² This 2nd design kit, with a recessed pressure plate and thicker snap ring, retrofits all early designs.				

Chrysler A606 (42LE)

ILL. NO.	PART NUMBER	PER CAR	DESCRIPTION	YEARS
METAL CLAD SEALS				
30A	12575	1	Converter Hub	1993-04
31A	32551L	1	Axle (Right)	1993-04
32C	32552L	1	Axle (Left)	1993-04
33C	32553L	1	Transfer (Pinion) Shaft (Small)	1993-04
34C	32554L	1	Transfer (Pinion) Shaft (Large)	1993-04
35E	32507	1	Manual Lever Seal	1993-04
BUSHINGS				
---	K32980L	1	Bushing Assortment Kit (* Not Included)	1993-04
40A	12502*	1	Front Pump Bronze	1993-04
40A	12502A	1	Front Pump Babbitt	1993-04
40A	12502W*	1	Front Pump Sonnax, Tighter Tolerance	1993-04
41A	32002	1	Input Shaft595" O.D.	1993-04
41A	32002N*	1	Input Shaft Over .608" O.D.	2002-04
42A	32004	1	Input Clutch Hub 1.907" O.D.	1993-04
42A	32004W*	1	Input Clutch Hub Sonnax, Tighter Tolerance 1.907" O.D. Use w/K32912W Tool ..	1993-04
43B	32010	2	Differential Support 1.320" O.D.	1993-04
44D	32003	2	Overdrive Clutch Hub O/D Hub I.D. .9590"	1993-95
44D	32003W*	1	Overdrive Clutch Hub (Sonnax 1-piece) O/D Hub I.D. .9590"	1993-95
44D	32003G³	2	Overdrive Clutch Hub O/D Hub I.D. .9370"	1996-04
44D	32003GW*³	1	Overdrive Clutch Hub (Sonnax 1-piece) O/D Hub I.D. .9370"	1996-04
44D	32003HW*³	1	Overdrive Clutch Hub (Sonnax 1-piece) O/D Hub I.D. .9410"	1996-04
45D	32006	2	2nd & 4th Clutch Hub 1.155" I.D.	1993-95
45D	32006G³	2	2nd & 4th Clutch Hub 1.171" I.D.	1996-04
46D	32009	1	Rear Planetary Pinion Carrier 1.225" O.D.	1993-04
			³ These may be found in early units.	
THRUST WASHERS AND BEARINGS				
---	K32941L	1	Thrust Washer and Bearing Kit (No Selectives)	1993-04
50A	32420	1	Stator Shaft to Input Clutch Bearing	1993-04
51B	32421	1	Input Clutch Hub to Underdrive Hub Bearing	1993-04
52C	32400	1	Underdrive Hub to Overdrive Hub 5 Tabs	1993-04
53C	32450	1	Thrust Plate (O/D Hub to Underdrive Hub) 3 Tabs	1993-04
54D	32409	AR	O/D Clutch Hub Thrust Plate035"	1993-04
54D	32409A	AR	O/D Clutch Hub Thrust Plate053"	1993-04
54D	32409B	AR	O/D Clutch Hub Thrust Plate069"	1993-04
54D	32409C	AR	O/D Clutch Hub Thrust Plate079"	1993-04
54D	32409D	AR	O/D Clutch Hub Thrust Plate089"	1993-04
54D	32409E	AR	O/D Clutch Hub Thrust Plate098"	1993-04
54D	32409F	AR	O/D Clutch Hub Thrust Plate107"	1993-04
54D	32409G	AR	O/D Clutch Hub Thrust Plate115"	1993-04
54D	32409H	AR	O/D Clutch Hub Thrust Plate127"	1993-04
55D	32402	1	Overdrive Hub to 2-4 Hub 4 Tabs	1993-04
56D	32422	1	2-4 Hub to Rear Sun Gear Bearing	1993-04
57D	32421	1	Rear Sun Gear to Rear Planetary Bearing	1993-04
59D	32405L	2	Sprocket Finger (Tension) Washer	1993-04
SNAP RINGS				
---	K32289C	1	Snap Ring Assortment Kit Complete	1993-04
60A	32258	1	Input Shaft Retaining	1993-04
61B	32256	1	Reverse/Overdrive Belleville	1993-04
62C	32255	1	Under/Overdrive Reaction Plate Flat - .060"	1993-96
62C	32255H	1	Under/Overdrive Reaction Plate Flat - .075"	1997-04

Chrysler A606 (42LE) - Cont'd.

ILL. NO.	PART NUMBER	PER CAR	DESCRIPTION	YEARS
SNAP RINGS - Cont'd.				
63C	32254A	1	Under/Overdrive Reaction Plate Taper - .060"	1993-96
63C	32254B	1	Under/Overdrive Reaction Plate Taper - .075"	1993-96
63C	32254H	1	Under/Overdrive Reaction Plate Taper - .090"	1997-04
64C	32253	1	O/D-Reverse Pressure Plate Flat	1993-04
65C	32253W	1	O/D-Reverse Pressure Plate Waved	1993-04
66C	32250	1	Reverse Pressure Plate Flat - .060"	1993-04
66C	32250A	1	Reverse Pressure Plate Flat - .070"	1993-04
66C	32250B	1	Reverse Pressure Plate Flat - .080"	1993-04
66C	32250C	1	Reverse Pressure Plate Flat - .090"	1993-04
67D	32252L	2	Sprocket Retaining 1.125" O.D.	1993-04
68E	32257	1	2-4 Housing Retainer	1993-04
69E	32251A	1	Low/Reverse Pressure Plate Taper - .068"	1993-04
69E	32251J	1	Low/Reverse Pressure Plate Taper - .075"	1998-04
70E	32251	1	Low/Reverse Pressure Plate Flat	1993-04
SEALING RINGS				
---	K32901	1	Sealing Ring Kit	1993-04
75A	32200	4	Reaction Shaft Support Seal Plated	1993-04
76A	32201T	3	Input Shaft Teflon	1993-04
77A	32202T	6	Low & Reverse Accumulator Teflon	1993-04
78E	32202T	2	2nd & 4th Accumulator Teflon	1993-04
TRANSMISSION OIL FILTERS				
80E	32600L	1	Oil Filter	1993-04
81E	ATK-144	1	Oil Filter Kit	1993-04
---	K32900L-2	1	Solenoid Screens and Gasket Set	1993-04
82E	32615L	1	Solenoid Assembly Filter Gasket See Page 3.14-8	1993-04
DIFFERENTIAL BEARINGS AND RACES				
---	K32434L	1	Differential Bearing Kit (*Not Included)	1993-04
90B	48432L	2	Differential Housing Bearing (Cone)	1993-04
91B	48433L	2	Differential Housing Bearing Race (Cup)	1993-04
92C	32438L	1	Transfer Shaft Bearing (Cone)	1993-04
93C	32439L	1	Transfer Shaft Bearing Race (Cup)	1993-04
94D	32436L	1	Transfer Shaft Sprocket Bearing (Cone)	1993-04
95D	32437L	1	Transfer Shaft Sprocket Bearing Race (Cup)	1993-04
96D	32430	1	Output Shaft (Rear Planet) Bearing (Cone)	1993-04
97D	32431	1	Output Shaft (Rear Planet) Bearing Race (Cup)	1993-04
98D	48432	1	Output Sprocket Bearing (Cone)	1993-04
99D	48433	1	Output Sprocket Bearing Race (Cup)	1993-04
100E	32435L*	1	Stub Shaft Sealed Ball Bearing (2 3/8" O.D.)	1993-04
PISTONS				
---	K32900JT-4	1	Molded Rubber Piston Kit (* Included)	2004
110B	32843	1	Underdrive Clutch Piston (Metal)	1993-04
111B	32847*	1	Underdrive Piston Spring Retainer (Bonded Rubber)	1993-04

Chrysler A606 (42LE) - Cont'd.

ILL. NO.	PART NUMBER	PER CAR	DESCRIPTION	YEARS
PISTONS - Cont'd.				
112E	32842JA*	1	2-4 Clutch Piston (Molded Rubber)	2004
113F	32840T*	1	Low/Reverse Piston (Molded Rubber)	2004
---	32783J*	1	Low/Reverse Accumulator Piston Cover Retrofits to 1993	2004
115A/E	32782J	1-4	Accumulator Piston (Molded Rubber) <i>Factory Discontinued</i>	2004
115A/E	32782	1	2-4 Accumulator Piston	1993-03
115A/E	K32780 ⁴	1-4	Accumulator Bore Sleeve and Piston Kit (Enough for One Location)	1993-03
⁴ It will fit all four accumulator locations and salvages worn cases and valve bodies.				
DRIVE CHAINS				
116D	32888L	1	Drive Chain 1 3/4" Wide	1993-94
116D	K32888N	1	Drive Chain Kit Two 3/4" Wide Chains	1995-04
SHIFT ENHANCEMENTS AND VALVES				
---	K32943	1	SK604 Jr. No Limp Kit (Valve Body and Shift Upgrades)	1993-04
---	32889 ⁵	1	Boost Valve Bushing	1993-04
⁵ Prevents High Line Pressure Instability.				
---	K32887 ⁶	1	Converter Regulator Valve Kit Sonnax	1993-04
⁶ This kit addresses high converter pressure which is responsible for converter shudder, friction failure, cooler restriction, and finally, geartrain failure.				
---	32886VP ⁷	1	Solenoid Switch Valve Plugs Sonnax	1993-04
---	32886VPL ⁷	1	Solenoid Switch Valve Plugs (Oversized) Sonnax, Use w/32586L Reamer	1993-04
⁷ Prevents cocking of plugs in the bore which causes erratic TCC operation and codes.				
---	32885W	1	Solenoid Switch Valve (Oversized) Sonnax, Use w/32585 Reamer	1993-04
---	32881B	1	Cooler Bypass Valve	1993-04
---	K32881E	1	Cooler Bypass Plug (Directs All Oil Through the Cooler and Eliminates TCC Slip/Overheat) ..	1994-97
ELECTRONIC COMPONENTS				
Note : When ordering a Solenoid Assembly, please add the (-R) suffix for a Remanufactured Unit, if Desired.				
118E	32879L	1	Shift Solenoid and Switch Assembly	1993-04
---	K32900L-2	1	Solenoid Screens and Gasket Set	1993-04
---	K32900-2W	1	Solenoid Pack Repair Kit (Sonnax, Three Diaphragms and Contacts)	1993-04
---	32859LVC	1	Solenoid Body Connector Repair Kit Renews Harness Side	1993-04
119E	32875	1	Input Speed Sensor (TISS)	1993-04
120E	32876	1	Output Speed Sensor (TOSS)	1993-04
---	32855VC	1	Speed Sensor Connector Repair Kit Renews Harness Side	1993-04
121E	32877L	1	Manual Lever Position Sensor Internal (Round Terminals)	1993-98
121E	32877N	1	Transmission Range Sensor Sensor. Internal (Spade Terminals)	10/98-04
---	32857NVC	1	Transmission Range Sensor Connector Repair Kit (Spade Pin Sensor)	10/98-04
HARD PARTS AND MISCELLANEOUS				
Note : When ordering Hard Parts, please add the appropriate suffix : (-R) Reman, (-U) Used, (-A) Aftermarket.				
122A	K32895L	1	Pump Assembly (25-Tooth Inner Gear)	1993-00
122A	K32895M	1	Pump Assembly (w/12-Tooth Inner Gear)	2000-04
123A	K32965	1	Pump Gears (25-Tooth Inner Gear - .708" Thick)	1989-00
123A	K32965H	1	Pump Gears (12-Tooth Inner Gear - .495" Thick)	2000-04
124B	32764	1	Reverse/Overdrive Belleville Spring	1993-04

Chrysler A606 (42LE) - Cont'd.

ILL. NO.	PART NUMBER	PER CAR	DESCRIPTION	YEARS
HARD PARTS AND MISCELLANEOUS - Cont'd.				
Note : When ordering Hard Parts, please add the appropriate suffix : (-R) Reman, (-U) Used, (-A) Aftermarket.				
125B	K32801	1	Overdrive/Reverse Piston and Pressure Plate (4-Lug)	1993-04
126B	K32844H ⁸	1	Updated Input Clutch Retainer Package	1993-04
			⁸ Includes Two Selective Plates (.224" & .244"), and Two Snap Rings (32254H & 32255H.)	
126B	32844H	1	Updated Input Clutch Retainer Use w/32254H, 32255H Snap Rings	1997-04
129C	32803	1	Underdrive Hub (Solid Shaft)	1993-04
130D	32804	1	Overdrive Hub (29mm)	1993-95
130D	32804G	1	Overdrive Hub (29.5mm)	1996-04
130/1D	K32863	1	2-4 Hub/Sun Gear and Overdrive Hub Upgrade Kit	1993-04
131D	32863	1	2-4 Hub and Sun Gear (29mm)	1993-95
131D	32863G	1	2-4 Hub and Sun Gear (29.5mm)	1996-04
132D	32833	1	Front Planetary	1993-04
132D	K32833 ⁹	1	Front Planet, 2-4 Hub & Overdrive Hub Upgrade Kit	1993-04
			⁹ Kit includes ill. # 130D, 131D, & 132D	
133D	32864	1	Rear Ring Gear	1993-04
134D	32865	1	Rear Sun Gear	1993-04
135D	32831L	1	Rear Planetary	1993-04
---	K32835L ¹⁰	1	Geartrain Kit (6 pieces)	1993-04
			¹⁰ Kit includes: Both Planets, 2-4 Hub, O/D Hub, Rear Sun Gear and Rear Ring Gear.	
136D	32892L	1	Output Shaft Nut (Thin, 36mm I.D.)	1993-04
137D	32891L	1	Transfer Shaft Nut (Thick, 33 mm I.D.)	1993-04
139E	32762	1	2-4 Belleville Spring	1993-04
140F	32760	1	Low/Reverse Belleville Spring	1993-04
141F	32837	1	Low/Reverse Clutch Piston Retainer (w/4 Holes) . In Kits	1993-03
141F	32837J	1	Low/Reverse Clutch Piston Retainer (w/5 Holes - Bleed Hole)	2003-04
---	32881L	1	Differential Backlash Access Plug	1993-04
150F	10-131	1	Valve Body (Reman) Fits Units w/Internal MLPS - Round Pin	1993-98
150F	10-132	1	Valve Body (Reman) Fits Units w/Internal MLPS - Spade Pin	1999-04
TOOLS				
---	T1420K	1	O/D and Reverse Reaction Plate Spring Compressor Kit	1993-04
---	T1430	1	Input Clutch Outer Lip Seal Installer/Protector	1993-04
---	T1432	1	Output Shaft/Rear Planetary Bearing Remover	1993-04
---	T1435	1	Transfer Shaft Bearing Snap Ring Remover/Installer	1993-04
---	T1437	1	2-4 Spring Compressor Kit	1993-04
---	T1455	1	Differential Bearing Remover	1993-04
---	T3202	1	Mainshaft Spline Socket	1993-04
---	T3204	1	Mainshaft Retaining Nut Wrench	1993-04
---	K32912W	1	Bushing Installation Tool for 32004W	1993-04