

A604 (40TE, 41TE / TES, 41AE)

FWD 4 Speed

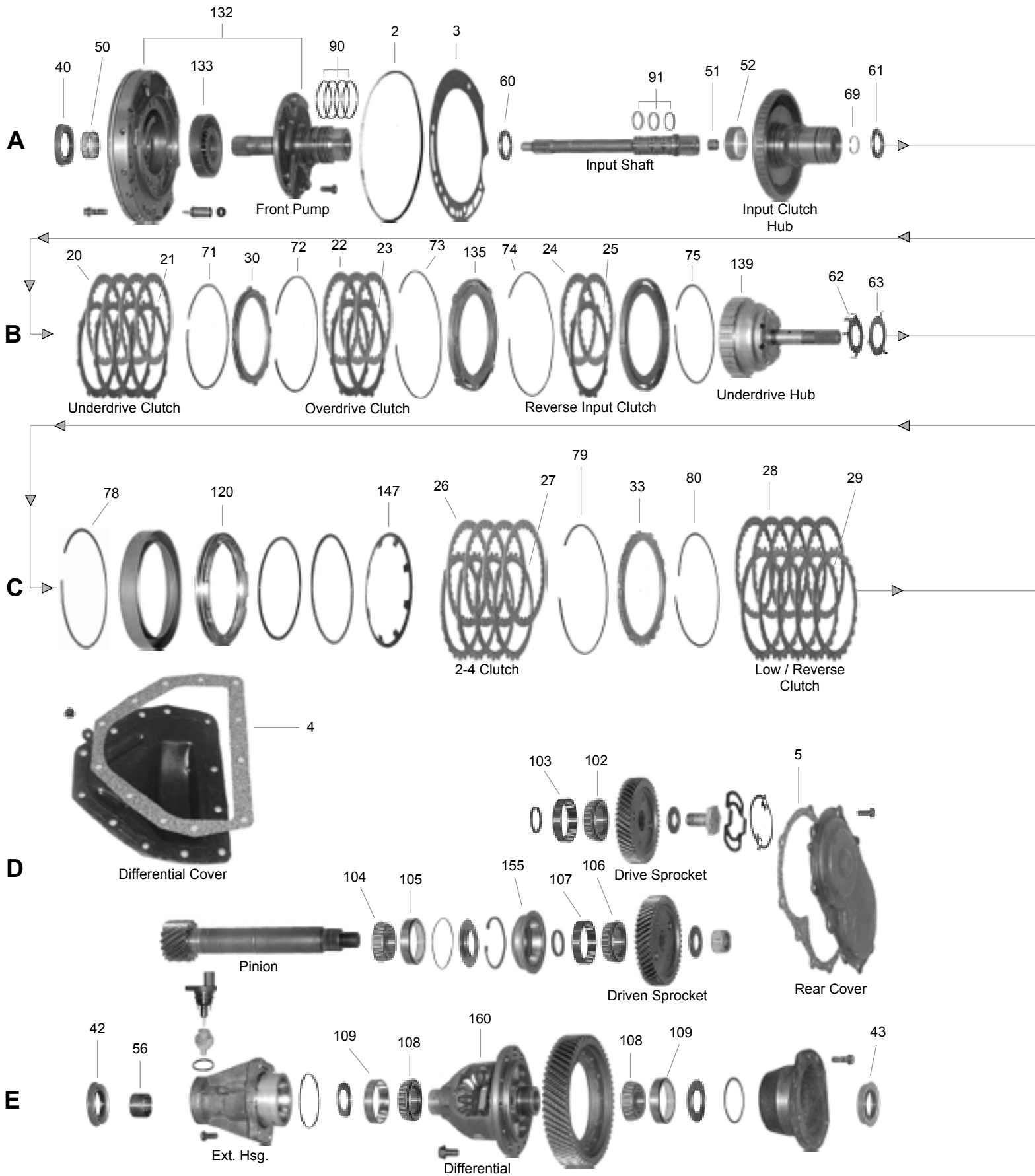

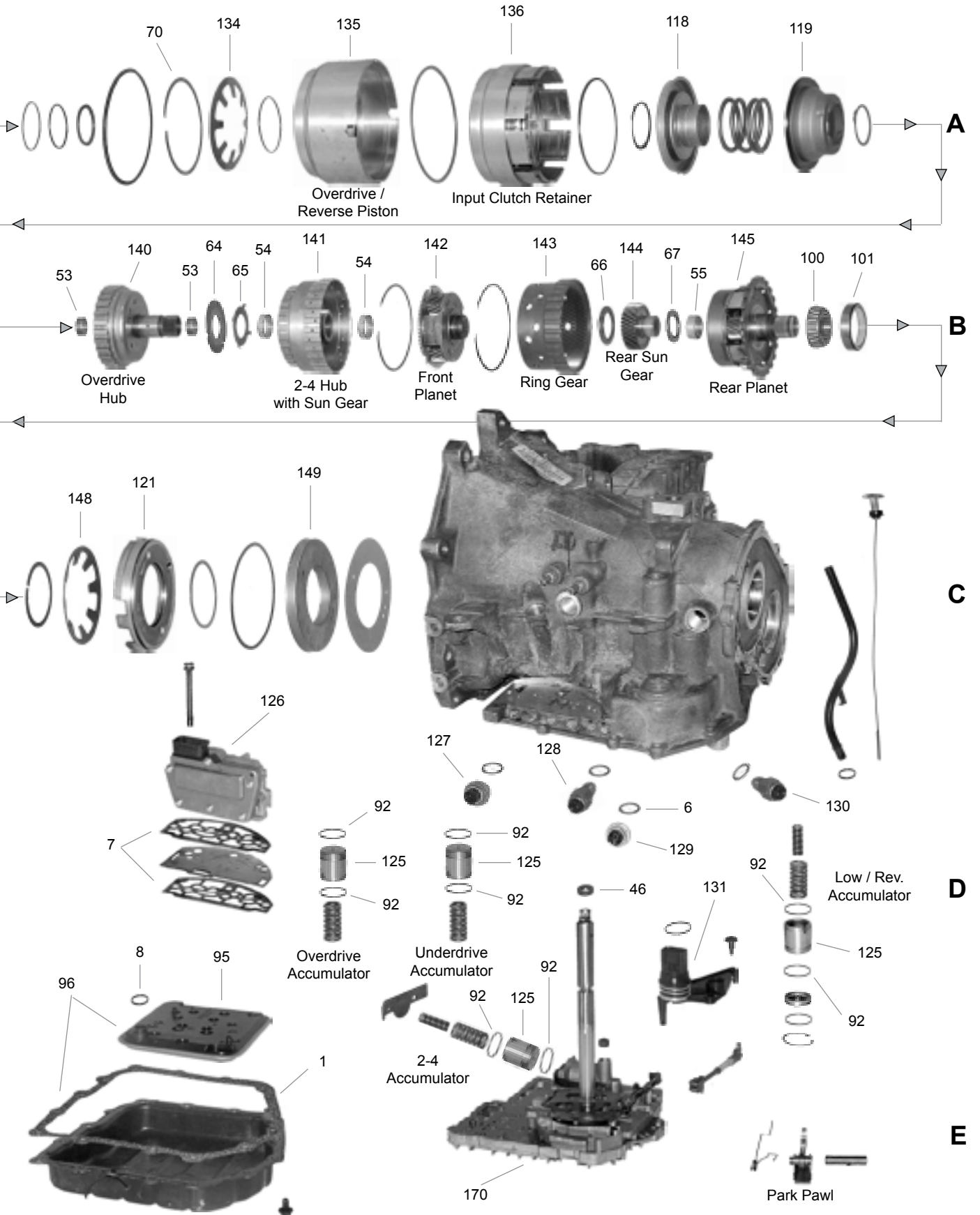

A604 Ultradrive (40TE/TES, 41TE/TES, 41AE)

ILL. NO.	PART NUMBER	PER CAR	DESCRIPTION	YEARS
	TMA604		Technical Manual	1989-On
	TMA604U		Technical Manual Update	1989-On
	TMA604DC		Technical Manual (Code Book, English)	1989-On
	TMA604DCS		Technical Manual (Code Book, Spanish)	1989-On
REBUILDER BOX KITS				
---	MRK3200-S¹		Master Rebuilder Kit (w/o Steels)	1989
---	MRK3200A-S¹		Master Rebuilder Kit (w/o Steels)	1990-03
---	MRK3200B-S¹		Master Rebuilder Kit (w/o Steels) High Energy Frictions	1990-03
---	MRK3200J-S^{1,2,3}		Master Rebuilder Kit (w/o Steels) High Energy Frictions	2004-On
---	K3200-S¹		Master Kit (w/o Steels)	1989
---	K3200A-S¹		Master Kit (w/o Steels)	1990-03
---	K3200B-S¹		Master Kit (w/o Steels) High Energy Frictions	1990-03
---	K3200J-S^{1,2,3}		Master Kit (w/o Steels) High Energy Frictions	2004-On
Steel Plate Sub Kits:				
---	K3200-9		Steel Plate Kit	1989
---	K3200A-9		Steel Plate Kit	1990-On
OVERHAUL KITS, GASKET SETS AND SEAL KITS				
---	K32900¹		Overhaul Kit	1989-03
---	K32900J^{1,2,3}		Overhaul Kit	2004-On
---	K32900-1¹		Gasket & Rubber Kit Duraprene	1989-03
---	K32900J-1^{1,2,3}		Gasket & Rubber Kit Duraprene	2004-On
---	K32900-8		External Seal-up Kit Duraprene	1989-On
---	K32900-7		Front Pump Seal-up Kit	1989-On
<p>¹ A Duraprene pan gasket will be the only gasket supplied in the kits.</p> <p>² 2004-On units utilize molded rubber L/R, 2-4, Accumulator Pistons and L/R Accumulator Cover, please order K32900J-4 for 40TE or K32900JT-4 for 41TE/AE separately.</p> <p>³ For 2007-On Avenger and Sebring, please order 32526T Pump Seal Separately..</p>				
GASKET AND RUBBER COMPONENTS				
1E	32170	1	Pan Gasket Duraprene	1989-On
2A	48100	1	Oil Pump Housing Seal	1989-On
3A	32101	1	Oil Pump Housing Gasket	1989-On
---	3601SL	5	Pump Washers	1989-On
4D	32176	1	Differential Cover Gasket Duraprene	1989-On
5D	32175	1	End Cover Gasket Duraprene	1989-On
6D	2627W	1	Neutral Safety Switch Washer Seal	1989-On
7D	32115	2	Solenoid Gasket For Early Design Solenoid	1989-98
7D	32115H	1	Solenoid Gasket For Late Design Solenoid	1999-On
8D	3410L	1	Filter O'Ring	1989-On
---	37140A	AR	Valve Body Check Ball Plastic - 1/4"	1989-On
---	22142	1	Shifter Cable Rod Grommet	1989-On
CLUTCH PLATES				
20A	32308	4	Underdrive Friction 28T, .071" - 5.433" O.D.	1989-On
20A	32308HE*	4	Underdrive Friction (High Energy) 28T, .071" - 5.433" O.D.	1989-On
21A	32309	4	Underdrive Steel 8T, .067" - 4.527" I.D.	1989-On
22B	32310	3	Overdrive Friction 28T, .086" - 5.433" O.D.	1989
22B	32308	4	Overdrive Friction 28T, .071" - 5.433" O.D.	1990-On
22B	32308HE*	3-4	Overdrive Friction (High Energy) 28T, .071" - 5.433" O.D.	1990-On
23B	32311	2	Overdrive Steel 8T, .096" - 4.527" I.D.	1989
23B	32309	3	Overdrive Steel 8T, .067" - 4.527" I.D.	1990-On
24B	32308	2	Reverse Input Friction 28T, .071" - 5.433" O.D.	1989-On
24B	32308HE*	2	Reverse Input Friction (High Energy) 28T, .071" - 5.433" O.D.	1989-On

A604 Ultradrive (40TE/TES, 41TE/TES, 41AE)

ILL. NO.	PART NUMBER	PER CAR	DESCRIPTION	YEARS
CLUTCH PLATES - Cont'd.				
25B	32309	1	Reverse Input Steel 8T, .067" - 4.527" I.D.	1989-On
26C	32304	4	2-4 Friction 32T, .086" - 6.063" O.D.	1989-On
26C	32304HE*	3-4	2-4 Friction (High Energy) 32T, .086" - 6.063" O.D.	1989-On
27C	32305	4	2-4 Steel 14T, .100" - 5.256" I.D.	1989-On
28C	32321	5	Low/Reverse Friction 32T, .072" - 6.063" O.D.	1989-On
28C	32321HE*	4-5	Low/Reverse Friction (High Energy) 32T, .072" - 6.063" O.D.	1989-On
29C	32322	5	Low /Reverse Steel 14T, .067" - 5.256" I.D.	1989-On
* Warning: Do not use sanded or tumbled steel plates with high energy frictions!!				
PRESSURE PLATES				
30B	K32312	1	Under/Overdrive Reaction Plate275" w/.075" Snap Ring/32254B	1990-96
30B	K32312A	1	Under/Overdrive Reaction Plate256" w/.075" Snap Ring/32254B	1990-96
30B	K32312B	1	Under/Overdrive Reaction Plate236" w/.075" Snap Ring/32254B	1990-96
30B	K32312C	1	Under/Overdrive Reaction Plate217" w/.075" Snap Ring/32254B	1990-96
30B	K32312HA	1	Under/Overdrive Reaction Plate224" w/.090" Snap Ring/32254H	1997-On
30B	K32312HB	1	Under/Overdrive Reaction Plate244" w/.090" Snap Ring/32254H	1997-On
30B	K32312HC	1	Under/Overdrive Reaction Plate265" w/.090" Snap Ring/32254H	1997-On
33C	K32313J³	1	Low/Reverse & 2-4 Reaction Plate207" - .217"	1989-On
33C	K32313JB³	1	Low/Reverse & 2-4 Reaction Plate227" - .237"	1989-On
33C	K32313JD³	1	Low/Reverse & 2-4 Reaction Plate247" - .257"	1989-On
33C	K32313JF³	1	Low/Reverse & 2-4 Reaction Plate267" - .277"	1989-On
³ This 2nd design kit, with a recessed pressure plate and thicker snap ring, retrofits all early designs.				
METAL CLAD SEALS				
40A	12575	1	Converter Hub333" Case	1989-On
40A	32526T	1	Converter Hub244" Case	2007-On
42E	48551	1	Extension Housing	1989-On
42E	48549	1	Extension Housing Use w/Milestone Bushing	1989-On
43E	48551	1	Differential Bearing Retainer	1989-On
---	32553	2	Transfer Case Input/Bearing Retainer All Wheel Drive	1991-On
---	32554	1	Transfer Case Axle/Half Shaft All Wheel Drive	1991-On
46D	32507	1	Manual Lever Seal	1989-On
BUSHINGS				
---	K32980	1	Bushing Assortment Kit (* Not Included)	1989-On
50A	12502*	1	Front Pump Bronze	1989-On
50A	12502A	1	Front Pump Babbitt	1989-On
50A	12502W*	1	Front Pump Sonnax, Tighter Tolerance	1989-On
51A	32002	1	Input Shaft595" O.D.	1989-On
51A	32002N*	1	Input Shaft608" O.D.	2001-On
52A	32004	1	Input Clutch Hub 1.907" O.D.	1989-On
52A	32004W*	1	Input Clutch Hub 1.907" O.D., Sonnax Tighter Tolerance, Use w/K32912W ..	1989-On
53B	32003	2	Overdrive Clutch Hub O/D Hub I.D. .9590"	1989-95
53B	32003W*	1	Overdrive Clutch Hub (1-piece) O/D Hub I.D. .9590"	1989-95
53B	32003G⁴	2	Overdrive Clutch Hub O/D Hub I.D. .9370"	1996-On
53B	32003GW*⁴	1	Overdrive Clutch Hub (1-piece) O/D Hub I.D. .9370"	1996-On
53B	32003HW*⁴	1	Overdrive Clutch Hub (1-piece) O/D Hub I.D. .9410"	1996-On
54B	32006	2	2nd & 4th Clutch Hub 1.155" I.D.	1989-95
54B	32006G⁴	2	2nd & 4th Clutch Hub 1.171" I.D.	1996-On
55B	32009	1	Rear Planetary Pinion Carrier 1.225" O.D.	1989-On
56E	48008	1	Extension Housing Not Used on All Models	1989-90
⁴ These may be found in early units.				

A604 Ultradrive (40TE, 41TE/TES, 41AE) - Cont'd.

ILL. NO.	PART NUMBER	PER CAR	DESCRIPTION	YEARS
THRUST WASHERS AND BEARINGS				
---	K32941L	1	Thrust Washer and Bearing Kit No Selectives	1989-On
60A	32420	1	Stator Shaft to Input Clutch Bearing	1989-On
61A	32421	1	Input Clutch Hub to Underdrive Hub Bearing	1989-On
62B	32400	1	Underdrive Hub to Overdrive Hub 5 Tabs	1989-On
63B	32450	1	Thrust Plate (O/D Hub to Underdrive Hub) 3 Tabs	1989-On
64B	32409	1	O/D Clutch Hub Thrust Plate035"	1989-On
64B	32409A	1	O/D Clutch Hub Thrust Plate053"	1989-On
64B	32409B	1	O/D Clutch Hub Thrust Plate069"	1989-On
64B	32409C	1	O/D Clutch Hub Thrust Plate079"	1989-On
64B	32409D	1	O/D Clutch Hub Thrust Plate089"	1989-On
64B	32409E	1	O/D Clutch Hub Thrust Plate098"	1989-On
64B	32409F	1	O/D Clutch Hub Thrust Plate107"	1989-On
64B	32409G	1	O/D Clutch Hub Thrust Plate115"	1989-On
64B	32409H	1	O/D Clutch Hub Thrust Plate127"	1989-On
65B	32402	1	Overdrive Hub to 2-4 Hub 4 Tabs	1989-On
66B	32422	1	2-4 Hub to Rear Sun Gear Bearing	1989-On
67B	32421	1	Rear Sun Gear to Rear Planetary Bearing	1989-On
---	K32440	AR	Transfer & Output Gear Shim Kit Ten - .005" Shims	1989-On
---	K48441	AR	Differential Shim Kit Ten - .005" Shims	1989-2/95
---	K48441C	AR	Differential Shim Kit (Matches 48433C) Ten - .005" Shims	3/95-On
SNAP RINGS				
---	K32289C	1	Snap Ring Kit Complete	1989-On
69A	32258	1	Input Shaft Retaining	1989-On
70A	32256	1	Reverse & Overdrive Belleville Retaining	1989-On
71B	32255	1	Under/Overdrive Reaction Plate Flat - .060"	1989-96
71B	32255H	1	Under/Overdrive Reaction Plate Flat - .075"	1997-On
72B	32254	1	Under/Overdrive Reaction Plate Taper - .070"	1989
72B	32254B	1	Under/Overdrive Reaction Plate Taper - .075"	1993-96
72B	32254H	1	Under/Overdrive Reaction Plate Taper - .090"	1997-On
73B	32253W	1	O/D-Reverse Pressure Plate Waved	1989-On
74B	32253	1	O/D-Reverse Pressure Plate Flat	1989-On
75B	32250	1	Reverse Pressure Plate Flat - .060"	1989-On
75B	32250A	1	Reverse Pressure Plate Flat - .070"	1989-On
75B	32250B	1	Reverse Pressure Plate Flat - .080"	1989-On
75B	32250C	1	Reverse Pressure Plate Flat - .090"	1989-On
78C	32257	1	2-4 Housing Retainer	1989-On
79C	32251A	1	Low/Reverse Pressure Plate Taper - .068"	1989-97
79C	32251J	1	Low/Reverse Pressure Plate Taper - .075"	1998-On
80C	32251	1	Low/Reverse Pressure Plate Flat	1989-On
SEALING RINGS				
---	K32901	1	Sealing Ring Kit	1989-On
90A	32200	3-4	Reaction Shaft Support Seal Plated	1989-On
91A	32201T	3	Input Shaft Teflon	1989-On
92D	32202T	8	Accumulator Teflon	1989-03

A604 Ultradrive (40TE, 41TE/TES, 41AE) - Cont'd.

ILL. NO.	PART NUMBER	PER CAR	DESCRIPTION	YEARS
TRANSMISSION OIL FILTERS				
95E	32600	1	Oil Filter (w/Round Locators)	1989-On
96E	ATK-99	1	Oil Filter Kit	1989-On
---	K32900-2	1	Solenoid Screens and Gasket Set For Early Design Solenoid	1989-9/98
---	K32900H-2	1	Solenoid Screens and Gasket Set For Late Design Solenoid	10/98-On
---	32610*	1	Low/Reverse Piston Screen	1989-On
---	32611*	1	Solenoid Screen	1989-9/98
---	32612*	1	Regulator Valve Screen In the Valve Body	1989-On
---	32614*	1	O/D Piston Screen	1989-On
* Please See Page 3.14-8 for Visual Identification.				
DIFFERENTIAL BEARINGS AND RACES				
---	K32434	1	Differential Bearing Kit Except All Wheel Drive	1989-2/95
---	K32434A	1	Differential Bearing Kit Except All Wheel Drive	3/95-On
---	K32434C	1	Differential Bearing Kit All Wheel Drive	1991-2/95
---	K32434D	1	Differential Bearing Kit All Wheel Drive	3/95-On
100B	48432	1	Output Shaft (Rear Planet) Bearing (Cone).....	1989-On
101B	48433	1	Output Shaft (Rear Planet) Bearing Race (Cup)	1989-On
102D	32430	1	Output Shaft Gear Bearing (Cone)	1989-On
103D	32431	1	Output Shaft Gear Bearing Race (Cup).....	1989-On
104D	32432	1	Transfer Shaft Bearing (Cone)	1989-On
105D	32433	1	Transfer Shaft Bearing Race (Cup)	1989-On
106D	32436	1	Transfer Shaft Gear Bearing (Cone)	1989-On
107D	32437	1	Transfer Shaft Gear Bearing Race (Cup)	1989-On
108E	48432	1	Differential Bearing (Cone) Left - 36mm I.D.	1989-2/95
108E	48432C	1	Differential Bearing (Cone) Left - 41mm I.D.	3/95-On
108E	48432	1	Differential Bearing (Cone) Right - 36mm I.D.	1989-On
108E	48432D	1	Differential Bearing (Cone) Right - AWD - 46mm O.D.	1991-On
109E	48433	1	Differential Bearing Race (Cup)..... Left - 63mm O.D.	1989-2/95
109E	48433C	1	Differential Bearing Race(Cup)..... Left - 73mm O.D.	3/95-On
109E	48433	1	Differential Bearing Race (Cup)..... Right - 63mm O.D.	1989-On
109E	K48433D	1	Differential Bearing Race (Cup, w/retaining plate) Right - AWD	1991-On
PISTONS				
---	K32900J-4	1	Molded Rubber Piston Kit (* Included) 40TE/TES	2004-On
---	K32900JT-4	1	Molded Rubber Piston Kit (+ Included) 41TE/TES/AE	2004-On
118A	32843	1	Underdrive Clutch Piston (Metal, .550" Tall) . Except 40T/TES	1989-On
118A	32843J	1	Underdrive Clutch Piston (Metal, .700" Tall) 40TE/TES	2003-On
119A	32847*	1	Underdrive Piston Spring Retainer (Bonded Rubber)	1989-On
120C	32842J*	1	2-4 Clutch Piston (Molded Rubber, .846" Tall) ... 40TE/TES	2004-On
120C	32842JA+	1	2-4 Clutch Piston (Molded Rubber, .670" Tall) 41TE/TES/AE	2004-On
121C	32840J*	1	Low/Reverse Clutch Piston (Molded Rubber, 1.205" Tall - 40TE)	2004-On
121C	32840T+	1	Low/Reverse Clutch Piston (Molded Rubber, 1.000" Tall - 41TE/TES/AE)	2004-On
---	32783J*+	1	Low/Reverse Accumulator Piston Cover All, Retrofits to 1989	2004-On
125D	32782J	1-4	Accumulator Piston (Molded Rubber) <i>Factory Discontinued</i>	2004-On
125D	32782	1	2-4 Accumulator Piston Metal, Replaces All Plastic Versions	1989-On
125D	K32780 ⁵	1-4	Accumulator Bore Sleeve and Piston Kit Sonnax	1989-On
⁵ It will fit all four accumulator location and salvages worn cases and valve bodies.				

A604 Ultradrive (40TE, 41TE/TES, 41AE) - Cont'd.

ILL. NO.	PART NUMBER	PER CAR	DESCRIPTION	YEARS	
SHIFT ENHANCEMENTS, VALVES AND MISCELLANEOUS					
---	K32943	1	SK604 Jr. No Limp Kit TransGo	1989-On	
---	SC-41TE	1	Sure Cure Kit Sonnax	1989-On	
---	K32840W	1	Low/Reverse Retainer Kit (Sonnax, Plate and Grommet, Prevents Codes 24, 41, 60)	1989-On	
---	32889	1	Boost Valve Bushing (Prevents High Line Pressure Instability)	1989-On	
---	K32887 ⁶	1	Converter Regulator Valve Kit Sonnax	1989-On	
⁶ This kit addresses high converter pressure which is responsible for converter shudder, friction failure, cooler restriction, and ultimately, geartrain failure.					
---	32898W	1	Pressure Regulator Valve (Oversized, Non-TES Models, Use w/K32598W Reamer)	1989-06	
---	32898TES	1	Pressure Regulator Valve (Oversized, TES Models, Use w/K32598TES Reamer)	2007-On	
---	32886VP ⁷	1	Solenoid Switch Valve Plugs (Non-TES Models) . Sonnax	1989-06	
---	32886VPL ⁷	1	Solenoid Switch Valve Plugs (Oversized, Non-TES Models, Use w/32586L Reamer)	1989-06	
---	32886TES ⁷	1	Solenoid Switch Valve Plugs (Oversized, TES Models, Use w/32586TES Reamer) ..	2007-On	
⁷ Prevents Plugs from Cocking, Which Causes Erratic TCC Operation and Codes.					
---	32885W	1	Solenoid Switch Valve (Oversized, Non-TES Models, Use w/32585W Reamer)	1989-06	
---	32885TES	1	Solenoid Switch Valve (Oversized, TES Models, Use w/32585TES Reamer)	2007-On	
---	32881B	1	Cooler Bypass Plug (OEM)	1991-On	
---	K32881E	1	Cooler Bypass Plug (Directs All Oil Through the Cooler, Eliminates TCC Slip/Overheat)	1994-On	
---	K48995A	1	Axle Stabilizer Bushing (Narrow) Passenger Side	1989-On	
---	K48995B	1	Axle Stabilizer <i>Bearing</i>	Both Sides	1989-On
ELECTRONIC COMPONENTS					
Note : When ordering a Solenoid Body, please add the suffix (-R) for a Remanufactured Unit, if Desired.					
126D	32879H ⁸	1	Shift Solenoid and Switch Assembly Late Design - 7 Bolt Cover	1989-On	
---	K32900-2	1	Solenoid Screens and Gasket Set For Early Design Solenoid	1989-9/98	
---	K32900H-2	1	Solenoid Screens and Gasket Set For Late Design Solenoid	10/98-On	
---	K32900-2W	1	Solenoid Pack Repair Kit (Sonnax, Three Diaphragms and Contacts)	1989-On	
---	32859VC	1	Solenoid Body Connector Repair Kit Renews Harness Side	1989-On	
⁸ Late design solenoid (1999-On) will retrofit to early units; just discard the sound shield, plate and gaskets. Install the new solenoid and gasket supplied.					
---	32879JC	1	Variable Force Solenoid (TES Models)	2007-On	
---	32878JC	1	Pressure Transducer Sensor (TES Models)	2007-On	
---	32869JC	1	Internal Wiring Harness (TES Models)	2007-On	
127D	32875	1	Input Speed Sensor (TISS) Fine Thread	1989-On	
128D	32876	1	Output Speed Sensor (TOSS) Coarse Thread	1989-On	
---	32855VC	1	Speed Sensor Connector Repair Kit Renews Vehicle Harness Side	1989-On	
129D	K2627C	1	Neutral Safety Switch (Fine Thread) External	1989	
129D	32878A	1	Neutral Safety Switch (Fine Thread) External	1990-96	
130D	32877	1	PRNDL Switch (Coarse Thread) External	1989	
130D	32877A	1	PRNDL Switch (Coarse Thread) External	1990-96	
131D	32877G ⁹	1	Transmission Range Sensor Internal (Round Pin)	1996-9/98	
131D	32877H ⁹	1	Transmission Range Sensor Internal (Spade Pin)	10/98-On	
---	32857VC	1	NSS and PRNDL Connector Repair Kit (Renews Vehicle Harness Side)	1989-96	
---	32857HVC	1	Transmission Range Sensor Connector Repair Kit (Spade Pin Sensor)	10/98-On	
⁹ Replaces the Neutral Safety Switch and the PRNDL Switch.					
HARD PARTS AND MISCELLANEOUS					
Note : When ordering Hard Parts, please add the appropriate suffix : (-R) Reman, (-U) Used, (-A) Aftermarket.					
132A	K32895	1	Pump Assembly (4-Ring Stator Style - 25-Tooth Inner Gear)	1990-00	
132A	K32895H	1	Pump Assembly (Dual Cycloidal w/12-Tooth Inner Gear)	2000-06	
132A	K32895JC	1	Pump Assembly (TES Models, Shorter Stator)	2007-On	
133A	K32965	1	Pump Gears (25-Tooth Inner Gear - .708" Thick)	1989-00	
133A	K32965H	1	Pump Gears (12-Tooth Inner Gear - .495" Thick)	2000-On	
134A	32764	1	Reverse/Overdrive Belleville Spring	1989-On	

A604 Ultradrive (40TE, 41TE/TES, 41AE) - Cont'd.

ILL. NO.	PART NUMBER	PER CAR	DESCRIPTION	YEARS
HARD PARTS AND MISCELLANEOUS - Cont'd.				
Note : When ordering Hard Parts, please add the appropriate suffix : (-R) Reman, (-U) Used, (-A) Aftermarket.				
135A	32801	1	Overdrive/Reverse Piston (4-Lug)	L/90-On
135A/B	K32801	1	Overdrive/Reverse Piston and Pressure Plate (4-Lug)	1989-On
136A	K32844H ¹⁰	1	Updated Input Clutch Retainer Package	1989-On
			¹⁰ Includes Two Selective Plates (.224" & .244") and Two Snap Rings (32254H & 32255H)	
136A	32844H	1	Updated Input Clutch Retainer Use w/32255H, 32254H Snap Rings	1997-On
139B	32803	1	Underdrive Hub (Solid Shaft)	1989-On
140B	32804	1	Overdrive Hub (29mm)	1989-95
140B	32804G	1	Overdrive Hub (29.5mm)	1996-On
140/1B	K32863 ¹¹	1	2-4 Hub/Sun Gear and Overdrive Hub Upgrade Kit	1989-On
			¹¹ Kit includes ill. # 140B and 141B	
141B	32863	1	2-4 Hub and Sun Gear (29mm)	1989-95
141B	32863G	1	2-4 Hub and Sun Gear (29.5mm)	1996-On
---	K32835D ¹²	1	Geartrain Kit (6 Pieces w/Long Spline Rear Planetary)	1993-On
			¹² Kit includes: Both Planets, 2-4 Hub, O/D Hub, Rear Sun Gear and Rear Ring Gear.	
142B	32833	1	Front Planetary	1989-On
142B	K32833 ¹³	1	Front Planet, 2-4 Hub & Overdrive Hub Upgrade Kit	1989-On
			¹³ Kit includes ill. # 140D, 141D, & 142D	
143B	32864	1	Rear Ring Gear	1989-On
144B	32865	1	Rear Sun Gear	1989-On
145B	32831	1	Rear Planetary (Short, 1.000" Spline Area From the Base, 4-Pinion)	1989-92
145B	32831D	1	Rear Planetary (Long, 1.125" Spline Area From the Base, 4-Pinion)	1993-On
145B	32831HD	1	Rear Planetary (Long, 1.125" Spline Area From the Base, 5-Pinion)	1993-On
145B	K32831A ¹⁴	1	Rear Planetary Kit (49/47 Tooth Gear Set -2.52 Overall Gear Ratio Only, 4-Pinion) ...	1992-On
			¹⁴ Also fits 1991 Caravan and Voyager with All Wheel Drive	
			Includes: Rear Planetary, Rear Ring Gear, Output Gear, Transfer Shaft Gear, and Cover.	
147C	32762	1	2-4 Belleville Spring	1989-On
148C	32760	1	Low/Reverse Belleville Spring	1989-03
148C	32760J	1	Low/Reverse Belleville Spring (use w/Bonded Piston)	2004-On
149C	32837	1	Low/Reverse Clutch Piston Retainer (w/4 Holes)	1989-03
149C	32837J	1	Low/Reverse Clutch Piston Retainer (w/5 Holes -Bleed Hole)	L/03-On
155D	32838	1	Transfer Gear Bearing Retainer	1989-On
---	K32882	1	Differential Pinion Shaft Retainer Kit (TransGo)	1989-On
---	ST32882	1	Differential and Case Saver (Superior) ... Fits .661" Pinion Shaft	1989-On
---	ST32882A	1	Differential and Case Saver (Superior) ... Fits .735" Pinion Shaft	1989-On
160E	32861F	1	Differential (Large O.D. Bearing Style)	3/95-On
---	K48969A ¹⁵	1	Differential Spider Gear Set 12 Bolt	1989-On
			¹⁵ Includes Differential Side and Pinion Gears, Thrust Washers, Roll Pin and Cross Shaft.	
170E	10-128	1	Valve Body (Reman) Fits Units w/External MLPS	1989-96
170E	10-129	1	Valve Body (Reman) Fits Units w/Internal MLPS - Round Pin	1996-9/98
170E	10-130	1	Valve Body (Reman) Fits Units w/Internal MLPS - Spade Pin	10/98-06
170E	10-130A	1	Valve Body (Reman) Fits Units w/Variable Force Solenoid (TES Models)	2007-On
TOOLS				
---	T1420K	1	O/D and Reverse Reaction Plate Spring Compressor Kit	1989-On
---	T1430	1	Input Clutch Outer Lip Seal Installer/Protector	1989-On
---	T1432	1	Output Shaft/Rear Planetary Bearing Remover	1989-On
---	T1435	1	Transfer Shaft Bearing Snap Ring Remover/Installer	1989-On
---	T1437	1	2-4 Spring Compressor Kit	1989-On
---	T1445	1	Output Gear and Transfer Gear Bearing Remover	1989-On
---	T1455	1	Differential Bearing Remover	1989-On
---	K32912W	1	Bushing Installation Tool for 32004W	1989-On

A604