

# Toyota A540 / A541

FWD 4 Speed

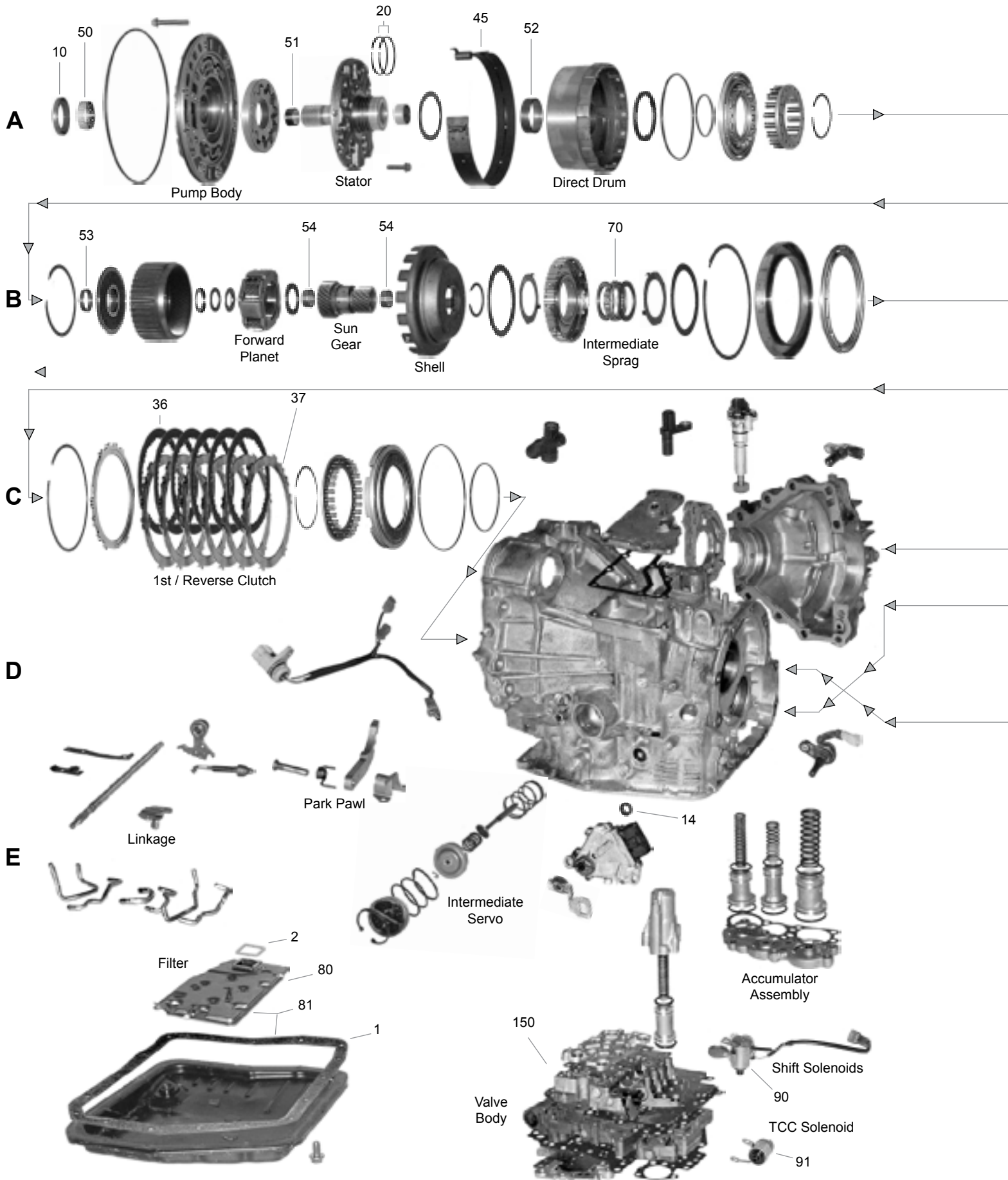

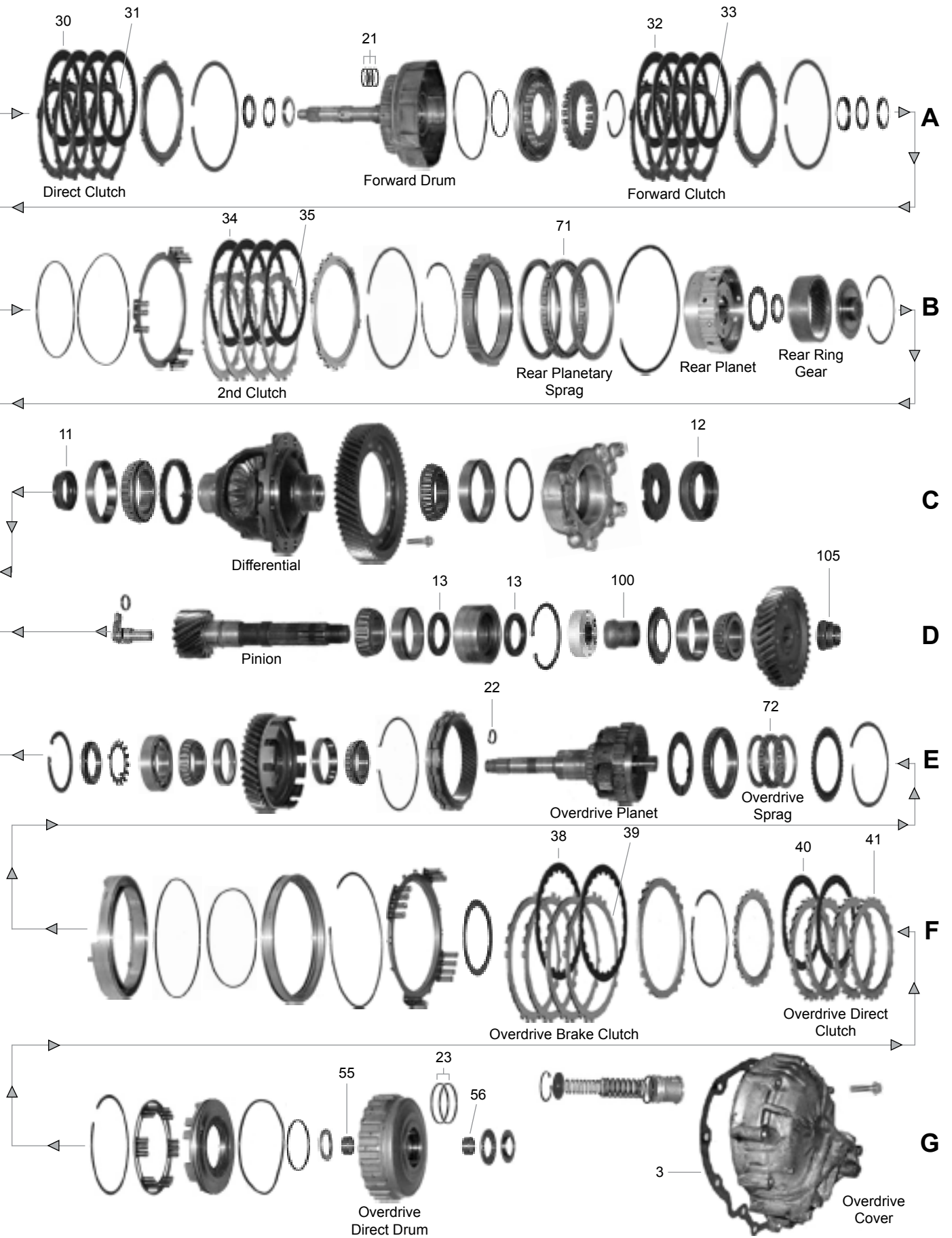

# Toyota A540E/H, A541E (FWD 4-Speed)

VEHICLE MODEL	YEARS	ENGINE	TRANS. TYPE
Avalon .....	1995-04 .....	V6 (3.0 Litre DOHC) .....	<b>A541E</b>
Camry .....	1988-91 .....	V6 (2.5 Litre) .....	<b>A540E</b>
	1992-93 .....	V6 (3.0 Litre) .....	<b>A540E</b>
	1994-01 .....	V6 (3.0 Litre DOHC) .....	<b>A541E</b>
Camry (AWD) .....	1989-91 .....	4 Cylinder .....	<b>A540H</b>
RAV4 (AWD) .....	1996-00 .....	4 Cylinder .....	<b>A540H</b>
Sienna .....	1998-00 .....	6 Cylinder .....	<b>A540E</b>
	2001-03 .....	6 Cylinder .....	<b>A541E</b>
Solara .....	1998-03 .....	6 Cylinder .....	<b>A541E</b>
ES250 .....	1989-91 .....	V6 (2.5 Litre) .....	<b>A540E</b>
ES300 .....	1992-93 .....	V6 (3.0 Litre DOHC) .....	<b>A540E</b>
	1994-01 .....	V6 (3.0 Litre DOHC) .....	<b>A541E</b>

ILL. NO.	PART NUMBER	PER CAR	DESCRIPTION	YEARS
----------	-------------	---------	-------------	-------

## MASTER BOX KITS

---	<b>K8300-S<sup>1</sup></b>		Master Kit (w/o Steels) .....	<b>A540E/H</b> .....	1988-91
---	<b>K8300A-S</b>		Master Kit (w/o Steels) .....	<b>A540E</b> .....	1992-00
---	<b>K8300C-S</b>		Master Kit (w/o Steels) .....	<b>A541E</b> .....	1994-04
---	<b>K8300E-S<sup>1</sup></b>		Master Kit (w/o Steels) .....	<b>A540H - RAV4</b> .....	1996-00
---	<b>K8300T-S</b>		Master Kit (w/o Steels) .....	<b>A540H - Transfer Case Section</b> .....	1989-00
---	<b>K8300-9<sup>1</sup></b>		Steel Plate Kit .....	<b>A540E/H</b> .....	1988-91
---	<b>K8300A-9</b>		Steel Plate Kit .....	<b>A540E</b> .....	1992-00
---	<b>K8300C-9</b>		Steel Plate Kit .....	<b>A541E</b> .....	1994-5/97
---	<b>K8300F-9</b>		Steel Plate Kit .....	<b>A541E</b> .....	6/97-04
---	<b>K8300E-9<sup>1</sup></b>		Steel Plate Kit .....	<b>A540H - RAV4</b> .....	1996-00
---	<b>K8300T-9</b>		Steel Plate Kit .....	<b>A540H - Transfer Case Section</b> .....	1989-00

<sup>1</sup> Kits do not include parts for Transfer Case sections on AWD units, please order these separately.

## OVERHAUL KITS, GASKET SETS AND GASKETS

---	<b>K83900</b>	1	Overhaul Kit ( <b>Transmission Section</b> ) .....	<b>A540E/H</b> .....	1988-00
---	<b>K83900C</b>	1	Overhaul Kit ( <b>Transmission Section</b> ) .....	<b>A541E</b> .....	1994-04
---	<b>K83900T</b>	1	Overhaul Kit ( <b>Transfer Case Section</b> ) .....	<b>A540H</b> .....	1989-00
1E	<b>83170</b>	1	Oil Pan Gasket .....	<b>Duraprene - A540E/H</b> .....	1988-00
1E	<b>83170C</b>	1	Oil Pan Gasket .....	<b>Duraprene - A541E</b> .....	1994-04
2E	<b>83120</b>	1	Oil Filter Gasket .....	<b>A540E/H</b> .....	1988-00
2E	<b>83120C</b>	1	Oil Filter Gasket .....	<b>A541E</b> .....	1994-04
---	<b>81100</b>	1	Pump O'Ring .....	<b>A540E/H</b> .....	1988-00
---	<b>83100C</b>	1	Pump O'Ring .....	<b>A541E</b> .....	1994-04
3G	<b>83110</b>	1	O/D Cover Gasket .....	<b>A540E/H</b> .....	1988-00
3G	<b>83110C</b>	1	O/D Cover Gasket .....	<b>A541E</b> .....	1994-04

## METAL CLAD SEALS

10A	<b>67526A</b>	1	Front Pump .....	<b>All</b> .....	1988-04
11C	<b>83551</b>	1	Right Axle ( <b>40x56x9mm</b> ) .....	<b>All</b> .....	1988-04
12C	<b>83552A</b>	1	Left Axle ( <b>50x80x16.5mm</b> ) .....	<b>A540E / A541E</b> .....	1988-04
12C	<b>83552B</b>	1	Left Axle ( <b>AWD</b> ) .....	<b>A540H</b> .....	1989-00
---	<b>83553</b>	1	Extension Housing ( <b>AWD</b> ) .....	<b>A540H</b> .....	1989-00
13D	<b>83554</b>	2	Pinion .....		1988-04
14D	<b>68504</b>	1	Manual Lever .....		1988-04

## SEALING RINGS

---	<b>K83901</b>	1	Sealing Ring Kit .....	<b>A540E</b> .....	1988-93
---	<b>K83901C</b>	1	Sealing Ring Kit .....	<b>A541E</b> .....	1994-04
20A	<b>81200T</b>	2	Stator Shaft (Direct Clutch) .....	<b>Teflon</b> .....	1988-04
21A	<b>81201T</b>	3	Input Shaft (Forward Clutch) .....	<b>Teflon</b> .....	1988-04
22E	<b>81202T</b>	1	Intermediate Shaft .....	<b>Teflon</b> .....	1988-04
23G	<b>67205F</b>	2	Overdrive Clutch Drum .....	<b>Metal</b> .....	1988-04

# Toyota A540E/H, A541E (FWD 4-Speed)

Toyota A540

ILL. NO.	PART NUMBER	PER CAR	DESCRIPTION	YEARS
<b>CLUTCH PLATES</b>				
30A	<b>72306</b>	3	Direct Friction ..... <b>32T, .081"</b> - .....	1988-91
30A	<b>72302</b>	3	Direct Friction ..... <b>40T, .082"</b> - <b>5.180"</b> O.D. ....	1992-04
30A	<b>81304</b>	3	Direct Friction <b>(AWD)</b> ..... <b>40T, .068"</b> .....	1989-91
30A	<b>81304D</b>	3	Direct Friction <b>(AWD)</b> ..... <b>40T, .073"</b> .....	1996-00
31A	<b>72303</b>	2	Direct Steel ..... <b>6T, .091"</b> .....	1988-91
31A	<b>72303B</b>	1	Direct Steel ..... <b>6T, .071"</b> .....	1988-91
31A	<b>72303C</b>	1	Direct Steel ..... <b>6T, .055"</b> .....	1992-04
31A	<b>72303D</b>	2-3	Direct Steel ..... <b>6T, .079"</b> .....	1992-04
31A	<b>81305</b>	3-4	Direct Steel <b>(AWD)</b> ..... <b>8T, .068"</b> .....	1989-00
32A	<b>81304</b>	4	Forward Friction ..... <b>40T, .068"</b> .....	1988-04
32A	<b>83304</b>	5	Forward Friction ..... <b>40T, .060"</b> - <b>4.960"</b> O.D. ....	1992-04
33A	<b>81305</b>	4	Forward Steel ..... <b>8T, .068"</b> .....	1988-04
33A	<b>83305</b>	4	Forward Steel ..... <b>8T, .063"</b> - <b>4.133"</b> I.D. ....	1992-04
33A	<b>83305A</b>	1	Forward Steel ..... <b>8T, .055"</b> - <b>4.133"</b> I.D. ....	1992-04
33A	<b>72305</b>	5	Forward Steel ..... <b>8T, .079"</b> .....	6/97-04
34B	<b>83306</b>	3	2nd Friction <b>(Parallel Lining)</b> ..... <b>33T, .075"</b> - <b>5.629"</b> O.D. ....	1988-04
34B	<b>83306A</b>	3	2nd Friction <b>(Smooth Lining)</b> ..... <b>33T, .075"</b> - <b>5.629"</b> O.D. ....	1992-04
34B	<b>83306C</b>	4	2nd Friction ..... <b>36T, .075"</b> - <b>5.866"</b> O.D. ....	1994-04
35B	<b>83307</b>	3	2nd Steel ..... <b>12T, .071"</b> - <b>4.566"</b> I.D. ....	1988-04
35B	<b>83307C</b>	4	2nd Steel (Wide Tooth) ..... <b>10T, .071"</b> - <b>4.881"</b> I.D. ....	1994-04
35B	<b>81322A</b>	3	2nd Steel <b>(AWD)</b> ..... <b>12T, .072"</b> .....	1989-00
36C	<b>83321</b>	6-7	1st/Reverse Friction ..... <b>33T, .059"</b> - <b>5.590"</b> O.D. ....	1988-04
36C	<b>83321C</b>	6	1st/Reverse Friction ..... <b>36T, .059"</b> - <b>5.787"</b> O.D. ....	1994-04
37C	<b>81322</b>	6-7	1st/Reverse Steel ..... <b>12T, .068"</b> .....	1988-04
37C	<b>83322C</b>	6	1st/Reverse Steel ..... <b>10T, .063"</b> - <b>4.842"</b> I.D. ....	1994-04
38F	<b>83308A</b>	3	Overdrive Brake Friction ..... <b>24T, .081"</b> - <b>6.456"</b> O.D. ....	1988-04
38F	<b>81308</b>	3	Overdrive Brake Friction ..... <b>24T, .075"</b> .....	1994-04
39F	<b>83309</b>	3	Overdrive Brake Steel ..... <b>12T, .098"</b> - <b>5.629"</b> I.D. ....	1988-04
40F	<b>81304D</b>	2	Overdrive Direct Friction ..... <b>40T, .073"</b> .....	1988-04
41F	<b>81305D</b>	2	Overdrive Direct Steel ..... <b>20/24Teeth, .071"</b> .....	1988
41F	<b>83311</b>	2	Overdrive Direct Steel ..... <b>20/24Teeth, .118"</b> - <b>4.094"</b> I.D. ....	1989-04
41F	<b>83311C</b>	1	Overdrive Direct Steel ..... <b>24T, .071"</b> - <b>4.094"</b> I.D. ....	1994-04
41F	<b>83311E</b>	1	Overdrive Direct Steel ..... <b>24T, .141"</b> - <b>4.094"</b> I.D. ....	1994-04
---	<b>83323</b>	11	Differential Lock Friction ..... <b>36T, .071"</b> - <b>4.527"</b> O.D. ....	1989-04
---	<b>83324</b>	11	Differential Lock Steel ..... <b>30T, .063"</b> - <b>3.582"</b> I.D. ....	1989-04
<b>BANDS</b>				
45A	<b>83714</b>	1	2nd Coast Brake ..... <b>A540E/H</b> .....	1988-00
45A	<b>83714C</b>	1	2nd Coast Brake ..... <b>A541E</b> .....	1994-04
45A	<b>81714</b>	1	2nd Coast Brake ..... <b>A540H - RAV4</b> .....	1996-00
<b>BUSHINGS</b>				
---	<b>K83980</b>	1	Bushing Assortment Kit ..... <b>A540E / A541E</b> .....	1988-04
---	<b>K83980A</b>	1	Bushing Assortment Kit ..... <b>A540H</b> .....	1989-00
50A	<b>67005</b>	1	Front Pump ..... .....	1988-04
51A	<b>67002C</b>	1	Stator Support <b>(Front)</b> ..... .....	1988-04
---	<b>81001</b>	1	Stator Support <b>(Rear)</b> ..... <b>Some Models</b> .....	1988-04
52A	<b>81003</b>	1	Direct Drum ..... <b>A540H</b> .....	1989-00
52A	<b>83003</b>	1	Direct Drum ..... <b>A540E / A541E</b> .....	1988-04
53B	<b>81007</b>	1	Front Ring Gear Hub ..... <b>A540H</b> .....	1989-00
53B	<b>83007</b>	1	Front Ring Gear Hub ..... <b>A540E / A541E</b> .....	1988-04
54B	<b>81006</b>	2	Sun Gear ..... <b>A540H</b> .....	1989-00
54B	<b>83006</b>	2	Sun Gear ..... <b>A540E / A541E</b> .....	1988-04
55G	<b>81002</b>	1	O/D Sun Gear/Drum <b>(Front)</b> ..... .....	1988-04
56G	<b>81004</b>	1	O/D Sun Gear/Drum <b>(Rear)</b> ..... .....	1988-04

# Toyota A540E/H, A541E (FWD 4-Speed) - Cont'd.

ILL. NO.	PART NUMBER	PER CAR	DESCRIPTION	YEARS
<b>THRUST WASHERS</b>				
---	<b>K83940</b>	1	Thrust Washer Assortment Kit ..... <b>A540E/H</b> .....	1988-00
---	<b>K83940C</b>	1	Thrust Washer Assortment Kit ..... <b>A541E</b> .....	1994-04
---	<b>81400</b>	1	Pump Washer .....	1988-04
---	<b>83400C</b>	1	Front Planetary Washer ( <b>Rear, 3-Pin</b> ) ..... <b>A541E</b> .....	1994-04
---	<b>83401C</b>	1	Rear Planetary ( <b>Front, 3-Pin</b> ) ..... <b>A541E</b> .....	1994-04
---	<b>83402C</b>	1	Rear Planetary ( <b>Rear, 2-I.D. Tabs</b> ) ..... <b>A541E</b> .....	1994-04
<b>SPRAGS</b>				
70B	<b>83815</b>	1	Intermediate ( <b>B2</b> ) Clutch Sprag ..... <b>A540E/H</b> .....	1988-00
70B	<b>83815C</b>	1	Intermediate ( <b>B2</b> ) Clutch Sprag ..... <b>A541E</b> .....	1994-04
70B	<b>K83815C</b>	1	Intermediate ( <b>B2</b> ) Clutch Sprag w/Outer Race .... <b>A541E</b> .....	1994-04
71B	<b>81814A</b>	1	Rear Planetary Sprag ..... <b>20 Elements - A540E/H</b> .....	1988-00
71B	<b>83814</b>	1	Rear Planetary Sprag ..... <b>30 Elements - A540E/H</b> .....	1988-00
71B	<b>83814C</b>	1	Rear Planetary Sprag ..... <b>32 Elements - A541E</b> .....	1994-04
71B	<b>K83814C</b>	1	Rear Planetary Sprag w/Outer Race ..... <b>32 Elements - A541E</b> .....	1994-04
72E	<b>72813</b>	1	Overdrive Sprag ..... <b>All</b> .....	1988-04
<b>TRANSMISSION OIL FILTERS</b>				
80E	<b>83600</b> <sup>2</sup>	1	Oil Filter ..... <b>A540E/H</b> .....	1988-00
80E	<b>83600C</b> <sup>2</sup>	1	Oil Filter ..... <b>A541E</b> .....	1994-04
81E	<b>ATK-108</b>	1	Oil Filter Kit ..... <b>A540E/H</b> .....	1988-00
81E	<b>ATK-170</b>	1	Oil Filter Kit ..... <b>A541E</b> .....	1994-04
<sup>2</sup> Please See Filter Pictures on Page 13.11-1 for Visual Identification.				
<b>SHIFT ENHANCEMENTS</b>				
---	<b>ST83944</b> <sup>3</sup>	1	Valve Body Kit ( <b>Superior, Translab Version</b> ) ..... <b>A540E/H</b> .....	1988-93
<sup>3</sup> Addresses: Harsh Engagements, Soft Shifts, Poor Cooler Flow and O/D Failure.				
---	<b>K83889</b> <sup>4</sup>	1	Boost Sleeve Kit ( <b>Sonnax</b> ) ..... <b>Large Ratio, .482" - .583" Spools</b> .....	1988-04
<sup>4</sup> Addresses high and/or low line pressure.				
---	<b>K81989</b>	1	Oversized Pressure Regulator Valve Kit ( <b>A540 Only, Use w/K81589 Reamer Kit</b> ) .....	1988-00
---	<b>K83989</b>	1	Oversized Pressure Regulator Valve Kit ( <b>A540 w/540Y Stamped on Valve Body</b> ) .....	1988-00
---	<b>K81589</b>	1	Reamer Kit ( <b>For K81989 &amp; K83989 Pressure Regulator Valve Kit</b> ) .....	1988-00
---	<b>81886</b>	1	Accumulator Control Valve Sleeve .. <b>Usually Worn, Controls Shift Feel</b> .....	1988-04
<b>ELECTRICAL COMPONENTS</b>				
90E	<b>83871</b>	1	Shift Solenoid Assembly (1 & 2 / A & B) ..... <b>A540E/H</b> .....	1988-00
91E	<b>83870</b>	1	T.C.C. Solenoid (SL / E) ..... <b>A540E/H</b> .....	1988-00
---	<b>83871C</b>	1	Shift Solenoid Assembly (1 & 2 / A & B) ..... <b>A541E</b> .....	1994-04
---	<b>83873C</b>	1	SLN Solenoid (PWM Accumulator Solenoid) ..... <b>A541E</b> .....	1994-04
---	<b>83870C</b>	1	T.C.C. (SL / E) Solenoid ..... <b>A541E</b> .....	1994-04
<b>MISCELLANEOUS AND HARD PARTS</b>				
100D	<b>83880</b>	1	Crush Sleeve ..... <b>A540E/H</b> .....	1988-04
100D	<b>83880C</b>	1	Crush Sleeve ..... <b>A541E</b> .....	1994-04
105D	<b>83891</b>	1	Pinion Shaft Nut .....	1988-04
150G	<b>70-101</b>	1	Reman Valve Body ..... <b>A540E w/Three Solenoids, w/Tube</b> .....	1988-04
150G	<b>70-102</b>	1	Reman Valve Body ..... <b>A540E w/Three Solenoids, w/o Tube</b> .....	1988-04
150G	<b>70-102A</b>	1	Reman Valve Body ..... <b>Sienna w/Casting A540Y</b> .....	1998-00
150G	<b>70-103</b>	1	Reman Valve Body ..... <b>A540H w/Four Solenoids</b> .....	1988-04