

# Hyundai A4AF1/2/3 & A4BF1/2/3

FWD 4 Speed

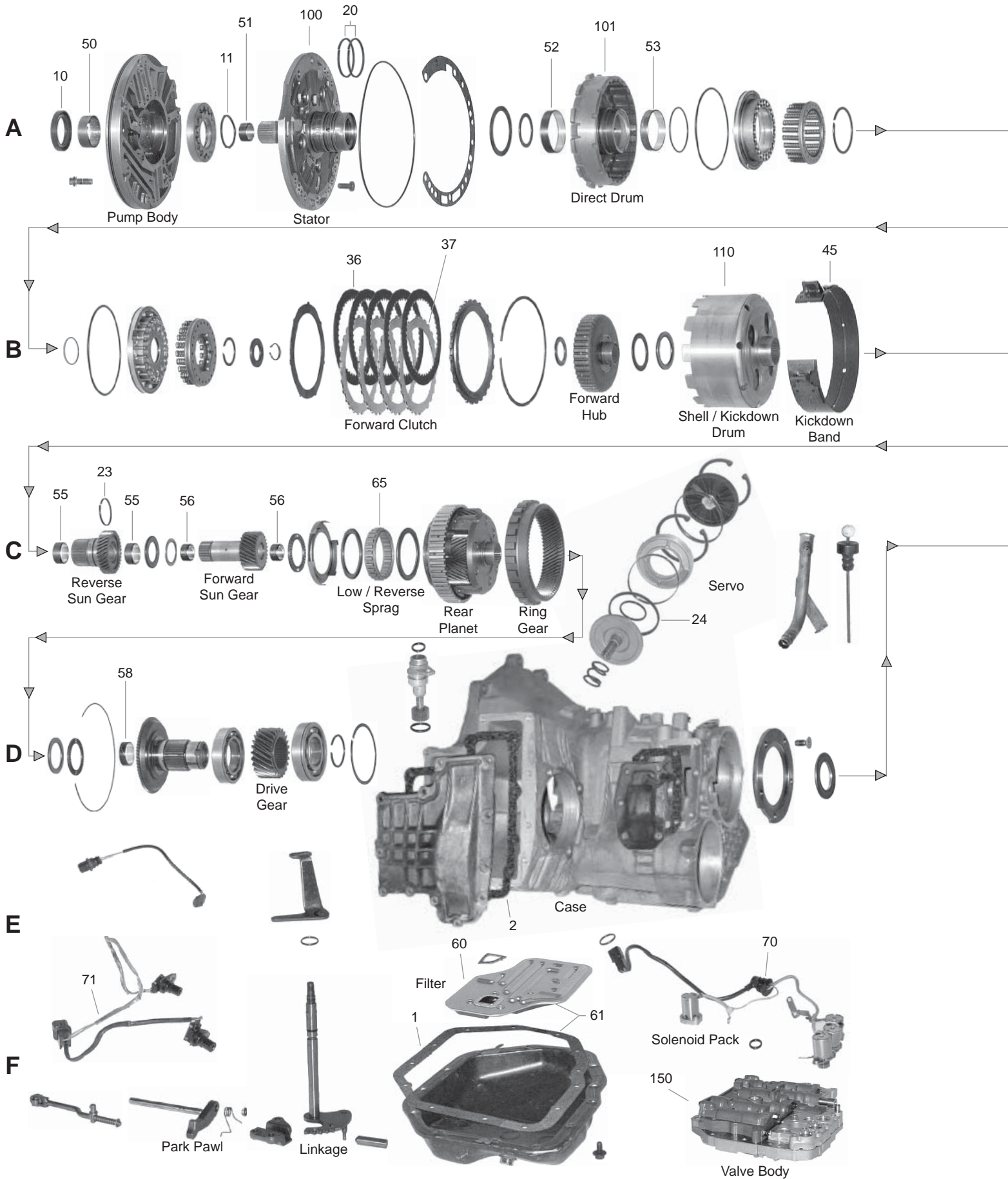

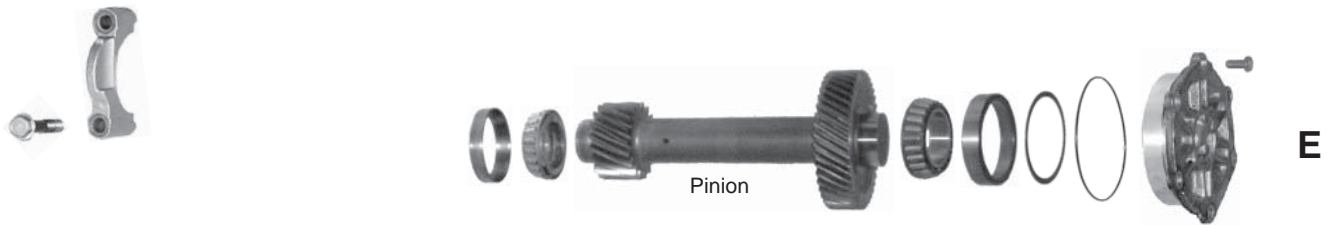
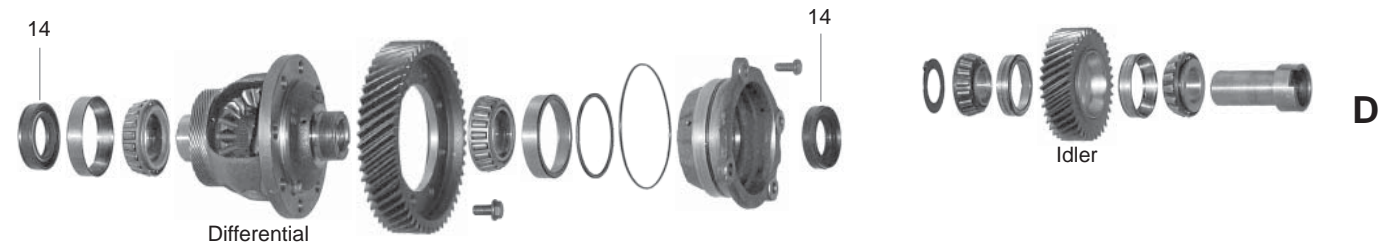
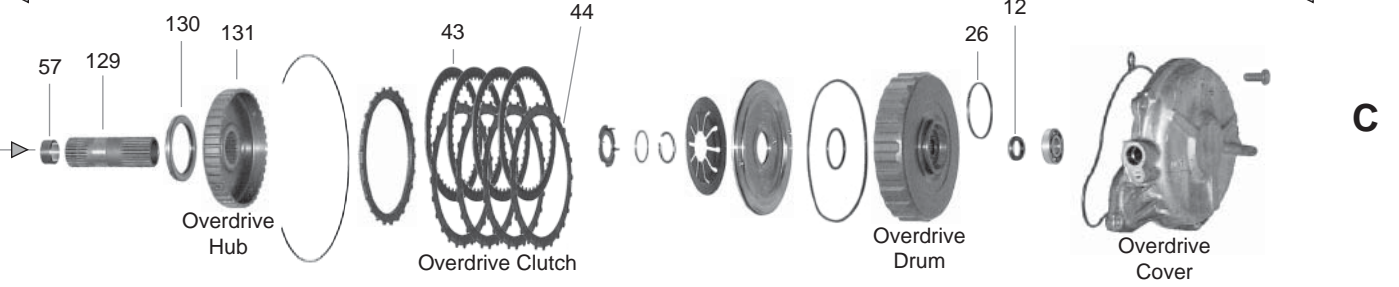
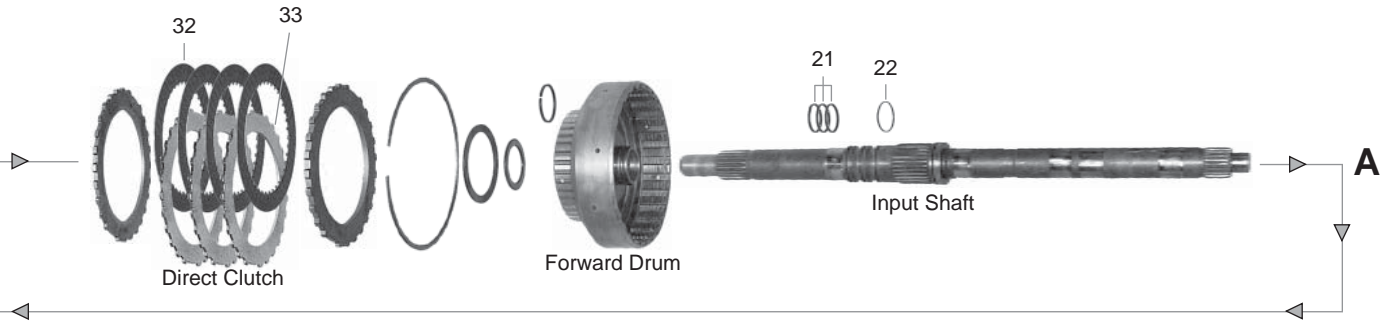

# Hyundai A4AF1/2/3 & A4BF1/2/3 (FWD 4-Speed)

VEHICLE MODEL	YEARS	DRIVE TRAIN	TRANS. TYPE	ENGINE
<b>HYUNDAI:</b>				
<b>Scoupe</b> .....	1993-95 .....	FWD .....	<b>A4AF1</b> .....	1.5 Litre
<b>Accent</b> .....	1995-99 .....	FWD .....	<b>A4AF2</b> .....	1.5 Litre
<i>w/6-pin case connector</i> .....	6/99-12 .....	FWD .....	<b>A4AF3</b> .....	1.5 & 1.6 Litre
<b>Elantra</b> .....	1996-98 .....	FWD .....	<b>A4BF1</b> .....	1.8 Litre
.....	1999 .....	FWD .....	<b>A4BF1</b> .....	1.8 & 2.0 Litre
<i>w/6-pin case connector</i> .....	6/99-00 .....	FWD .....	<b>A4BF2/3</b> .....	2.0 Litre
<b>Tiburon</b> .....	1997-99 .....	FWD .....	<b>A4BF1</b> .....	1.8 & 2.0 Litre
<i>w/6-pin case connector</i> .....	6/99-01 .....	FWD .....	<b>A4BF2/3</b> .....	1.8 & 2.0 Litre
ILL. NO.	PART NUMBER	PER CAR	DESCRIPTION	YEARS
<b>REBUILDER BOX KITS</b>				
---	<b>K7000R-S</b> <sup>1</sup>		Master Kit (w/o Steels) ..... <b>A4AF1, A4AF2</b> .....	1993-99
---	<b>K7000T-S</b> <sup>2</sup>		Master Kit (w/o Steels) ..... <b>A4BF1</b> .....	1996-99
---	<b>K7000RA-S</b>		Master Kit (w/o Steels) ..... <b>A4BF2/3 w/1.8 &amp; 2.0 Litre</b> .....	6/99-01
---	<b>K7000RC-S</b>		Master Kit (w/o Steels) ..... <b>A4AF3 w/1.5 &amp; 1.6 Litre</b> .....	6/99-On
<b>Steel Plate Sub-Kits:</b>				
---	<b>K7000R-9</b>		Steel Plate Kit ..... <b>A4AF1, A4AF2</b> .....	1993-1/97
---	<b>K7000V-9</b>		Steel Plate Kit ..... <b>A4AF2</b> .....	2/97-99
---	<b>K7000T-9</b> <sup>3</sup>		Steel Plate Kit ..... <b>A4BF1</b> .....	1996-12/97
---	<b>K7000W-9</b>		Steel Plate Kit ..... <b>A4BF1</b> .....	1/98-99
---	<b>K7000RA-9</b>		Steel Plate Kit ..... <b>A4BF2/3 w/1.8 &amp; 2.0 Litre</b> .....	6/99-01
---	<b>K7000RC-9</b>		Steel Plate Kit ..... <b>A4AF3 w/1.5 &amp; 1.6 Litre</b> .....	6/99-On
<sup>1</sup> For 1/98-99 <b>A4AF2</b> , please order (2) additional <b>70304W</b> Forward frictions separately. <sup>2</sup> For 1/98-99 <b>A4BF1</b> , please order (3) additional <b>70304W</b> Forward frictions separately. <sup>3</sup> For 2/97-12/97 <b>A4BF1</b> , please order (3) additional <b>70309V</b> End Clutch steels separately.				
<b>OVERHAUL KITS AND GASKET SETS</b>				
---	<b>K70900R</b>		Overhaul Kit ..... <b>All</b> .....	1993-99
---	<b>K70900RA</b>		Overhaul Kit ..... <b>A4AF3, A4BF2/3</b> .....	6/99-On
---	<b>K70900R-1</b>		Gasket & Rubber Kit..... <b>All</b> .....	1993-99
---	<b>K70900RA-1</b>		Gasket & Rubber Kit..... <b>A4AF3, A4BF2/3</b> .....	6/99-On
<b>GASKET AND RUBBER COMPONENTS</b>				
1F	<b>70170R</b>	1	Oil Pan Gasket ..... <b>Scoupe and Accent</b> .....	1993-On
1F	<b>70170T</b>	1	Oil Pan Gasket ..... <b>Elantra and Tiburon</b> .....	1996-01
2E	<b>70172R</b>	1	Differential Cover Gasket ..... <b>A4AF1</b> .....	1993-95
2E	<b>70172RA</b>	1	Differential Cover Gasket ..... <b>A4AF2</b> .....	1995-99
2E	<b>70172T</b>	1	Differential Cover Gasket ..... <b>A4AF3, A4BF1/2/3</b> .....	1996-On
<b>METAL CLAD SEALS</b>				
10A	<b>70526</b>	1	Front Pump .....	1993-On
11A	<b>70553</b>	1	Inner Pump Gear .....	1993-On
12C	<b>70550B</b>	1	End (Overdrive) Clutch ..... <b>12.9mm I.D.</b> .....	1993-On
14D	<b>70551</b>	2	Axle .....	1993-On
---	<b>70509</b>	1	Speedometer .....	1993-On

# Hyundai A4AF1/2/3 & A4BF1/2/3 (FWD 4-Speed)

Hyundai A4AF / A4BF

ILL. NO.	PART NUMBER	PER CAR	DESCRIPTION	YEARS
<b>SEALING RINGS</b>				
---	<b>K70901G</b>	1	Sealing Ring Kit .....	1993-99
---	<b>K70901RA</b>	1	Sealing Ring Kit ..... <b>A4AF3, A4BF2/3</b> .....	6/99-On
20A	<b>70200T</b>	2	Stator Support .....	1993-On
21A	<b>70202GT</b>	3	Input Shaft .....	1993-On
22A	<b>70201GT</b>	1	Rear Clutch Retainer .....	1993-On
23C	<b>70210T</b>	1	Sun Gear .....	1993-On
---	<b>70206RA</b>	1	Accumulator .....	6/99-On
24C	<b>70208T</b>	1	Servo - Large .....	1993-On
26C	<b>70209</b>	1	End Clutch .....	1993-99
26C	<b>70209RA</b>	1	End Clutch .....	6/99-On
<b>CLUTCHPLATES</b>				
32A	<b>70304G</b>	2-3	Front (Direct) Friction ..... <b>4.995" O.D., .077"</b> .....	1993-On
33A	<b>70312G</b>	1-4	Front (Direct) Steel ..... <b>.146", 4.115" I.D.</b> .....	1993-On
33A	<b>70312R</b>	2-3	Front (Direct) Steel ..... <b>.124", 4.115" I.D.</b> .....	1996-On
33A	<b>70312RA</b>	1	Front (Direct) Steel ..... <b>.190", 4.115" I.D.</b> .....	6/99-On
36B	<b>70304G</b>	2-3	Rear (Forward) Friction ..... <b>4.095" I.D., .077"</b> .....	1993-12/97
36B	<b>70304W</b>	2-5	Rear (Forward) Friction ..... <b>4.095" I.D., .070"</b> .....	1/98-On
37B	<b>70305G</b>	1-3	Rear (Forward) Steel ..... <b>4.115" I.D., .067"</b> .....	1993-12/97
37B	<b>70305W</b>	1-5	Rear (Forward) Steel ..... <b>4.115" I.D., .078"</b> .....	1/98-On
39B	<b>70321G</b>	4-6	Low/Reverse Friction ..... <b>.076"</b> .....	1993-On
40B	<b>70322G</b>	3	Low/Reverse Steel ..... <b>.070"</b> .....	1993-On
40B	<b>70322H</b>	5	Low/Reverse Steel ..... <b>.040"</b> .....	1996-On
43C	<b>70308</b>	3	End (Overdrive) Friction ..... <b>40 Teeth - .075"</b> .....	1993-99
43C	<b>70308RA</b>	3-5	End (Overdrive) Friction ( <b>Wider</b> ) ..... <b>36 Teeth - .061"</b> .....	6/99-On
44C	<b>70309</b>	3	End (Overdrive) Steel ..... <b>25 Teeth - .032"</b> .....	1993-1/97
44C	<b>70309V</b>	3	End (Overdrive) Steel ..... <b>25 Teeth - .039"</b> .....	2/97-99
44C	<b>70309RA</b>	4	End (Overdrive) Steel ..... <b>25 Teeth - .097"</b> .....	6/99-On
44C	<b>70309RB</b>	1	End (Overdrive) Steel ..... <b>25 Teeth - .076"</b> .....	6/99-On
44C	<b>70309RC</b>	1-3	End (Overdrive) Steel ..... <b>25 Teeth - .159"</b> .....	6/99-On
<b>BANDS</b>				
45B	<b>70714</b>	1	Brake Band ( <b>A4AF1, AF2, AF3</b> ) ..... <b>1.570" Wide</b> .....	1993-On
45B	<b>70714A</b>	1	Brake Band ( <b>A4BF1, BF2, BF3</b> ) ..... <b>1.730" Wide</b> .....	1996-On
<b>BUSHINGS</b>				
---	<b>K70980L</b>	1	Bushing Assortment Kit .....	1993-E/99
---	<b>K70980RA</b>	1	Bushing Assortment Kit .....	L/99-On
50A	<b>70005</b>	1	Front Pump Body .....	1993-On
51A	<b>70001L</b>	1	Stator Support .....	1993-On
52A	<b>70002L</b>	1	Direct Clutch Drum ( <b>Front</b> ) .....	1993-E/99
53A	<b>70008L</b>	1	Direct Clutch Drum ( <b>Rear</b> ) .....	1993-E/99
53A	<b>70008L</b>	1	Direct Clutch Drum .....	L/99-On
54B	<b>70003</b>	1	Low/Reverse Drum/Center Support ( <b>Front</b> ) .....	1993-On
55C	<b>70006L</b>	2	Reverse Sun Gear .....	1993-On
56C	<b>70016L</b>	2	Forward Sun Gear .....	1993-On
57C	<b>70016L</b>	1	Overdrive Clutch Shaft .....	1993-On
58D	<b>70009L</b>	1	Output Shaft ( <b>Front</b> ) .....	1993-On

# Hyundai A4AF1/2/3, A4BF1/2/3 - Cont'd.

ILL. NO.	PART NUMBER	PER CAR	DESCRIPTION	YEARS
<b>OIL FILTERS</b>				
60E	<b>70600R</b> <sup>4</sup>	1	Oil Filter .....	1993-5/99
60E	<b>70600RA</b> <sup>4</sup>	1	Oil Filter .....	6/99-On
61E	<b>ATK-175</b>	1	Oil Filter Kit ..... <b>A4AF1, A4AF2</b> .....	1993-5/99
61E	<b>ATK-211</b>	1	Oil Filter Kit ..... <b>A4BF1</b> .....	1996-5/99
61E	<b>ATK-229</b>	1	Oil Filter Kit ..... <b>Accent w/A4A/BF3</b> .....	6/99-On
61E	<b>ATK-230</b>	1	Oil Filter Kit ..... <b>Elantra and Tiburon w/A4BF2/3</b> .....	6/99-01
<sup>4</sup> Please See Filter Pictures on Page 9.1-6 for Visual Identification.				
<b>SPRAGS</b>				
65C	<b>70814R</b>	1	Low/Reverse Sprag ( <b>26 Elements, .616" Wide</b> ) .....	1993-On
65C	<b>51814</b>	1	Low/Reverse Sprag ( <b>26 Elements, .700" Wide</b> ) .....	1996-On
<b>SHIFT ENHANCEMENTS</b>				
---	<b>ST70944R</b>	1	Shift Correction Kit ..... <b>Superior, TransLab Version (Six-Solenoid Units)</b> ..... <b>Addresses:</b> 2-3 Flare, Mushy 2-3, Part Throttle 3-2 Bang, Delayed Engagements, No Converter Fill, 4-2 Kickdown Runaway and Slide 1-2. Provides Improved Cooler Flow, Lube and Lock-up Operation, As Well As Shorter Shifts and Extended Friction Life.	1993-On.
<b>ELECTRONIC COMPONENTS</b>				
70E	<b>K70879U</b>	1	Solenoid Pack ( <b>EPC, Shift and 3-Ohm TCC</b> ) ..... <b>Rostra</b> .....	1993-99
70E	<b>K70879AU</b>	1	Solenoid Pack ( <b>EPC, Shift, No TCC</b> ) ..... <b>Rostra</b> .....	1993-99
70E	<b>K70879BU</b>	1	Solenoid Pack ( <b>EPC, Shift and 12-Ohm TCC</b> ) ..... <b>Rostra</b> .....	1996-99
70E	<b>K70879RA</b>	1	Solenoid Pack ( <b>2 EPC, 3 Shift and 1 TCC</b> ) ..... <b>Rostra</b> .....	6/99-On
---	<b>70871U</b>	1-2	Shift Solenoid ..... <b>Teckpak</b> .....	1993-99
---	<b>K70871RA</b>	1	Shift Solenoids and T.C.C Solenoid ..... <b>OEM</b> .....	6/99-On
---	<b>70870U</b>	1	EPC Solenoid ..... <b>Teckpak</b> .....	1993-99
---	<b>70879RA</b>	2	EPC Solenoid ..... <b>OEM</b> .....	6/99-On
---	<b>70870U</b>	1	T.C.C Solenoid ( <b>3-Ohm</b> ) ..... <b>Teckpak</b> .....	1993-99
---	<b>70870AU</b>	1	T.C.C Solenoid ( <b>12-Ohm</b> ) ..... <b>Teckpak</b> .....	1993-99
71E	<b>K70875R</b>	1	Pulse Generators ..... <b>Accent</b> .....	1993-On
<b>HARD PARTS AND MISCELLANEOUS</b>				
<b>Note : When ordering Hard Parts, please add the appropriate suffix : (-R) Reman, (-U) Used, (-A) Aftermarket.</b>				
100A	<b>70895RA</b>	1	Pump Stator ..... <b>Accent</b> .....	6/99-On
100A	<b>70895RE</b>	1	Pump Stator ..... <b>Elantra/Tiburon</b> .....	6/99-On
101A	<b>70803RA</b>	1	Direct Drum ..... <b>Accent</b> .....	6/99-On
101A	<b>70803RE</b>	1	Direct Drum ..... <b>Elantra/Tiburon</b> .....	6/99-On
110B	<b>70810RA</b>	1	Shell/Kickdown Drum ..... <b>Accent</b> .....	6/99-On
110B	<b>70810RE</b>	1	Shell/Kickdown Drum ..... <b>Elantra/Tiburon</b> .....	6/99-On
129C	<b>70836RC</b>	1	O/D Hub Shaft ..... <b>All</b> .....	6/99-On
130C	<b>70427RC</b>	1	O/D Hub Bearing ( <b>Front, 3-Piece</b> ) ..... <b>All</b> .....	6/99-On
131C	<b>70837RC</b>	1	O/D Hub ..... <b>All</b> .....	6/99-On
150F	<b>40-109</b>	1	Reman Valve Body ..... <b>1.5 &amp; 1.6 Litre Units</b> .....	6/99-On