

Ford 6R60/75/80 (ZF6HP26)

RWD 6 Speed

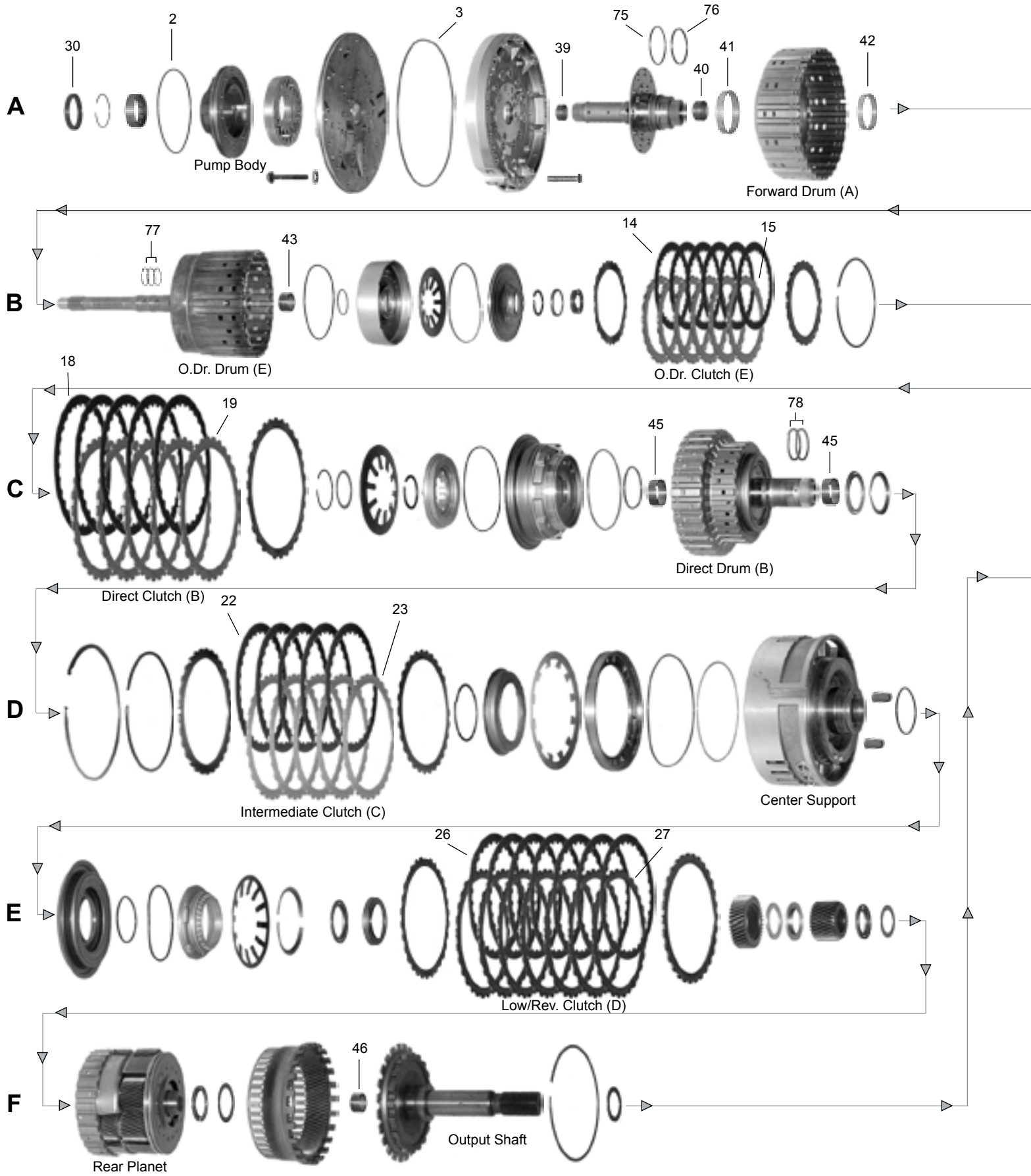

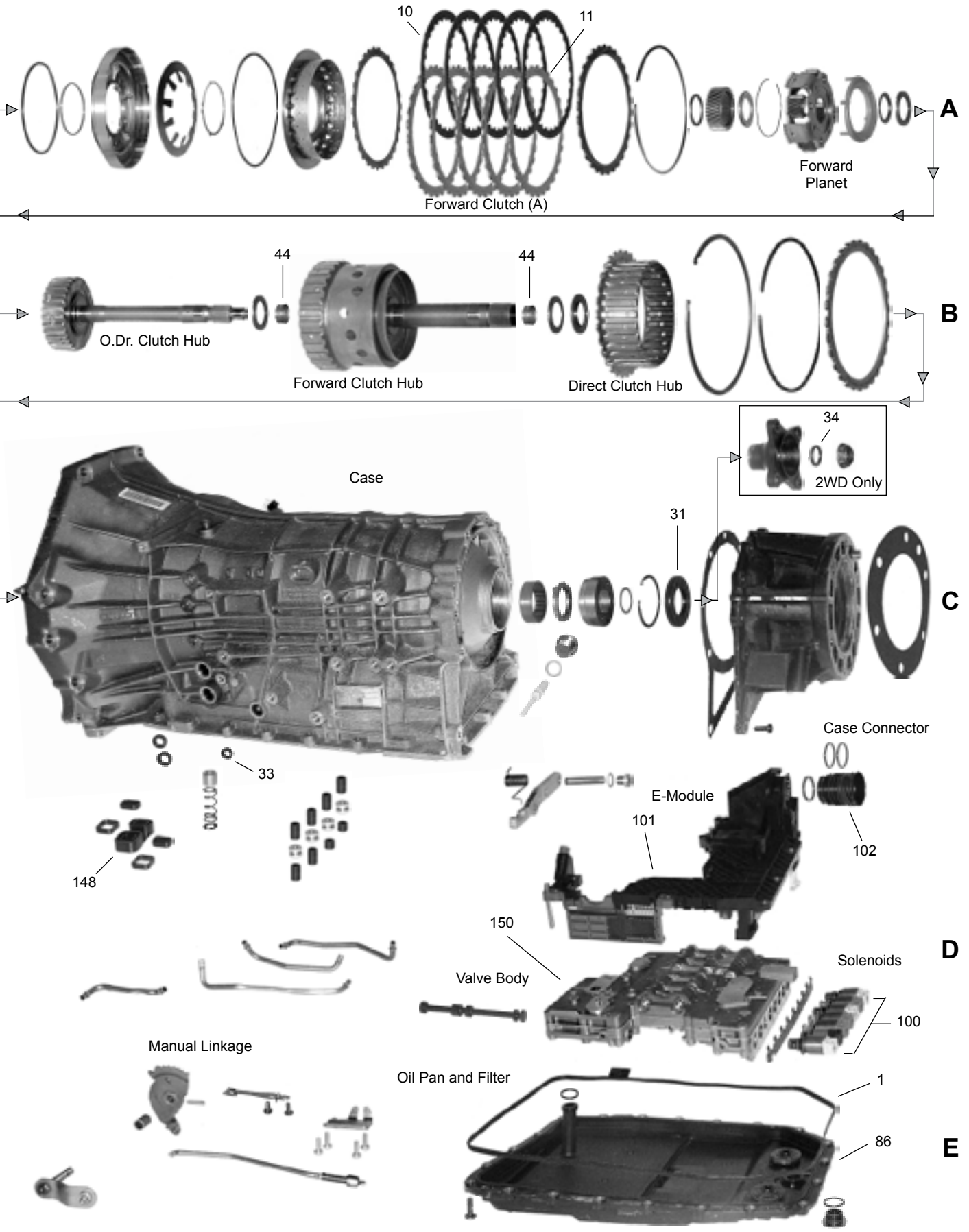

FORD 6R60/75/80 (ZF6-HP26/28/A61/X) 6-Spd

ILL. NO.	PART NUMBER	PER CAR	DESCRIPTION	YEARS
	TM6R60/75/80		Technical Manual (For ZF Units See Technical Manual Section)	2006-On
REBUILDER BOX KITS				
---	K7900D-S		Master Kit (w/o Steels) 6R60/75W	2006-On
---	K7900EG-S ¹		Master Kit (w/o Steels) ZF6-HP26/28 / X	2002-On
---	K7900FG-S ¹		Master Kit (w/o Steels) ZF6-HP26A61/28AF (Audi AWD)	2003-On
---	K7900H-S		Master Kit (w/o Steels) 6R80/W	2008-On
Steel Plate Sub-Kits:				
---	K7900D-9		Steel Plate Kit 6R60/75W	2006-On
---	K7900E-9		Steel Plate Kit ZF6 w/.118" "E" Steels	2002-On
---	K7900EA-9		Steel Plate Kit ZF6 w/.095" "E" Steels	2002-On
---	K7900H-9		Steel Plate Kit 6R80	2008-On
¹ Bonded Valve Body Plates are not Included in Kits, please order below by I.D. Stamping Number as needed.				
OVERHAUL KITS, GASKET SETS AND SEAL KITS				
---	K79900D		Overhaul Kit..... 6R60/75W	2006-On
---	K79900EG ¹		Overhaul Kit (German-Made Contents) ZF6-HP26/28 / X	2002-On
---	K79900FG ¹		Overhaul Kit (German-Made Contents) ZF6-HP26A61/28AF (Audi AWD)	2003-On
---	K79900H		Overhaul Kit..... 6R80/W	2008-On
GASKET AND RUBBER COMPONENTS				
1E	79170DR	1	Oil Pan Gasket (Metal w/Rubber Seal) 6R60/75W/80/W	2006-On
1E	79170E	1	Oil Pan Gasket (Paper) ZF6 w/Metal Pan	2002-On
1E	79170ER	1	Oil Pan Gasket (RubberSeal) ZF6 w/Plastic Pan	2002-On
2A	79100D	1	Front Pump O'Ring (Small)	2002-On
3A	79101D	1	Front Pump to Case O'Ring (Large)	2002-On
---	79106D	1	Solenoid Screened Gasket.....	2002-On
---	79125D	1-6	EDS Rubber Dampers (In Valve Body).....All.....	2002-On
6D	K79125D	1	Valve Body to Case Rubber Seals (4).....All.....	2002-On
---	79107D	1	Valve Body Plate (Beaded - 6 Damper Holes) 6R60/75W/80/W	2006-11/09
---	79107DB	1	Valve Body Plate (Beaded - 2 Damper Holes) 6R60/75W/80/W	11/09-11/10
---	79107DE	1	Valve Body Plate (Bonded - 6 Damper Holes) 6R60/75W/80/W	11/10-On
---	79107E	1	Valve Body Plate (Bonded) ZF6 w/1068327180 Stamped Plate or VB Code A/B052 ..	'02-On
---	79107EA	1	Valve Body Plate (Bonded) ZF6 w/1068327141 Stamped Plate or VB Code A/B035 ..	'02-On
---	79107EB	1	Valve Body Plate (Bonded) . ZF6 w/1068327145 or 179 Stamped Plate or A/BA036/051 ..	'02-On
---	79107EC	1	Valve Body Plate (Bonded) ZF6 w/1068327163 Stamped Plate or VB Code A/B047 ..	'02-On
---	79107ED	1	Valve Body Plate (Bonded) ZF6 w/1068327189 Stamped Plate or VB Code A/B053 ..	'02-On
---	79107EE	1	Valve Body Plate (Bonded) ZF6 w/o Stamped Plate or VB Code A/B046	'02-On
---	79107EF	1	Valve Body Plate (Bonded) ZF6 w/1068327210 Stamped Plate or VB Code A/B063 ..	'02-On
---	79107EG	1	Valve Body Plate (Bonded) ZF6 w/1068327224 Stamped Plate or VB Code A/B065 ..	'02-On
CLUTCH PLATES				
10A	79304D	4-5	Forward (A) Friction (All) 30T, .062" - 7.370" O.D.	2002-On
11A	79305DC	3-5	Forward (A) Steel (All) 30T, .118" - 6.450" I.D.	2002-On
11A	79305DD	AR	Forward (A) Steel (Selective for A/B/C/D) 30T, .130" - 6.450" I.D.	2002-On
11A	79305DE	AR	Forward (A) Steel (Selective for A/B/C/D) 30T, .142" - 6.450" I.D.	2002-On
14B	79310D	5-7	Overdrive (E) Friction (ZF6 / 6R60/75W) 30T, .064" - 5.150" O.D.	2002-On
14B	79310DA	5-7	Overdrive (E) Friction (6R80/W) 30T, .079" - 5.150" O.D.	2008-On
15B	79311D	AR	Overdrive (E) Steel (Selective) 24T, .095" - 4.200" I.D.	2002-On
15B	79311DA	5-7	Overdrive (E) Steel (ZF6 / 6R60/75W / 6R80/W) 24T, .118" - 4.200" I.D.	2002-On
18C	79304DA	4-5	Direct (B) Friction (All) 30T, .082" - 7.370" O.D.	2002-On
18C	79304DB	AR	Direct (B) Friction (Selective) 30T, .087" - 7.370" O.D.	2002-On
19C	79305D	4-5	Direct (B) Steel (All) 30T, .082" - 6.450" I.D.	2002-On
22D	79304DA	4-5	Intermediate (C) Friction (All) 30T, .082" - 7.370" O.D.	2002-On
22D	79304DB	AR	Intermediate (C) Friction (Selective) 30T, .087" - 7.370" O.D.	2002-On
23D	79305D	4-5	Intermediate (C) Steel (6R60/75W) 30T, .082" - 6.450" I.D.	2006-On

FORD 6R60/75/80 (ZF6-HP26/28/A61/X) 6-Spd

ILL. NO.	PART NUMBER	PER CAR	DESCRIPTION	YEARS
CLUTCH PLATES - Cont'd.				
26E	79304D	4-7	Low/Reverse (D) Friction (All) 30T, .062" - 7.370" O.D.	2002-On
26E	79304DA	AR	Low/Reverse (D) Friction (Selective) 30T, .082" - 7.370" O.D.	2002-On
27E	79305DC	4-7	Low/Reverse (D) Steel (6R60/75W) 30T, .118" - 6.450" I.D.	2006-On
27E	79305D	6-7	Low/Reverse (D) Steel (ZF6 / 6R80/W) 30T, .082" - 6.450" I.D.	2002-On
27E	79305DA	AR	Low/Reverse (D) Steel (Selective) 30T, .095" - 6.450" I.D.	2002-On
METAL CLAD SEALS				
30A	79526D	1	Front Pump.....	2002-On
31C	79551D	1	Extension Housing (2WD) Exc. 6R80/W	2002-On
31C	79551H	1	Extension Housing (2WD) 6R80/W	2008-On
31C	79553D	1	Adapter Seal (4WD) Exc. 6R80/W	2002-On
31C	79553H	1	Adapter Seal (4WD) 6R80/W	2008-On
33C	79507D	1	Manual Lever.....	2002-On
34C	79552D	1	Yoke Spline	2002-On
BUSHINGS				
---	K79980D	1	Bushing Assortment Kit 6R60/75W	2006-On
---	K79980E	1	Bushing Assortment Kit ZF6 / 6R80/W	2002-On
---	K79980EY	1	Bushing Assortment Kit (Omega) All	2002-On
38A	79005H	1	Pump Bushing 6R80/W	2011-On
39A	79001D	1	Stator Shaft (Front - .907" I.D.) 6R60/75W	2006-08
40A	79002D	1	Stator Shaft (Rear - 1.100" I.D.) 6R60/75W	2006-08
40A	79002E	1	Stator Shaft (Rear - 1.025" I.D.) ZF6	2002-On
40A	79002H	1	Stator Shaft (Rear - 1.180" I.D.) ZF6 - 6R80/W	2002-On
41A	79003D	1	Forward Drum (Front) All	2002-On
42A	79004D	1	Forward Drum (Rear) All	2002-On
43B	79006D	1	O/D Drum All	2002-On
44B	79007D	2	Forward Clutch Hub (Front / Rear - .954" I.D.) Some	2002-On
44B	79007E	2	Forward Clutch Hub (Front / Rear - .994" I.D.) Some	2002-On
45C	79009D	2	Direct Drum (Front & Rear - 1.340" I.D.) All	2002-On
46F	79006D	1	Output Shaft.....	2006-On
THRUST WASHERS AND BEARINGS				
---	K79941D	1	Thrust Needle Bearing Kit 6R60/75W	2006-On
---	K79941E	1	Thrust Needle Bearing Kit ZF6	2002-On
---	K79941H	1	Thrust Needle Bearing Kit 6R80/W	2008-On
SEALING RINGS				
---	K79901D	1	Sealing Ring Kit..... 6R60/75W	2006-On
---	K79901E	1	Sealing Ring Kit..... ZF6	2002-On
---	K79901H	1	Sealing Ring Kit..... 6R80/W	2008-On
75A	79200DT	1	Front Pump Support (Large) All	2002-On
76A	79201DT	1	Front Pump Support (Small)..... All	2002-On
77B	79202DT	2	Turbine Shaft (Teflon) 6R60/75W	2006-On
77B	79202EP	3	Turbine Shaft (Plastic) ZF6	2002-On
77B	79202HT	3	Turbine Shaft (Teflon) 6R80/W	2008-On
78C	79203DT	2	Direct Clutch..... All	2002-On
TRANSMISSION OIL FILTERS				
---	79600D	1	Oil Filter (Filter Only - Triangular Shape) 6R60/75W	2002-06
---	79600D	1	Oil Filter (Filter Only - Triangular Shape) ...ZF6 w/Metal Pan (Exc Audi)	2002-On
---	79600F	1	Oil Filter (Filter Only - Triangular Shape) Audi w/Metal Pan	2002-On
86E	K79600E	1	Plastic Oil Pan w/Integrated Filter ZF6	2002-On
86E	K79600E-DE	1	"OEM ZF" Plastic Oil Pan w/Integrated Filter ZF6	2002-On
---	79600H	1	Oil Filter (Deep Pan - 1.500" Inlet - Square Shape) 6R60/75/80/W	L/06-On
---	79600HB	1	Oil Filter (Shallow Pan - 1.000" inlet - Square Shape) 6R80/W	2008-On
---	79600HH	1	Oil Filter (O'Ring Neck Seal, Hybrid Units) 6R80/W	2012-On

6R60 / 75 / 80 (ZF6)

FORD 6R60/75/80 (ZF6-HP26/28/A61/X) 6-Spd

ILL. NO.	PART NUMBER	PER CAR	DESCRIPTION	YEARS
ELECTRONIC COMPONENTS				
6R60/75W80W Units:				
100D	K79879D	1	Solenoid Kit	2006-10
100D	79870D	1	TCC Solenoid Brown Connector	2006-10
100D	79870HB	1	TCC Solenoid Yellow Connector - Brown Body	2010-On
100D	79870D	1-2	SSA & SSC Solenoids Brown Connector	2006-10
100D	79870HB	1-2	SSA & SSC Solenoids Yellow Connector - Brown Body	2010-On
100D	79871D	1-3	SSB, SSD & PCA Solenoids Black Connector	2006-10
100D	79871HB	1-3	SSB, SSD & PCA Solenoids Yellow Connector - Black Body	2010-On
100D	79879D	1	SSE Solenoid Yellow Connector	2006-On
101D	K79869A	1	Connector Plate (Includes: TISS, TOSS, TOT, PRNDL - Units w/TCM Bosch).....	2006-10
101D	K79869H	1	Connector Plate (Includes: TISS, TOSS, TOT, PRNDL - Units w/o TCM Siemens).....	2010-On
102D	79878A	1	Case Connector	2006-On
ZF6 Units:				
---	K79879A	1	Solenoid Kit (Includes: (3) 79870A, (3) 79870B, (2) 79871A, K79871B & 79869B)	2002-On
---	K79879B	1	Solenoid Kit (Includes: (5) 79870A, 79870B & 79871A)	2002-On
---	K79879E	1	Solenoid Kit (Includes: (3) 79870A, (3) 79870B & 79871A)	2002-On
---	K79879F	1	Solenoid Kit (Includes: (3) 79870A, (2) 79870B & (2) 79870F).....	2002-On
---	K79879FA	1	Solenoid Kit (Includes: (3) 79870A, (2) 79870B & (2) 79870F, 79871A, K79871B, 79869B)	2002-On
100D	79870A	3-5	EDS Solenoid (.663" O.D. Solenoid O'Ring Land) Yellow	2002-On
100D	79870B	1-3	EDS Solenoid (.641" O.D. Solenoid O'Ring Land) Blue	2002-On
100D	79870F	0-2	EDS Solenoid (.721" O.D. Solenoid O'Ring Land) Orange	2002-On
100D	79871A	0-1	MV1 Solenoid (Emergency Run Valve)..... Black	2002-On
100D	79871A	0-1	MV2 Solenoid (Park Lock Valve - Energizes)..... Black	2002-On
100D	K79871B	0-1	MV3 Solenoid (Park Lock Valve - Operates)..... Green Top w/Park Cylinder/Rod	2002-On
---	79869B	0-1	Wiring Harness (For Park Cylinder Units)	2002-On
101D	K79869A	1	E-Module/Connector Plate (Includes: TISS, TOSS, TOT, PRNDL Switch)	2002-On
102D	79878A	1	Case Connector	2002-On
---	79880A	1	Foam Strip (Between Solenoids and Plastic Connector Housing)	2002-On
SHIFT ENHANCEMENTS AND MISCELLANEOUS				
---	ZF6-6R60-ZIP		Zip-Kit (Sonnax, Fits ZF6HP26 & 6R60/75/80 - Drop-In Components, No Tools)	2002-On
---	ZF6-GEN2-ZIP		Zip-Kit (Sonnax, Fits ZF6HP28 - Drop-In Components, No Tools Required)	2002-On
Addresses: Critical Pressure Losses and Restores/Extends Accumulator Action.				
---	K79946E	1	Lock-up Shudder Repair Kit (TransGo)	2002-On
---	79889E	1	Pressure Regulator Sleeve (Sonnax, Addresses: Harsh or Erratic Line)	2002-On
---	K79882E	1	Clutch "A" Control Boost Valve and Sleeve Kit (Sonnax)	2002-On
Addresses: Delayed/Harsh Engagements, Flare 5-4 Downshift.				
---	K79788EW	1	VB End Plug Kit (Sonnax, 6 Large and 6 Small End Plugs)	2002-On
---	K79788DW	1	VB Internal Plug Kit (Sonnax, 4 Internal Plugs)	2002-On
---	K79788E	1	Sure-Seal VB End Plug Kit (Superior)	2002-On
Addresses: OE End Plugs Leak Causing Low Circuit Pressures/Erratic Shifts/Codes.				
---	K79781E	1	Valve Body Accumulator Piston and Spring Kit (Sonnax)	2002-On
Addresses: Firms Upshifts and Downshifts and Engagements.				
---	79781E	1-6	Valve Body Accumulator Piston (OEM ZF)	2002-On
Valves Below Require Tools:				
---	K79989E	1	Oversized Pressure Regulator Valve Kit (Sonnax)	2002-On
Addresses: Delayed/No Reverse and Poor Quality Shifts. Requires K79589E Tool Kit.				
---	K79886E	1	Oversized Solenoid Pressure Regulator Valve Kit (Sonnax)	2002-On
Addresses: Wrong Gear Starts, Gear Ratio and Solenoid Codes Requires K79586E Tool Kit.				
---	K79887E	1	Oversized Bypass Clutch Control Valve Kit (Sonnax)	2002-On
Addresses: Converter Overheat and Low TCC Release Pressure. Requires K79587E Tool Kit.				
---	K79883E	1	Oversized Converter Release Regulator Valve Kit (Sonnax)	2002-On
Addresses: Excessive TCC Slip, Harsh Lockup Apply/Release. Requires K79583E Tool Kit.				
---	K79880E	1	Oversized Lubrication Control Valve Kit (Sonnax)	2002-On
Addresses: Low Converter Pressure and Lube Failure. Requires K79580E Tool Kit.				
---	K79881E	1	Oversized Clutch A Control Valve Kit (Sonnax)	2002-On
Addresses: Flare Upshift or Downshift Bind-ups. Requires K79581E Tool Kit.				
---	K79884E	1-2	Oversized Clutch D1 or E Control Valve Kit (Sonnax)	2002-On
Addresses: Flare Upshift or Downshift Bind-ups. Requires K79581E Tool Kit.				

FORD 6R60 (ZF6-HP26/28, A61, X) 6-Speed A/RWD

ILL. NO.	PART NUMBER	PER CAR	DESCRIPTION	YEARS
HARD PARTS AND MISCELLANEOUS				
Note : When ordering Hard Parts, please add the appropriate suffix : (-R) Reman, (-U) Used, (-A) Aftermarket.				
148D	79881E	1	Mechatronic to Case Seal Adapter (Early - No Tab)ZF6	2002-On
148D	79881EF	1	Mechatronic to Case Seal Adapter (Late - with Tab)ZF6	2002-On
---	ZF6OIL	1	Lifeguard 6 OEM Oil (20 Litres/18.93 Quarts)	2002-On
---	ZF6OIL-1L	1	Lifeguard 6 OEM Oil (1 Litre)	2002-On
OEM MECHATRONIC VALVE BODIES				
150D	Various		Note: To purchase a Mechatronic Assembly (aka: Valve Body) for a ZF6, you will need the "STUECKL Number" from the tag on the side of the transmission case, Vin Number, Vehicle Year, Make and Model When being ordered. This will ensure that the correct assembly is ordered. The Mechatronic Assembly is Flashed (per VIN) and includes the Oil/Pan Filter.	
150D	MECHA-976	1	Mechatronic Valve Body..... 325i Coupe (02/2006 - 08/2007) and 335i Coupe (01/2007 - 08/2007)	Various
150D	MECHA-973	1	Mechatronic Valve Body..... 335xi, 335i (01/2007 - 08/2007)	Various
150D	MECHA-980	1	Mechatronic Valve Body..... 525i w/ (M25/B25MS), (N52/B25A) Engines and 531i w/(M52/B30MS) Engine	Various
150D	MECHA-974	1	Mechatronic Valve Body..... All Z4 (2005 - On) And 325i/xi, 330i/xi, 525i/xi, 530i/xi w/(022-016/015) (012-085/086) (010-025) Transmission ID	Various
150D	MECHA-341	1	Mechatronic Valve Body..... 525i, 535i (01/2007 - On)	Various
150D	MECHA-932	1	Mechatronic Valve Body..... 545i/iA (2003-2005), 645ci (2004 - 08/2005)	Various
150D	MECHA-936	1	Mechatronic Valve Body..... 550i w/ 6hp26, and 645ci (12/2005 - 2007)	Various
150D	MECHA-411	1	Mechatronic Valve Body..... 550i w/ 6hp28 (09/2006 - 08/2007)	Various
150D	MECHA-931	1	Mechatronic Valve Body..... 745i/L/Li (2001-01/2003), 760i/L/Li (10/2002 - 02/2003) w/Transmission Code "118"	Various
150D	MECHA-937	1	Mechatronic Valve Body..... 745i/L/Li (02/2003 - 08/2003), 760i/L/Li (2002 - 08/2003)	Various
150D	MECHA-997	1	Mechatronic Valve Body..... 745i/L/Li (09/2003 - 02/2005), 760i/L/Li (09/2003 - 09/2004)	Various
150D	MECHA-933	1	Mechatronic Valve Body..... 750i/L/Li(03/2005 - On), 760i/L/Li (10/2004 - 08/2005) ..	Various
150D	MECHA-985	1	Mechatronic Valve Body..... X5 (2003-2006 w/6HP26X)	Various
150D	MECHA-948	1	Mechatronic Valve Body..... S-Type V6,V8 (2002 - On) Except (2003-2005) XJ (04/2005 - On) Except (10/2005 - On) w/SuperCharger, XK8 (2002-2003) w/o SuperCharger	Various
150D	MECHA-950	1	Mechatronic Valve Body..... S-Type V6 (2003)	Various
150D	MECHA-947	1	Mechatronic Valve Body..... S-Type (04/2003), XJ (06/2003 - 04/2004), All XK8 (06/2003 - 04/2004)	
150D	MECHA-946	1	Mechatronic Valve Body..... S-Type (04/2004 - 06/2005), XJ (02/2005 - 06-2005) XK8 (02/2005 - 06/2005)	Various
150D	MECHA-943	1	Mechatronic Valve Body..... S-Type V6 (06/2005 - On), XJ (10/2005 - On) w/Super Charger	
150D	MECHA-945	1	Mechatronic Valve Body..... XJ (01/2003 - 06/2003)	Various
150D	MECHA-941	1	Mechatronic Valve Body..... XK (04/2006 - On)	Various
150D	MECHA-938	1	Mechatronic Valve Body..... Version 3 Range Rover Sport - Discovery - LR3	Various
150D	MECHA-942	1	Mechatronic Valve Body..... Version 2 Range Rover Sport - Discovery	Various
150D	MECHA-944	1	Mechatronic Valve Body..... Version 1 Range Rover Sport	Various
Reman Valve Bodies:				
Note: Does not include the TCM, can be purchased with Tested or New Solenoids, add "N" Prefix for New.				
150D	15-156A	1	Valve Body (Reman) 6R60/75W w/Internal TCM	2006-10
150D	15-156B	1	Valve Body (Reman) 6R60/75W w/External TCM	2011-On
150D	50-119A	1	Valve Body (Reman) BMW, Jaguar, Range Rover w/Plate ID 1068-327-141 ..	Various
150D	50-119B	1	Valve Body (Reman) BMW, Jaguar, Range Rover w/Plate ID 1068-327-145/179 ..	Various
150D	50-119C	1	Valve Body (Reman) BMW, Jaguar, Range Rover w/Plate ID 1068-327-163 ..	Various
150D	50-119D	1	Valve Body (Reman) BMW, Jaguar, Range Rover w/Plate ID 1068-327-180 ..	Various
150D	50-119E	1	Valve Body (Reman) BMW, Jaguar, Range Rover w/Plate ID 1068-327-189 ..	Various
150D	50-119F	1	Valve Body (Reman) BMW, Jaguar, Range Rover w/Plate ID 1068-327-210 ..	Various
150D	50-119G	1	Valve Body (Reman) BMW, Jaguar, Range Rover w/Plate ID 1068-327-224 ..	Various

6R60 / 75 / 80 (ZF6)