

5R110W (TorqShift)

RWD 5 Speed

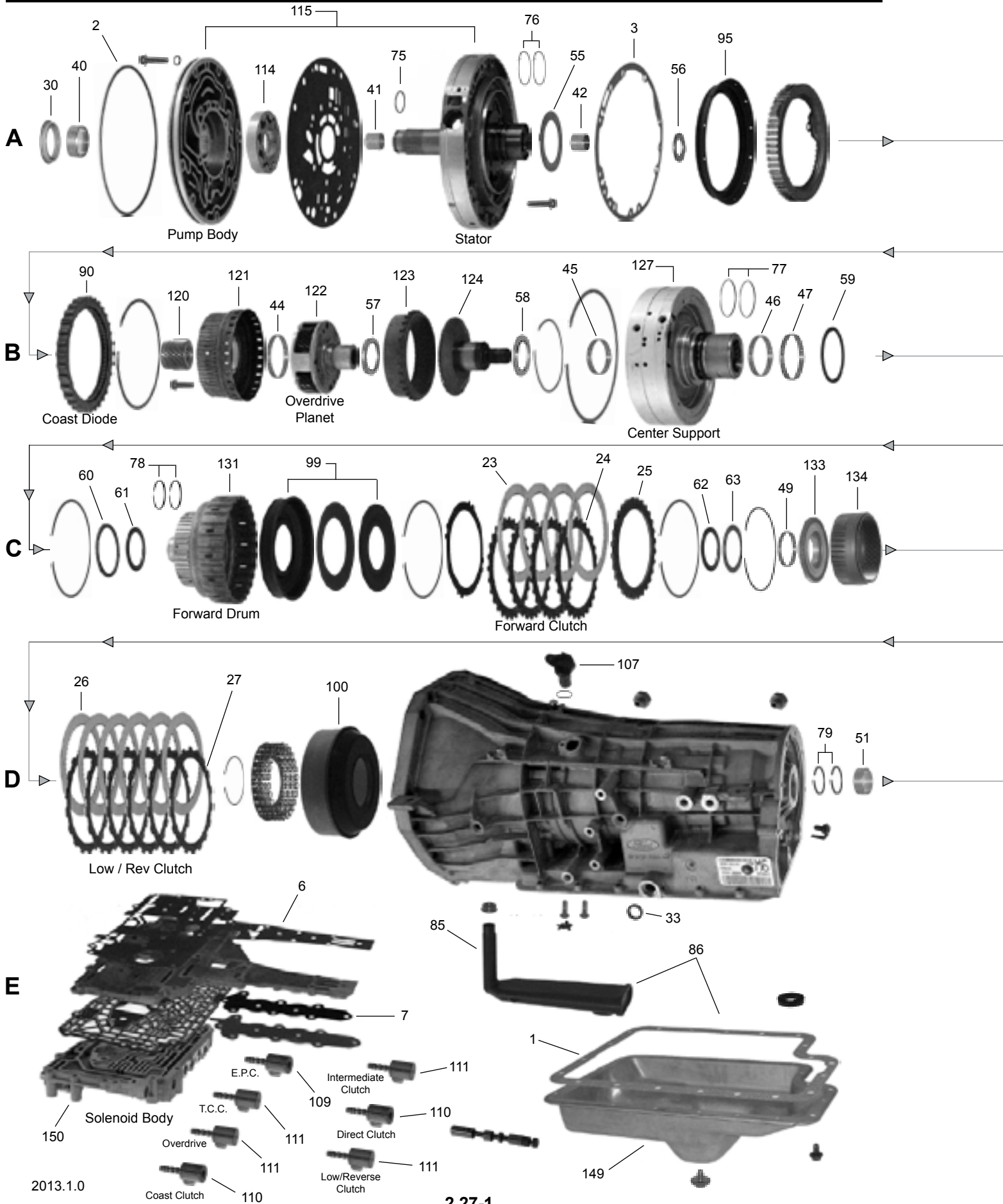

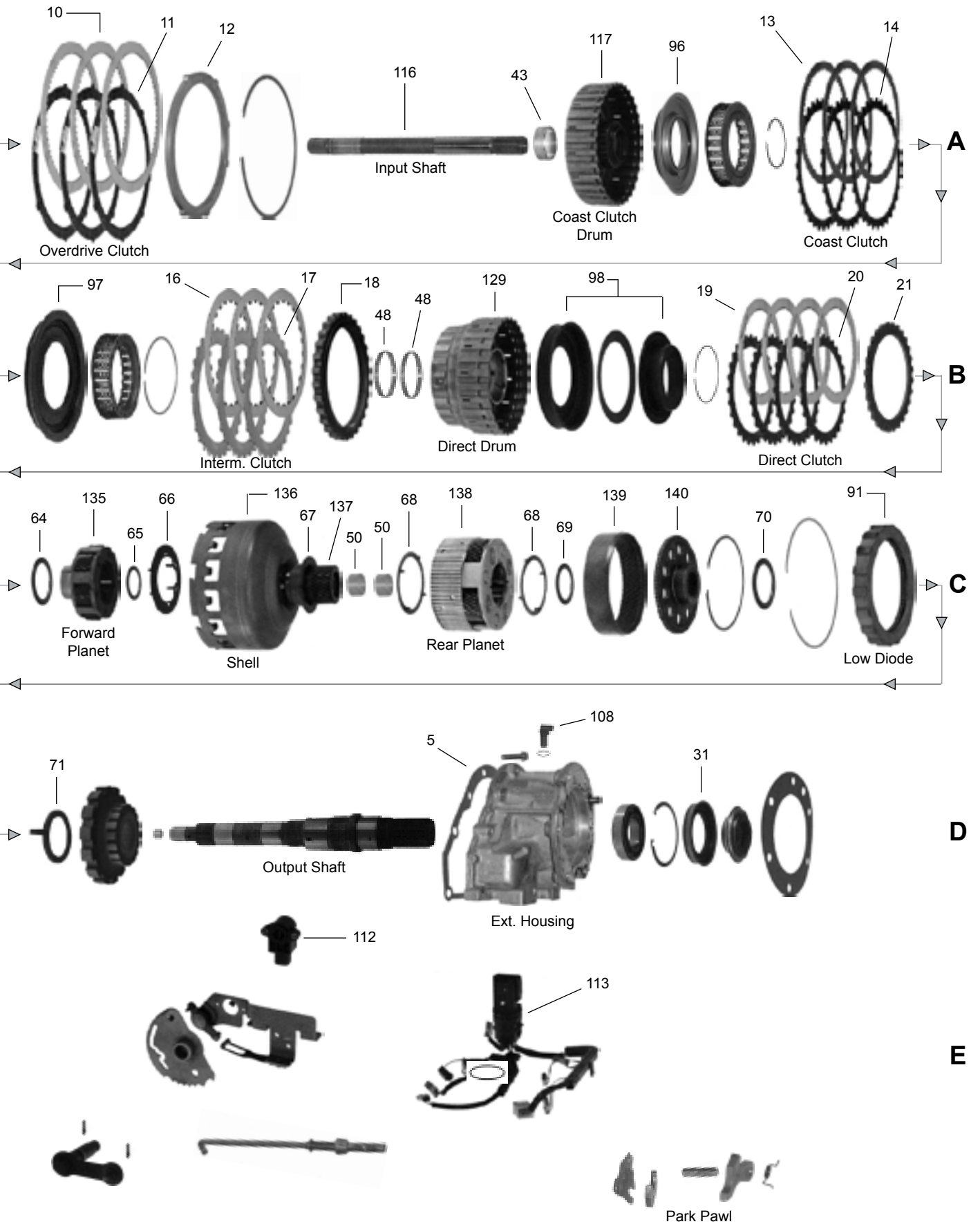

FORD 5R110W ('Torqshift' 5-Speed RWD)

ILL. NO.	PART NUMBER	PER CAR	DESCRIPTION	YEARS
	TM5R110W		Technical Manual.....	2003-On
REBUILDER BOX KITS				
---	K3800-S ^{1,2}		Master Kit (w/o Steels).....	2003-04
---	K3800B-S ^{1,2}		Master Kit (w/o Steels).....	2005-On
Steel Plate Sub-Kits:				
---	K3800-9		Steel Plate Kit	2003-04
---	K3800B-9		Steel Plate Kit	2005-On
¹ Does not include Molded Rubber Pan Gasket (37170GR), Molded Rubber Piston Kit (K38900-4) nor the Rear Seal for the fixed yoke design (38551A). ² Vehicles with P.T.O. (Power Take Off) cover require a PTO Gasket, please order 37106K .				
OVERHAUL KITS, GASKET SETS AND SEAL KITS				
---	K38900 ^{1,2}		Overhaul Kit.....	2003-On
---	K38900-1 ^{1,2}		Gasket & Rubber Kit.....	2003-On
---	K38900-7		Front Pump Seal-Up Kit	2003-On
---	K38900-8 ^{1,2}		Complete External Seal-Up Kit.....	2003-On
---	K38900-3		Valve Body Gasket Kit.....	2003-On
GASKET AND RUBBER COMPONENTS				
1E	37170GR	1	Oil Pan Gasket Molded Rubber	2003-On
2A	37100	1	Front Pump Lathe Cut Seal.....	2003-On
3A	38101	1	Front Pump to Case Gasket.....	2003-On
---	37106K	1	P.T.O. Cover to Case Gasket	2003-On
5D	38110	1	Extension Housing Gasket..... 2WD	2003-On
6E	38102	1	Valve Body Gasket	2003-On
7E	38615	1	Valve Body Silicone Gasket with Screens	2003-On
CLUTCH PLATES				
10A	38310	3	Overdrive Friction 32T, .077" - 8.710" O.D.	2003-On
11A	38311	3	Overdrive Steel..... 6T, .079" - 7.455" I.D.	2003-On
12A	37314	1	Overdrive Pressure Plate318"	2003-On
13A	38308	3	Coast Friction 59T, .079" - 6.598" O.D.	2003-On
14A	38309	3	Coast Steel 32 Large "V" Teeth, .079" - 5.840" I.D.	2003-On
16B	38306	3	Intermediate Friction..... 24 "Square" Teeth, .075" - 7.805" O.D.	2003-04
16B	38306B	3-4	Intermediate Friction..... 96 "V" Teeth, .075" - 7.800" O.D.	2005-On
17B	38307	3	Intermediate Steel 26T, .127" - 6.500" I.D.	2003-04
17B	38307B	3-4	Intermediate Steel 26T, .116" - 6.500" I.D.	2005-On
18B	38312	1	Intermediate Pressure Plate.....	2003-04
18B	38312B	1	Intermediate Pressure Plate.....	2005-On
19B	38304	4	Direct Friction (Grooved) 48T, .077" - 6.270" O.D.	2003-On
20B	38305	4	Direct Steel..... 28T, .079" - 5.120" I.D.	2003-On
21B	38316	1	Direct Pressure Plate	2003-On
23C	38302	4	Forward Friction (Hardened Splines) 90 "V" Teeth, .077" - 6.25" O.D.	2003-04
23C	38302B	4	Forward Friction (Hardened Splines) .. 76 "Square" Teeth, .077" - 6.38" O.D.	2005-On
24C	38305	4	Forward Steel..... 28T, .079" - 5.115" I.D.	2003-04
24C	38303B	4	Forward Steel..... 20T, .079" - 5.380" I.D.	2005-On
25C	38316	1	Forward Pressure Plate.....	2003-04
25C	38315B	1	Forward Pressure Plate.....	2005-On

FORD 5R110W ('Torqshift' 5-Speed RWD)

ILL. NO.	PART NUMBER	PER CAR	DESCRIPTION	YEARS
CLUTCH PLATES - Cont'd.				
26D	38321	6	Low/Reverse Friction 72 Teeth - .077"	2003-On
27D	36505	6	Low/Reverse Steel068"	2003-On
---	K38323E	1	Low/Reverse Friction and Steel Kit (Modified Plates, Cut-off Old Captured Plates Install These) .	2008-On
METAL CLAD SEALS				
30A	38526	1	Front Pump.....	2003-On
31D	38551	1	Extension Housing w/Slip Yoke	2003-On
31D	38551A	1	Extension Housing w/Fixed Yoke (Not In Kits)	2003-On
---	38551A	1	Adapter Seal (4WD)	2003-On
33D	26507	1	Manual Lever.....	2003-On
BUSHINGS				
---	K38980	1	Bushing Assortment Kit	2003-On
40A	47005	1	Front Pump.....	2003-On
41A	36000A	1	Stator Support (Front)	2003-On
42A	36001A	1	Stator Support (Rear)	2003-On
43A	38000	1	Coast Clutch Drum	2003-On
44B	38001	1	Coast Clutch Hub	2003-On
45B	38002	1	Center Support..... Front	2003-On
46B	38003	1	Center Support..... Center	2003-On
47B	38004	1	Center Support..... Rear	2003-On
48B	38006	2	Direct Drum	2003-On
48B	38006Y	1	Direct Drum (Omega)	2003-On
---	38010Y	1	Forward Drum (Omega 1-Piece)	2003-On
49C	38009	1	Front Ring Gear Hub	2003-On
50C	36005	2	Sun Gear.....	2003-On
51D	38007	1	Case	2003-On
THRUST WASHERS AND BEARINGS				
---	K38940	1	Thrust Washer Kit	2003-04
---	K38940B	1	Thrust Washer Kit	2005-On
---	K38941	1	Thrust Needle Bearing Kit	2003-On
55A	37400	1	Front Pump Support Washer.....	2003-On
56A	37425	1	Stator to Overdrive Sun Gear Needle Bearing	2003-On
57B	53420	1	Overdrive Planetary Needle Bearing..... Rear	2003-On
58B	53423	1	Overdrive Center Shaft Needle Bearing.....	2003-On
59B	38401	1	Center Support to Direct Drum Washer (Rear) ... 2 Alignment Dowels	2003-On
60C	38402	1	Direct Brake Drum to Forward Drum Washer Plastic	2003-On
61C	38420	1	Center Support to Forward Drum Needle Bearing	2003-On
62C	38421	1	Forward Planetary Needle Bearing (2.106 O.D.) Front	2003-On
63C	36421	1	Forward Drum to Ring Gear Hub Washer Metal, 3 Tabs	2003-On
63C	38403	1	Forward Drum to Ring Gear Hub Washer Plastic, 3 Tabs	2003-On
63C	38403B	1	Forward Drum to Ring Gear Hub Washer Plastic, 3 Aligning Pins	2005-On
64C	37422H	1	Forward Ring Gear Hub to Planetary Bearing 2.515" I.D.	2003-04
64C	38422B	1	Forward Ring Gear Hub to Planetary Bearing 2.062" I.D.	2005-On
65C	38421	1	Forward Planetary Needle Bearing (2.106 O.D.) Rear	2003-On
66C	38404	1	Forward Planet/Lube Dam Washer 6 Tabs - 3.980" O.D.	2003-04
66C	38404B	1	Forward Planet/Lube Dam Washer 6 Tabs - 4.375" O.D.	2005-On
67C	K38405	1	Input Shell Washer/Sleeve Kit (Pressed-On the Sun Gear)	2003-On

5R110W

5R110W (Torqshift) - Cont'd.

ILL. NO.	PART NUMBER	PER CAR	DESCRIPTION	YEARS
THRUST WASHERS - Cont'd.				
67C	K38405	1	Input Shell Washer/Sleeve Kit (Pressed-On the Sun Gear)	2003-On
68C	38406	1	Reverse Planetary Washer (Front) 4 Plastic "D" Pins	2003-08
68C	38406	1	Reverse Planetary Washer (Rear) 4 Plastic "D" Pins	2003-08
69C	38421	1	Reverse Planetary to Ring Gear Hub Bearing (2.106 O.D.).....	2003-On
70C	38423	1	Output Shaft to Case Needle Bearing	2003-On
71D	38407	1	Case to Parking Gear Washer 1-Tab	2003-On
SEALING RINGS				
---	K38901	1	Sealing Ring Kit.....	2003-On
75A	37200T	1	Front Pump Support..... Teflon	2003-On
76A	37201T	2	Coast Clutch..... Teflon	2003-On
77B	38202	2	Direct Clutch..... Plastic	2003-On
78C	38203	2	Forward Clutch..... Plastic	2003-On
79D	38204	2	Rear Case/Output..... Plastic	2003-On
TRANSMISSION OIL FILTERS				
85E	38600	1	Oil Filter	2003-07
85E	38600E	1	Oil Filter (Larger)	2008-On
86E	ATK-241	1	Oil Filter Kit	2003-07
86E	ATK-263	1	Oil Filter Kit	2008-On
7E	38615	1	Valve Body Silicone Gasket with Screens (See Page 2.32-2)	2003-On
---	38609	1	Cooler Line Filter (Screw-On, OEM Type)	2003-07
---	38609A	1	Cooler Line Filter (Screw-On, SPX Type).....	2003-07
---	38609E	1	Cooler Line Filter (Metal Canister In-Line)	2008-10
Note: Flush cooler ahead of the cooler line filter or damage to the cooler filter will occur.				
SPRAGS AND ROLLER CLUTCHES				
90B	38815	1	Coast Mechanical Diode	2003-04
90B	38815B	1	Coast Mechanical Diode (32 Teeth / 57 Teeth)	2005-On
90B	38815D	1	Coast Mechanical Diode (32 Teeth / 59 Teeth)	2007-On
91C	38813	1	Low/Reverse Mechanical Diode.....	2003-04
91C	38813B	1	Low/Reverse Mechanical Diode.....	2005-On
MOLDED RUBBER PISTONS				
---	K38900-4	1	Molded Rubber Piston Kit	2003-On
95A	38844	1	Overdrive Clutch Piston Molded Rubber	2003-On
96A	38846	1	Coast Clutch Piston Molded Rubber	2003-On
97B	38842	1	Intermediate Clutch Piston Molded Rubber	2003-On
98B	K38843	1	Direct & Direct Balance Clutch Piston Kit Molded Rubber	2003-On
99C	K38841	1	Forward & FWD.Balance Clutch Piston Kit Molded Rubber	2003-On
100D	38840	1	Low/Reverse Clutch Piston Molded Rubber	2003-On
SHIFT ENHANCEMENT KITS AND MISCELLANEOUS				
---	K38944	1	Shift Kit (TransGo) Upgraded Includes NEW P.R Valve to Save Pumps .	2003-On
Addresses: High Line Pressure, Hard Parts Failure and Case Lug Blowout, Runaway Reverse or No Reverse and Neutral at a Stop.				
---	K38948	1	Vent Repair Kit (TransGo)	2003-On
Addresses: Accidental Venting of Fluid. Creates a New Vent Circuit.				

5R110W (Torqshift) - Cont'd.

ILL. NO.	PART NUMBER	PER CAR	DESCRIPTION	YEARS
SHIFT ENHANCEMENTS - Cont'd.				
---	K38887	1	TCC Control Sleeve Assembly (Sonnax) Addresses: TCC Cycling or Slipping, Code 741 or 1783 and High Operating Temps.	2003-On
---	K38989	1	Oversized Pressure Regulator Valve Kit (Sonnax, Use w/K38589 Tool Kit) Addresses: High or Low Line Pressure, Delayed Engagements and Converter Slip.	2003-On
---	K38880	1	Pressure Switch Plug Kit (TransGo, Includes Five Plugs/O'Rings) Addresses: Broken Dummy Plugs or Pressure Switches. Prevents Friction Failure.	2003-On
---	K38884B	1	Converter Pressure Limit Valve Kit (Sonnax) Addresses: TCC Cycling or Slipping, Code 741 or 1783 and High Operating Temps.	2003-On
ELECTRONIC COMPONENTS				
107D	38875A	1	Turbine/Intermediate Speed Sensor	2003-On
108D	38876	1	Output Shaft Speed Sensor 3-Pin Connector, 325-485 Ohms	2003-On
109E	38879	1	EPC Solenoid Inversely Proportional w/Small Hole on Snout	2003-On
110E	38871	1	Direct Clutch Solenoid..... Inversely Proportional w/Large Hole on Snout ..	2003-On
110E	38871	1	Coast Clutch Solenoid..... Inversely Proportional w/Large Hole on Snout ..	2003-On
111E	38870	1	Low/Reverse Clutch Solenoid Directly Proportional	2003-On
111E	38870	1	Intermediate Clutch Solenoid Directly Proportional	2003-On
111E	38870	1	Overdrive Clutch Solenoid..... Directly Proportional	2003-On
111E	38870	1	T.C.C. Clutch Solenoid Directly Proportional	2003-On
112E	38877	1	Transmission Range Sensor Internally Mounted	2003-On
113E	38869 ³	1	Bulkhead Connector/Internal Wiring Harness . (Use 38869B and K38880)	2003
113E	38869B ³	1	Bulkhead Connector/Internal Wiring Harness (Units w/o 38878PS Switches)	2003-On
---	38878PS ³	5	Fluid Pressure Switch Non-Operational, Use K38880 ³ 2003 vehicles came equipped with "non-operational" Fluid Pressure Switches (38878PS). When purchasing a wiring harness for a 2003 unit, please order the 38869B and disregard the Fluid Pressure Switches, the unit functions properly without any issues.	2003
---	K38880	1	Fluid Pressure Switch Plug Kit (TransGo, Includes Five Plugs/O'Rings) Addresses: Broken Dummy Plugs or Pressure Switches. Prevents Friction Failure.	2003-On
---	38878T	1	Transmission Temperature Sensor.....	2003-On
---	GS-60	1	60-Inch Ground Strap (Battery Negative to Transmission).....	2003-On
HARD PARTS				
Note : When ordering Hard Parts, please add the appropriate suffix : (-R) Reman, (-U) Used, (-A) Aftermarket.				
114A	K38965	1	Pump Gear Set	2003-On
114A	K38965A	1	Pump Gear Set (Oversized)	2003-On
115A	K38895	1	Complete Pump Assembly	2003-04
115A	K38895B	1	Complete Pump Assembly	2005-08
115A	K38895C	1	Complete Pump Assembly (Upgraded)	2003-On
116A	38851	1	Input Shaft	2003-On
117A	38803	1	Coast Clutch Drum	2003-04
117A	38803B	1	Coast Clutch Drum	2005-07
117A	38803D	1	Coast Clutch Drum (w/41 Tooth Sun Gear)	2007-On
---	K38803B	1	Coast Clutch Drum, O/D Sun Gear and Diode Kit	2003-06
---	K38803D	1	Coast Clutch Drum, O/D Sun Gear and Diode Kit	2007-On
120B	38855	1	Overdrive Sun Gear (38 Teeth, w/Groove)	2003-04
120B	38855B	1	Overdrive Sun Gear (38 Teeth, w/o Groove)	2005-06
120B	38855D	1	Overdrive Sun Gear (41 Teeth)	2007-On
121B	38856	1	Coast Clutch Hub	2003-On

5R110W

5R110W (Torqshift) - Cont'd.

ILL. NO.	PART NUMBER	PER CAR	DESCRIPTION	YEARS
HARD PARTS - Cont'd.				
Note : When ordering Hard Parts, please add the appropriate suffix : (-R) Reman, (-U) Used, (-A) Aftermarket.				
122B	38834	1	Overdrive Planet (28 Teeth)	2003-12/06
122B	38834D	1	Overdrive Planet (29 Teeth)	1/07-On
123B	38854	1	Overdrive Ring Gear (94 Teeth)	2003-12/06
123B	38854D	1	Overdrive Ring Gear (99 Teeth)	1/07-On
124B	38807	1	O/D Center Shaft	2003-12/06
124B	38807D	1	O/D Center Shaft	1/07-On
127B	38809	1	Center Support	2003-On
129B	38802	1	Direct Drum (w/96 Tooth Intermediate Frictions)	2003-04
129B	38802B	1	Direct Drum (w/76 Tooth Intermediate Frictions)	2005-08
129B	38802F	1	Direct Drum	2009-On
131C	38801	1	Forward Drum (w/90 "V" Tooth Forward Frictions)	2003-04
131C	38801B	1	Forward Drum (w/76 "Square" Tooth Forward Frictions)	2005-On
133C	38858	1	Forward Ring Gear Hub (w/90 "V" Tooth Forward Frictions)	2003-04
133C	38858B	1	Forward Ring Gear Hub (w/76 "Square" Tooth Forward Frictions)	2005-12/06
133C	38858D	1	Forward Ring Gear Hub	1/07-On
134C	37859	1	Forward Ring Gear (w/90 "V" Tooth Forward Frictions)	2003-04
134C	38859B	1	Forward Ring Gear (w/76 "Square" Tooth Forward Frictions)	2005-On
135C	38833	1	Forward Planetary (18T, w/4-Tab Washer Style)	2003-04
135C	38833B	1	Forward Planetary (23T, w/6-Tab Washer Style - Gas)	2005-On
135C	38833E	1	Forward Planetary (23T, w/4-Tab Washer Style - Diesel)	2005-On
136C	38810	1	Input Drive Shell (w/42 Teeth)	2003-04
136C	38810B	1	Input Drive Shell (w/55 Teeth)	2005-07
136C	38810E	1	Input Drive Shell	2008-On
137C	38860	1	Forward Sun Gear (w/34 Teeth)	2003-On
138C	38831	1	Reverse Planetary	2003-04
138C	38831B	1	Reverse Planetary (2nd Design, Will Retrofit)	2005-07
138C	K38831E	1	Reverse Planetary, L/R Diode, 5-Friction and Steel Plate Assembly	2008-On
138C	K38831F	1	Reverse Planetary, L/R Diode, 6-Friction and Steel Plate Assembly	2008-On
Note: Prior Design Level Components can be Substituted for K38831E.				
139C	38864	1	Rear Ring Gear	2003-On
140C	38863	1	Rear Ring Gear Hub (w/Holes)	2003-04
140C	38863B	1	Rear Ring Gear Hub (w/o Holes, Will Retrofit)	2005-On
149E	K38884	1	Oil Pan (Aftermarket Deep Type)	2003-07
149E	K38884E	1	Oil Pan (Aftermarket Deep Type)	2008-On
150E	15-152	1	Reman Valve Body (New EPC, Tested Solenoids, No Pressure Switch Style)	2003-On
150E	N15-152	1	Reman Valve Body (New Solenoids, No Pressure Switch Style)	2003-On
TOOLS				
---	DRUMBUDDY		Drum Buddy Drum Spring Compressor Tool (Adapt-A-Case)	2003-On
---	T9008	1	Output Shaft (4WD) Nut/ Spanner Socket (Adapt-A-Case)	2003-On