

Ford 4F27E & FNR5

FWD 4/5 Speed

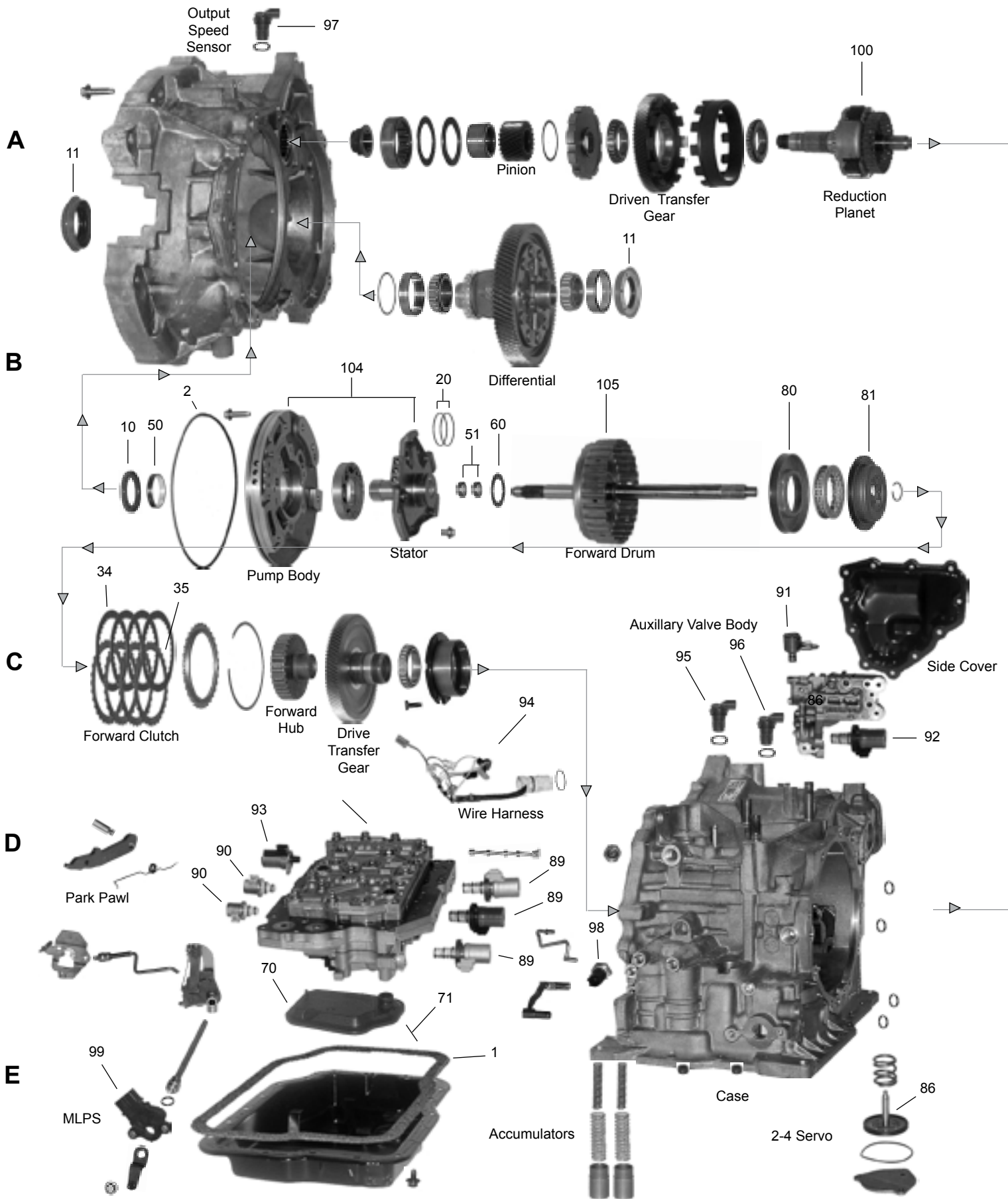

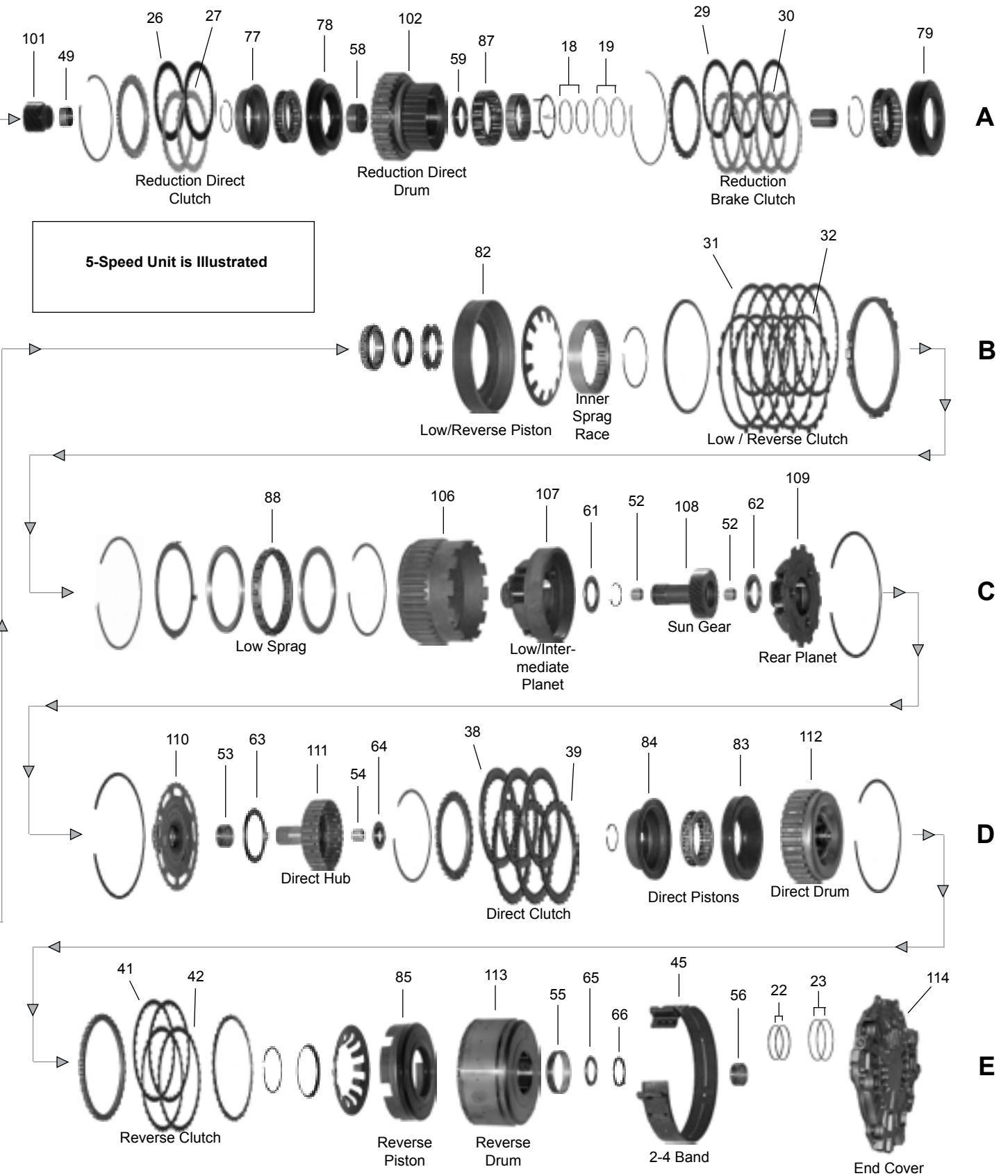

Ford 4F27E (FN4A-EL) & FNR5 (FS5A-EL) 4/5-Spd

VEHICLE		TRANSMISSION TYPE		YEARS
Mazda CX7		FS5A-EL (FNR5), 5-Speed		2009-On
Mazda MPV		FN4A-EL (4F27E), 4-Speed		2001-07
Mazda MPV		FS5A-EL (FNR5), 5-Speed		2008-On
Mazda Protege		FN4A-EL (4F27E), 4-Speed		1999-04
Mazda 2		FN4A-EL (4F27E), 4-Speed		2007-On
Mazda 3		FN4A-EL (4F27E), 4-Speed		2004-On
Mazda 3		FS5A-EL (FNR5), 5-Speed		2006-On
Mazda 5		FN4A-EL (4F27E), 4-Speed		2007
Mazda 5		FS5A-EL (FNR5), 5-Speed		2006-On
Mazda 6		FN4A-EL (4F27E), 4-Speed		2003-05
Mazda 6		FS5A-EL (FNR5), 5-Speed		2006-On
Ford Focus		4F27E, 4-Speed		2000-On
Ford Fusion		FNR5, 5-Speed		2006-09
Ford Transit Connect		4F27E, 4-Speed		2010-On
Mercury Milan		FNR5, 5-Speed		2006-09
TECHNICAL MANUALS				
TM4F27E	Technical Manual.....			1999-On
TM4F27ES	Technical Manual (Spanish)			1999-On
TMFNR5	Technical Manual.....			2006-On
ILL. NO.	PART NUMBER	PER CAR	DESCRIPTION	YEARS
MASTER BOX KITS				
---	K1700-S ¹		Master Kit (w/o Steels)..... 4F27E (Ford)	2000-On
---	K1700A-S ^{1,2}		Master Kit (w/o Steels)..... FN4A-EL (Mazda)	1999-02
---	K1700D-S ^{1,2}		Master Kit (w/o Steels)..... FN4A-EL (Mazda)	2003-07
---	K1700F-S ^{1,2}		Master Kit (w/o Steels)..... FNR5 & FS5A-EL	2006-On
Steel Plate Kits:				
---	K1700-9		Steel Plate Kit..... 4F27E & FN4A-EL	1999-On
---	K1700F-9		Steel Plate Kit..... FNR5 & FS5A-EL	2006-On
¹ Kits do not include the molded rubber clutch or servo pistons, for 4F27E units, please order K17900-4 and 17828 for a Mazda or K17900A-4 and 17828 for a Ford. For FNR5 (FS5A-EL) units please order K17900F-4 and 17828 separately.				
² Mazda FN4A-EL units utilize a bonded valve body gasket (17107), the gasket set includes replacement gaskets for this location, if you prefer the bonded gasket order it separately.				
OVERHAUL KITS AND GASKET SETS				
---	K17900 ^{1,2}	1	Overhaul Kit..... 4F27E (Ford)	1999-On
---	K17900A ^{1,2}	1	Overhaul Kit..... FN4A-EL (Mazda)	1999-07
---	K17900F ¹	1	Overhaul Kit..... FNR5 & FS5A-EL	2006-On
---	K17900-1 ^{1,2}	1	Gasket and Rubber Kit..... 4F27E & FN4A-EL	1999-On
---	K17900F-1 ¹	1	Gasket and Rubber Kit..... FNR5 & FS5A-EL	2006-On
GASKET AND RUBBER COMPONENTS				
1E	17170	1	Pan Gasket..... All	1999-On
---	17175F	1	Side Cover Gasket..... FNR5 & FS5A-EL	2006-On
2B	72100	1	Pump to Case O'Ring..... FN4A-EL (Mazda) & All FNR5	1999-On
2B	17100A	1	Pump to Case Lathe Cut Seal..... 4F27E (Ford)	2000-On
---	17107	1	Bonded Valve Body Gasket..... FN4A-EL (Mazda)	1999-07
---	17102	2	Valve Body Gasket..... 4F27E (Ford)	2000-On
---	17103	1	Solenoid Body Gasket (Lower)..... Screened, 4F27E & FN4A-EL	1999-On
---	17104	1	Solenoid Body Gasket (Upper)..... 4F27E & FN4A-EL	1999-On
---	17120	1	Filter Seal..... All	1999-On

Ford 4F27E (FN4A-EL) & FNR5 (FS5A-EL) 4/5-Spd

ILL. NO.	PART NUMBER	PER CAR	DESCRIPTION	YEARS
METAL CLAD SEALS				
10B	17526	1	Converter Hub.....All	1999-On
11A	70551	2	Axle.....FN4A-EL (Mazda)	1999-07
11A	17551A	2	Axle.....4F27E (Ford)	2000-On
11A	70551	2	Axle.....FNR5 & FS5A-EL	2006-On
SEALING RINGS				
---	K17901	1	Sealing Ring Kit.....4F27E & FN4A-EL	1999-On
---	K17901F	1	Sealing Ring Kit.....FNR5 & FS5A-EL	2006-On
18A	17203F	2	Reduction Direct.....FNR5 & FS5A-EL	2006-On
19A	17204F	2	Reduction Brake.....FNR5 & FS5A-EL	2006-On
20B	17200	2	Forward.....All	1999-On
22E	17201	2	Direct.....4F27E & FN4A-EL	1999-On
22E	17201F	2	Direct.....FNR5 & FS5A-EL	2006-On
23E	17202	2	Reverse.....4F27E & FN4A-EL	1999-On
23E	17202F	2	Reverse.....FNR5 & FS5A-EL	2006-On
CLUTCH PLATES				
26A	17304F	2-3	Reduction Direct (5th) Friction.....32T, .071" - 4.527" O.D.	2006-On
27A	17305	2-3	Reduction Direct (5th) Steel.....32T, .063" - 3.715" I.D.	2006-On
29A	17308F	3-4	Reduction Brake Friction.....32T, .070" - 4.520" O.D.	2006-On
30A	17309F	3-4	Reduction Brake Steel.....30T, .063" - 3.861" I.D.	2006-On
31B	17321	5	Low & Reverse Friction.....42T, .063" - 6.079" O.D.	1999-On
32B	17322	5	Low & Reverse Steel.....12T, .063" - 5.621" I.D.	1999-On
34C	17304	4	Forward Friction.....32T, .063" - 4.527" O.D.	1999-On
35C	17305	4	Forward Steel.....32T, .063" - 3.715" I.D.	1999-On
38D	17304	3	Direct Friction.....32T, .063" - 4.527" O.D.	1999-On
38D	17302D	3	Direct Friction.....32 Internal Teeth, .099" - 4.527" O.D.	2003-On
38D	17303D	3	Direct Friction.....32 External Teeth, .099" - 4.527" O.D.	2003-On
39D	17303	3	Direct Steel.....32T, .136" - 3.715" I.D.	1999-On
41E	17306	2	Reverse Friction.....32T, .063" - 5.515" O.D.	1999-On
42E	17307	2	Reverse Steel.....36T, .063" - 5.022" I.D.	1999-On
BANDS				
45E	17714	1	2-4 Band.....All	1999-On
BUSHINGS				
---	K17980	1	Bushing Assortment Kit (* Not Included)4F27E & FN4A-EL	1999-On
---	K17980Y	1	Bushing Assortment Kit (Omega)4F27E & FN4A-EL	1999-On
---	K17980F	1	Bushing Assortment Kit (* Not Included)FNR5 & FS5A-EL	2006-On
---	K17980FY	1	Bushing Assortment Kit (Omega)FNR5 & FS5A-EL	2006-On
49A	17010F	1	Reduction Sun Gear.....FNR5 & FS5A-EL	2006-On
50B	17005	1	Pump Bushing.....All	1999-On
51B	17002	2	Stator (Rear).....All	1999-On
51B	17002Y*	1	Stator (Rear).....One-Piece	1999-On
51B	K17002W*	1	Stator Kit (Rear).....Sonnax, Tightly Toleranced (2-Pieces)	1999-On
52C	17003	2	Forward Sun Gear.....All	1999-On
53D	17004	1	Rear Sun Gear.....4F27E & FN4A-EL	1999-On
53D	17004F	1	Rear Sun Gear.....FNR5 & FS5A-EL	2006-On
54D	17006	1	Direct Clutch Hub.....All	1999-On
55E	17007	1	Reverse Drum.....All	1999-On
56E	17009	1	Rear Cover.....All	1999-On

Ford 4F27E (FN4A-EL) & FNR5 (FS5A-EL)-Cont'd.

ILL. NO.	PART NUMBER	PER CAR	DESCRIPTION	YEARS
THRUST WASHERS AND BEARINGS				
---	K17940	1	Thrust Washer Kit (w/Selective Races) 4F27E & FN4A-EL	1999-On
---	K17940F	1	Thrust Washer Kit (w/Selective Races) FNR5 & FS5A-EL	2006-On
---	K17941	1	Thrust Bearing Kit..... 4F27E & FN4A-EL	1999-On
---	K17941F	1	Thrust Bearing Kit..... FNR5 & FS5A-EL	2006-On
58A	17430F	1	Reduction Direct (5th) Drum (Caged) FNR5 & FS5A-EL	2006-On
59A	17420F	1	Reduction Direct (5th) Drum to Case Brg..... FNR5 & FS5A-EL	2006-On
60B	17400	1	Pump Support to Forward Drum Thrust Washer	1999-On
61C	17423	1	Low/Intermediate Planetary to Sun Gear Needle Bearing	1999-On
62C	17424	1	Forward Sun Gear to Rear Planetary Needle Bearing	1999-On
63D	17421	1	Rear Sun Gear to Direct Clutch Hub Needle Bearing	1999-On
63D	17421F	1	Rear Sun Gear to Direct Clutch Hub Needle Bearing (4-Tabs, FNR5 & FS5A-EL)	2006-On
64D	17422	1	Direct Clutch Hub to Direct Drum Needle Bearing	1999-On
65E	17425	1	End Cover Needle Bearing (.100" Thick) 4F27E & FN4A-EL	1999-On
65E	17425F	1	End Cover Needle Bearing (.088" Thick) FNR5 & FS5A-EL	1999-On
66E	17410	AR	End Cover Race - Selective (1.5 mm) 4F27E & FN4A-EL	1999-On
66E	17410A	AR	End Cover Race - Selective (1.8 mm) 4F27E & FN4A-EL	1999-On
66E	17410C	AR	End Cover Race - Selective (2.0 mm) 4F27E & FN4A-EL	1999-On
66E	17410E	AR	End Cover Race - Selective (2.2 mm) 4F27E & FN4A-EL	1999-On
66E	17410G	AR	End Cover Race - Selective (2.4 mm) 4F27E & FN4A-EL	1999-On
66E	17410H	AR	End Cover Race - Selective (2.6 mm) 4F27E & FN4A-EL	1999-On
66E	17410F	AR	End Cover Race - Selective (1.5 mm) FNR5 & FS5A-EL	2006-On
66E	17410FA	AR	End Cover Race - Selective (1.8 mm) FNR5 & FS5A-EL	2006-On
66E	17410FC	AR	End Cover Race - Selective (2.0 mm) FNR5 & FS5A-EL	2006-On
66E	17410FE	AR	End Cover Race - Selective (2.2 mm) FNR5 & FS5A-EL	2006-On
66E	17410FG	AR	End Cover Race - Selective (2.4 mm) FNR5 & FS5A-EL	2006-On
66E	17410FH	AR	End Cover Race - Selective (2.6 mm) FNR5 & FS5A-EL	2006-On
OIL FILTERS				
70E	17600 ³	1	Oil Filter (.600" Inlet) 4F27E & FN4A-EL	1999-On
70E	17600F ³	1	Oil Filter (1.300" Inlet) FNR5 & FS5A-EL	2006-On
71E	ATK-215	1	Oil Filter Kit..... 4F27E & FN4A-EL	1999-On
71E	ATK-268	1	Oil Filter Kit..... FNR5 & FS5A-EL	2006-On
³ Please See Filter Pictures on Page 7.2-6 for Visual Identification.				
MOLDED RUBBER PISTONS				
---	K17900-4	1	Molded Rubber Piston Kit FN4A-EL (Mazda)	1999-On
---	K17900A-4	1	Molded Rubber Piston Kit 4F27E (Ford)	2000-On
---	K17900F-4	1	Molded Rubber Piston Kit FNR5 & FS5A-EL	2006-On
77A	17847F	1	Reduction Direct (5th) Clutch Balance Piston . FNR5/ FS5A-EL	2006-On
78A	17846F	1	Reduction Direct (5th) Clutch Piston FNR5/FS5A-EL	2006-On
79A	17848F	1	Reduction Direct Brake Clutch Piston FNR5/FS5A-EL	2006-On
80B	17841	1	Forward Clutch Piston..... All	1999-On
81B	17842	1	Forward Clutch Balance Piston..... All	1999-On
82B	17845	1	Low/Reverse Clutch Piston All	1999-On
83D	17843	1	Direct Clutch Piston..... All	1999-On
84D	17844	1	Direct Clutch Balance Piston..... All	1999-On
85E	17840	1	Reverse Clutch Piston (1.375" Tall) All	1999-On
85E	17840A	1	Reverse Clutch Piston (1.475" Tall) All	2000-On
86E	17828	1	Servo Piston (Not Included in Piston Kits) All	1999-On
SPRAGS AND ROLLER CLUTCH				
87A	17815F	1	Reduction Roller Clutch..... FNR5 & FS5A-EL	2006-On
88C	17813	1	Low Sprag Assembly..... All	1999-On

Ford 4F27E (FN4A-EL) & FNR5 (FS5A-EL)-Cont'd.

ILL. NO.	PART NUMBER	PER CAR	DESCRIPTION	YEARS
SHIFT ENHANCEMENTS & MISCELLANEOUS				
---	K17944	1	Shift Kit (TransGo) 4F27E, FN4A-EL & FNR5 (FS5A-EL) 1999-On Addresses: Wrong Gear Starts, No or Slips/Skips in 2nd Gear, KD Neutrals, TCC Codes.	
---	ST17944	1	Shift Correction Package (Superior) 4F27E, FN4A-EL & FNR5 (FS5A-EL) 1999-On Addresses: Converter Clutch Slip, Low Pressure and Burned Friction.	
---	K17944FRT	1	Valve Body Kit (RatioTek) FNR5 & FS5A-EL 2006-On Addresses: Converter Clutch Failure and Boosts Operating Pressures to Firm Shifts As Well As Increasing Torque Capacity By 15 Percent.	
---	K17989	1	Oversized Pressure Regulator Valve Kit (Fits All, Use w/K17589 Tool Kit) 1999-On	
---	17054	1	2-4 Servo Bore Bushing/Sleeve (Use w/K17911 Tool, Fits All) 1999-On	
ELECTRONIC COMPONENTS				
89D	17870	1-3	Shift (C, D, E) Solenoid (PWM - Large) All 1999-On	
90D	17871	1-2	Shift (A, B) Solenoid (On/Off - Small) All 1999-On	
91C	17871FA	1	Shift Solenoid (On/Off) On Auxillary Valve Body, FNR5 & FS5A-EL 2006-On	
92C	17870	1	PCS (PCB) Solenoid On Auxillary Valve Body, FNR5 & FS5A-EL 2006-On	
93D	17879	1	EPC Solenoid 4F27E & FN4A-EL 1999-On	
93D	17879	1	EPC (PCA) Solenoid FNR5 & FS5A-EL 2006-On	
---	53878T	1	Temperature Sensor All 1999-On	
94C	17869	1	Internal Wiring Harness 4F27E & FN4A-EL 1999-On	
94C	17869	1	Internal Wiring Harness (Main) FNR5 & FS5A-EL 2006-On	
---	17869FA	1	Internal Wiring Harness (Auxillary Valve Body - 10" Long, FNR5 & FS5A-EL) 2006-On	
95C	17875	1	Turbine Speed Sensor 4F27E & FN4A-EL 1999-On	
95C	17875F	1	Turbine Speed Sensor FNR5 & FS5A-EL 2006-On	
96C	17875FA	1	Intermediate Shaft Speed Sensor FNR5 & FS5A-EL 2006-On	
97A	17876	1	Output Speed Sensor 4F27E & FN4A-EL 1999-On	
97A	17876F	1	Output Speed Sensor FNR5 & FS5A-EL 2006-On	
98D	17878F	1	Forward Clutch Pressure Switch (1 Prong) .. FNR5 & FS5A-EL 2006-On	
99E	17877	1	Transmission Range Sensor 4F27E Only 1999-On	
99E	17877F	1	Transmission Range Sensor FNR5 Only 2006-On	
HARD PARTS				
100A	17834F	1	Reduction Planetary FNR5 & FS5A-EL 2006-On	
101A	17855F	1	Reduction Sun Gear FNR5 & FS5A-EL 2006-On	
102A	17800F	1	Reduction/Direct Drum FNR5 & FS5A-EL 2006-On	
104B	K17895	1	Pump Assembly 4F27E & FN4A-EL 1999-On	
104B	K17895F	1	Pump Assembly FNR5 & FS5A-EL 2006-On	
105B	17801	1	Forward Drum All 1999-On	
106C	17859	1	Low/Intermediate Ring Gear All 1999-On	
107C	17833	1	Low/Intermediate Planetary All 1999-01	
107C	17833C	1	Low/Intermediate Planetary All 2002-On	
108C	17860	1	Forward Sun Gear All 1999-On	
109C	17831	1	Rear Planetary All 1999-01	
109C	17831C	1	Rear Planetary All 2002-On	
110D	17865	1	Rear Sun Gear 4F27E & FN4A-EL 1999-On	
110D	17865F	1	Rear Sun Gear FNR5 & FS5A-EL 2006-On	
111D	17863	1	Direct Hub 4F27E & FN4A-EL 1999-On	
111D	17863F	1	Direct Hub FNR5 & FS5A-EL 2006-On	
112D	17803	1	Direct Drum All 1999-On	
113E	17806	1	Reverse Drum 4F27E & FN4A-EL 1999-On	
113E	17806F	1	Reverse Drum FNR5 & FS5A-EL 2006-On	
114E	17825	1	Rear Cover 4F27E 2000-On	
114E	17825A	1	Rear Cover FN4A-EL 1999-On	
114E	17825F	1	Rear Cover FNR5 & FS5A-EL 2006-On	
150D	30-108	1	Reman Valve Body Ford 4F27E w/6-Solenoids 1999-On	
150D	30-108A	1	Reman Valve Body Mazda FN4A-EL w/6-Solenoids 1999-On	
150D	30-108B	1	Reman Valve Body FNR5 & FS5A-EL (Main Valve Body) 2006-On	

Mazda 4F27E / FNR5