

45RFE / 5-45RFE

RWD 4 & 5 Speed

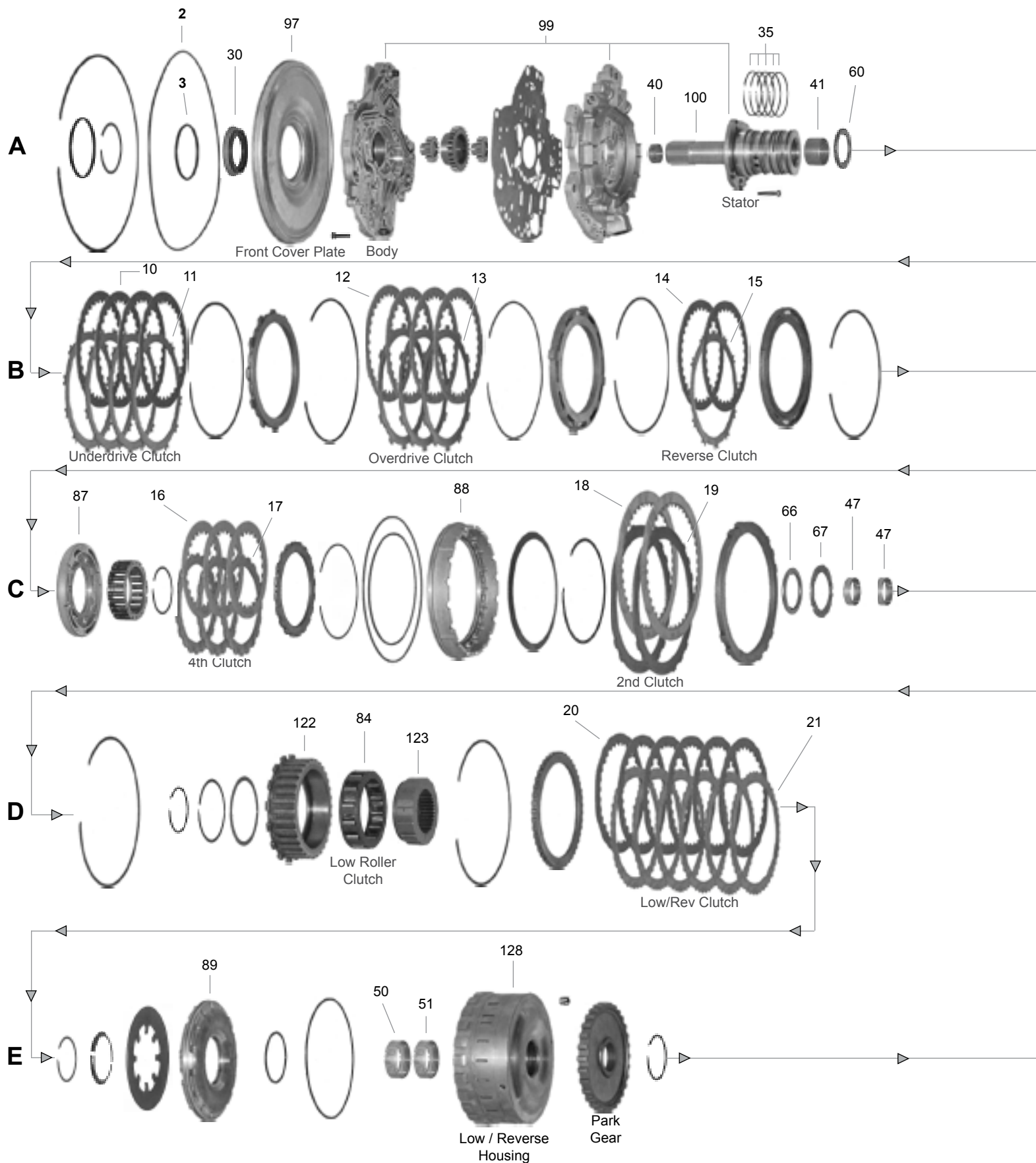

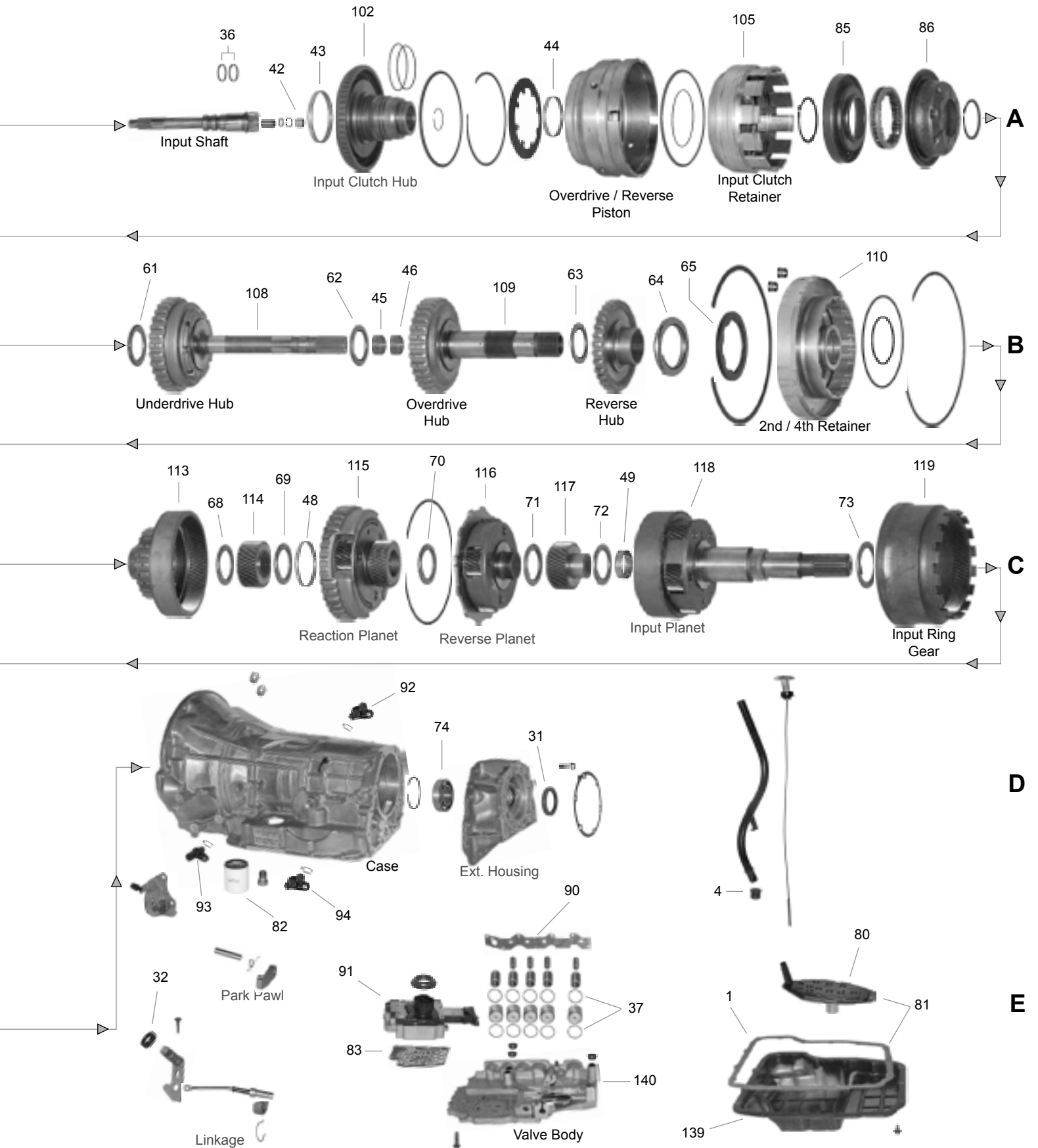

CHRYSLER 45RFE, 5-45RFE & 68RFE

ILL. NO.	PART NUMBER	PER CAR	DESCRIPTION	YEARS
	TM45RFE		Technical Manual 45/5-45RFE (4 & 5-Speed)	1999-On
	TM68RFE		Technical Manual 68RFE (6-Speed)	2007-On
REBUILDER BOX KITS				
---	K2900-S ^{1,2}		Master Kit (w/o Steels) 45/5-45RFE (4 & 5-Speed)	1999-05
---	K2900G-S ¹		Master Kit (w/o Steels) 45/5-45RFE (4 & 5-Speed)	2006-On
---	K2900L-S ¹		Master Kit (w/o Steels) 68RFE (6-Speed)	2007-On
Steel Plate Sub-Kits:				
---	K2900-9		Steel Plate Kit 45/5-45RFE (4 & 5-Speed)	1999-On
---	K2900L-9		Steel Plate Kit 68RFE (6-Speed)	2007-On
¹ Kits do not included the molded rubber pistons, for 45/5-45RFE please order K29900-4 for 1999-05 and K29900G-4 for 2006-On or for 68RFE K29900L-4 separately as required. ² Some 04'-05' Units may require the late solenoid screen, please order 29615D separately.				
OVERHAUL KITS, GASKET SETS AND SEAL KITS				
---	K29900 ^{1,2}		Overhaul Kit 45/5-45RFE (4 & 5-Speed)	1999-05
---	K29900G		Overhaul Kit 45/5-45RFE (4 & 5-Speed)	2006-On
---	K29900L		Overhaul Kit 68RFE (6-Speed)	2007-On
---	K29900-1 ^{1,2}		Gasket and Rubber Kit 45/5-45RFE (4 & 5-Speed)	1999-05
---	K29900G-1		Gasket and Rubber Kit 45/5-45RFE & 68RFE	2006-On
GASKET AND RUBBER COMPONENTS				
1E	29170	1	Pan Gasket (Replaces Silicone) Duraprene	1999-On
2A	29100	1	Pump O'Ring (Large - Outer)	1999-On
3A	29100A	1	Pump "H-Seal" (Small - Inner)	1999-On
---	29120	1	Oil Filter Seal	1999-On
4D	29141	1	Oil Filler Tube Seal 45/5-45RFE (4 & 5-Speed)	1999-On
4D	29141L	1	Oil Filler Tube Seal 68RFE (6-Speed)	2007-On
---	29125	1	Solenoid Body to Case Seal	1999-On
CLUTCH PLATES				
10B	29304	4	Underdrive Clutch Friction (Exc. 68RFE) ... 32T, .078" - 6.378" O.D.	1999-On
11B	29305	4	Underdrive Clutch Steel (Exc. 68RFE) 12T, .068" - 6.466" I.D.	1999-On
10B	29304L	5	Underdrive Single-Sided Clutch (68RFE) . 32 Internal Teeth - .057"	2007-On
11B	29305L	5	Underdrive Single-Sided Clutch (68RFE) . 12 External Teeth - .057"	2007-On
12B	29308	4	Overdrive/3rd Clutch Friction (Exc. 68RFE) 32T, .089" - 6.378" O.D.	1999-On
13B	29309	3	Overdrive/3rd Clutch Steel (Exc. 68RFE) ... 12T, .085" - 5.400" I.D.	1999-On
12B	29308L	6	Overdrive/3rd Single-Sided Clutch (68RFE) 32 Internal Teeth - .052"	2007-On
13B	29309L	6	Overdrive/3rd Single-Sided Clutch (68RFE) 12 External Teeth - .052"	2007-On
14B	29304	2	Reverse Clutch Friction 32T, .078" - 6.378" O.D.	1999-On
15B	29305	1	Reverse Clutch Steel 12T, .068" - 6.466" I.D.	1999-On
16C	29310	3	4th Clutch Friction 24T, .091" - 5.335" O.D.	1999-On
17C	29311	3	4th Clutch Steel 20T, .098" - 4.235" I.D.	1999-On
18C	29302	2-3	2nd Clutch Friction 40T, .091" - 8.110" O.D.	1999-On
19C	29303	2-3	2nd Clutch Steel 10T, .130" - 6.772" I.D.	1999-On
20D	29321	6	Low/Reverse Clutch Friction (Exc. 68RFE) 32T, .078" - 6.846" O.D.	1999-On
21D	29322	6	Low/Reverse Clutch Steel (Exc. 68RFE) ... 45T, .068" - 5.689" I.D.	1999-On
20D	29321L	7	Low/Reverse Single-Sided Clutch (68RFE) 48 Internal Teeth - .062"	2007-On
21D	29322L	7	Low/Reverse Single-Sided Clutch (68RFE) 45 External Teeth - .062"	2007-On

CHRYSLER 45RFE, 5-45RFE & 68RFE

ILL. NO.	PART NUMBER	PER CAR	DESCRIPTION	YEARS
METAL CLAD SEALS				
30A	29526	1	Front Pump Seal (Flanged Type, Will Replace Non-Flanged Type)	1999-On
31D	37551B	1	Extension Housing (Except 68RFE) 2WD	1999-On
31D	62551E	1	Extension Housing (68RFE) 2WD	2007-On
---	29551A	1	Adapter Housing 4WD	1999-On
32E	29507	1	Manual Lever	1999-On
SEALING RINGS				
---	K29901	1	Sealing Ring Kit 45/5-45RFE	1999-On
---	K29901L	1	Sealing Ring Kit 68RFE	2007-On
35A	29200	5	Reaction Shaft Support Seal Plated	1999-On
36A	29201T	2	Input Shaft (Exc. 68RFE)	1999-On
36A	29201LT	2	Input Shaft (68RFE)	2007-On
37E	32202T	10	Accumulator Piston	1999-On
BUSHINGS				
---	K29980	1	Bushing Kit 45/5-45RFE	1999-On
---	K29980L	1	Bushing Kit 68RFE	2007-On
40A	29001	1	Stator Shaft (Front) 1.021" O.D.	1999-On
41A	29002	1	Stator Shaft (Rear) 1.514" O.D.	1999-On
42A	29003	1	Input Shaft (Babbitt, Exc. 68RFE)822" O.D.	1999-On
42A	29003L	1	Input Shaft (Bronze, 68RFE)822" O.D.	2007-On
43A	29004	1	Input Clutch Hub 2.901" O.D.	1999-On
44A	29006	1	Overdrive/Reverse Piston	1999-On
45B	29007	1	O/D Clutch Hub (Front) 1.100" O.D.	1999-On
46B	29008	1	O/D Clutch Hub (Rear) 1.061" O.D.	1999-On
47C	29011	2	Reaction Annulus/Ring Gear Hub 1.707" O.D.	1999-On
48C	29012	1	Reaction (Front) Planetary (Exc. 68RFE) 1.501" O.D.	1999-On
48C	29012L	1	Reaction (Front) Planetary (68RFE) 1.501" O.D.	2007-On
49C	29013	1	Input Planet/Output Shaft 1.537" O.D.	1999-On
50E	29014	1	Low/Reverse Housing (Front, Exc. 68RFE) 2.031" O.D., .512" Tall	1999-On
50/1E	29014L	2	Low/Reverse Housing (68RFE) 2.021" O.D., .550" Tall	2007-On
51E	29015	1	Low/Reverse Housing (Rear, Exc.68RFE) 2.031" O.D., .571" Tall	1999-On
74D	B6023	1	Extension Housing Bushing Some 2WD Models	1999-On
THRUST BEARINGS				
---	K29941	1	Thrust Bearing Kit (Exc. 68RFE; Includes (7) 29420, (2) 29421, (1) 29422 and (1) 29423) .	1999-On
---	K29941L	1	Thrust Bearing Kit (68RFE)	2007-On
<p>Note: This unit may substitute different bearings in certain locations. When ordering for a specific location please verify by size. The 29420 (2.360 O.D. and .150 Thick); 29421 (2.662" O.D. and .150" Thick); 29422 (3.810" O.D. and .130" Thick); 29423 (2.510" O.D. and .200 Thick)</p>				
60A	29420	1	Pump Stator to Input Clutch Hub	1999-On
61B	29420	1	Underdrive Clutch Hub (Front)	1999-On
62B	29420	1	Underdrive Hub to O/D Hub	1999-On
63B	29420	1	O/D Hub to Reverse Hub	1999-On
64B	29422	1	Reverse Hub (Rear)	1999-On
65B	K29405	1	Selective Thrust Plate Package (Reverse Hub Bearing to 2-4 Clutch Retainer)	1999-On
66C	29421	1	Reaction Annulus/Ring Gear Hub	1999-On

45 / 5-45RFE / 68RFE

CHRYSLER 45RFE, 5-45RFE & 68RFE - Cont'd.

ILL. NO.	PART NUMBER	PER CAR	DESCRIPTION	YEARS	
THRUST BEARINGS - Cont'd.					
67C	K29406	1	Selective Thrust Plate Package (Reaction Annulus/Ring Gear Hub)	1999-On	
68C	29420	1	Reaction Annulus to Reaction Sun Gear	1999-On	
69C	29420	1	Reaction (Front) Sun Gear to Reaction Planetary	1999-On	
70C	29420	1	Reaction Planetary to Reverse Planetary (Exc. 68RFE)	1999-On	
70C	29422L	1	Reaction Planetary to Reverse Planetary (68RFE)	2007-On	
71C	29423	1	Reverse Planetary to Input Sun Gear (Exc. 68RFE) . .200"	1999-On	
71C	29423A	1	Reverse Planetary to Input Sun Gear (Exc. 68RFE) . .150"	1999-On	
71C	29423L	1	Reverse Planetary to Input Sun Gear (68RFE)	2007-On	
72C	29420	1	Input Sun Gear to Input Planetary	1999-On	
73C	29421	1	Input Planetary/Output Shaft (Rear)	1999-On	
73C	29422L	1	Input Planetary/Output Shaft (Rear)	2007-On	
74D	12431	1	Extension Housing Roller Bearing (Some 2WD, Exc. 68RFE)	1999-On	
74D	29431L	1	Extension Housing Roller Bearing (68RFE)	2007-On	
TRANSMISSION OIL FILTERS					
80E	29600	1	Oil Filter	2WD	1999-On
80E	29601	1	Oil Filter	4WD	1999-On
81E	ATK-223	1	Oil Filter Kit	2WD	1999-On
81E	ATK-224	1	Oil Filter Kit	4WD	1999-On
82D	29609	1	Cooler Oil Filter (Internal/Spin-on)		1999-On
---	29611	1	Reverse and Overdrive Screen		1999-On
83E	29615	1	Solenoid Screen..... Fits Early Black Connector Solenoid Pack (Bolt-on)		1999-04
83E	29615D	1	Solenoid Screen..... Fits Late White Connector Solenoid Pack (Loose / Clip-On) .		2003-On
SPRAGS AND ROLLER CLUTCHES					
84D	29813	1	Low Roller Clutch (Exc. 68RFE)		1999-On
84D	K29813L	1	Low Sprag w/Races (68RFE)		2007-On
MOLDED RUBBER PISTONS					
---	K29900-4	1	Piston Kit	Molded Rubber	1999-05
---	K29900G-4	1	Piston Kit (* Included, Exc. 68RFE)	Molded Rubber	2006-On
---	K29900L-4	1	Piston Kit (68RFE)	Molded Rubber	2007-On
85A	29841*	1	Underdrive Piston	Molded Rubber	1999-On
86A	29847*	1	Underdrive Balance Piston	Molded Rubber	1999-On
87C	29844G*	1	4th Piston	Molded Rubber	2006-On
88C	29842G*	1	2nd Piston (Exc. 68RFE)	Molded Rubber	2006-On
88C	29842L	1	2nd Piston (68RFE)	Molded Rubber	2007-On
89E	29840G*	1	Low/Reverse Piston	Molded Rubber	2006-On
---	32782J	1-5	Accumulator Piston (Factory Discontinued)	Molded Rubber	2004
---	32782	1-5	Accumulator Piston (Exc. 68RFE)	Aluminum	1999-On
---	29782L	1-5	Accumulator Piston (68RFE)	Aluminum	2007-On
SHIFT ENHANCEMENTS					
---	K29944	1	Shift Kit (All Units)	TransGo	1999-On
Addresses: 2-3 Neutral, Limp and Slip Codes. Includes: Tough Snap Ring, Heavy Duty Accumulator Cover Plate and Special Accumulator Seals.					

CHRYSLER 45RFE, 5-45RFE & 68RFE - Cont'd.

ILL. NO.	PART NUMBER	PER CAR	DESCRIPTION	YEARS
SHIFT ENHANCEMENTS - Cont'd.				
---	45RFE-HD2	1	Reprogramming Kit (All Units) TransGo Addresses: Soft 1-2, Heavy Throttle Long 2-3 and Firms Up 4th.	1999-On
90E	29880	1	Accumulator Cover Plate Kit (Sonnax, Includes Plate & Screws, Use w/29580 Tap) ...	1999-On
---	32886VP	1	Solenoid Switch Valve Plugs Sonnax	1999-On
---	32886VPL	1	Solenoid Switch Valve Plugs (Oversized) Sonnax, Use w/32586L Reamer	1999-On
				Prevents cocking of plugs in the bore which causes erratic TCC operation and codes.
---	32885W	1	Solenoid Switch Valve (Oversized)..... Sonnax, Use w/32585 Reamer	1999-On
---	K29780W	1	TCC Accumulator Springs (Sonnax, Prevents Harsh TCC Engagement)	1999-On
---	K29767W	1	Torque Converter Limit Spring (Sonnax, Stalls Upon Engagement, Usually Broken) ...	1999-On
---	K29887	1	TCC Limit Valve and Sleeve Kit (Sonnax, use w/K29587 Tool Kit)	1999-On
ELECTRONIC COMPONENTS				
Note : When ordering a Solenoid Body, please add the (-R) suffix for a Remanufactured Unit, if Desired.				
91E	K29879	1	Solenoid and Pressure Switch Assembly w/TRS Plate (Replaces Black Connector) ..	1999-04
91E	29879D	1	Solenoid and Pressure Switch Assembly (White Connector and Loose Screen)	2003-On
---	29879X	1	EPC Solenoid (Part of K29879 & 29879D)	1999-On
---	K29900-2	1	Solenoid Screens and Gasket Set .. For Early Design Solenoid (Black)	1999-04
---	K29900D-2	1	Solenoid Screens and Gasket Set .. For Late Design Solenoid (White)	2003-On
---	K32900-2W	1-2	Solenoid Pack Repair Kit (Sonnax, Three Diaphragms and Contacts)	1999-On
92D	29878	1	Line Pressure Sensor - External (Covers 3 or 4-Prong Sensors)	1999-On
---	29655A	³ 1	Line Pressure Booster Except 68RFE	1999-On
---	29655L	³ 1	Line Pressure Booster 68RFE	2007-On
				³ Plugs into Wiring Harness Externally to Increase Line Pressure/Torque Capacity.
93D	29875	1	Input Speed Sensor	1999-On
94D	29875	1	Output Speed Sensor	1999-On
HARD PARTS				
Note : When ordering Hard Parts, please add the appropriate suffix : (-R) Reman, (-U) Used, (-A) Aftermarket.				
97A	29881	1	Pump Cover Plate (Aluminum Design)	1999-7/06
97A	29881G	1	Pump Cover Plate (Steel Design) Exc. 68RFE	7/06-On
97A	29881L	1	Pump Cover Plate (Steel Design) 68RFE	2007-On
99A	K29895	1	Pump Assembly (w/Shaft Hole)	1999-02
99A	K29895C	1	Pump Assembly (w/o Shaft Hole, Exc. 68RFE)	2003-6/06
99A	K29895G	1	Pump Assembly (Matches Steel Pump Cover, Exc. 68RFE)	7/06-On
99A	K29895L	1	Pump Assembly (68RFE)	2007-On
100A	29812	1	Pump Stator (Exc. 68RFE)	1999-On
100A	29812L	1	Pump Stator (68RFE)	2007-On
102A	29847	1	Input Clutch Hub (Exc. 68RFE)	1999-On
102A	29847L	1	Input Clutch Hub (68RFE)	2007-On
105A	29848	1	Input Clutch Retainer (Exc. 68RFE)	1999-On
105A	29848L	1	Input Clutch Retainer (68RFE)	2007-On
108B	29803	1	Underdrive Hub (Exc. 68RFE)	1999-On
108B	29803L	1	Underdrive Hub (68RFE)	2007-On
109B	29804	1	O/D Hub (Exc. 68RFE)	1999-On
109B	29804L	1	O/D Hub (68RFE)	2007-On
110B	29802	1	2-4 Clutch Retainer (Exc. 68RFE)	1999-On
110B	29802L	1	2-4 Clutch Retainer (68RFE)	2007-On
113C	29859	1	Front (Reaction) Ring Gear (Exc. 68RFE)	1999-On
113C	29859L	1	Front (Reaction) Ring Gear (68RFE)	2007-On

45 / 5-45RFE / 68RFE

CHRYSLER 45RFE, 5-45RFE & 68RFE - Cont'd.

ILL. NO.	PART NUMBER	PER CAR	DESCRIPTION	YEARS
HARD PARTS - Cont'd.				
Note : When ordering Hard Parts, please add the appropriate suffix : (-R) Reman, (-U) Used, (-A) Aftermarket.				
114C	29860	1	Front (Reaction) Sun Gear (Exc. 68RFE)	1999-On
114C	29860L	1	Front (Reaction) Sun Gear (68RFE)	2007-On
115C	29833	1	Front (Reaction) Planetary (Exc. 68RFE)	1999-On
115C	29833L	1	Front (Reaction) Planetary (68RFE)	2007-On
116C	29831	1	Reverse Planetary (Exc. 68RFE)	1999-On
116C	29831L	1	Reverse Planetary (68RFE)	2007-On
117C	29865	1	Input Sun Gear (Exc. 68RFE) 2.070" Long	1999-On
117C	29865A	1	Input Sun Gear (Exc. 68RFE) 2.015" Long	1999-On
117C	29865L	1	Input Sun Gear (68RFE)	2007-On
118C	29834	1	Input Planetary (Exc. 68RFE)	1999-On
118C	29834L	1	Input Planetary (68RFE)	2007-On
119C	29864	1	Input Ring Gear (Exc. 68RFE)	1999-On
119C	29864L	1	Input Ring Gear (68RFE)	2007-On
122D	29818	1	Low Roller Clutch Outer Race (Exc. 68RFE)	1999-On
122D	29818L	1	Low Sprag Clutch Outer Race (68RFE)	2007-On
123D	29811	1	Low Roller Inner Race (Exc. 68RFE)	1999-On
123D	29811L	1	Low Sprag Inner Race (68RFE)	2007-On
128E	29800	1	Low/Reverse Housing (Exc. 68RFE)	1999-On
128E	29800L	1	Low/Reverse Housing (68RFE)	2007-On
139E	K29884	1	Oil Pan (Aftermarket Deep Type) All	1999-On
140E	10-133	1	Valve Body (Reman) 45/5-45RFE	1999-03
140E	10-134	1	Valve Body (Reman) 5-45RFE	2004-On
140E	10-134A	1	Valve Body (Reman) 68RFE	2007-On

Notes: